

FLOORPLAN SKETCH

Borrower: _____ File No.: 2019038
 Property Address: 1 Seahurst Rd _____ Case No.: _____
 City: Rolling Hills Estates _____ State: CA _____ Zip: 90274
 Lender: _____

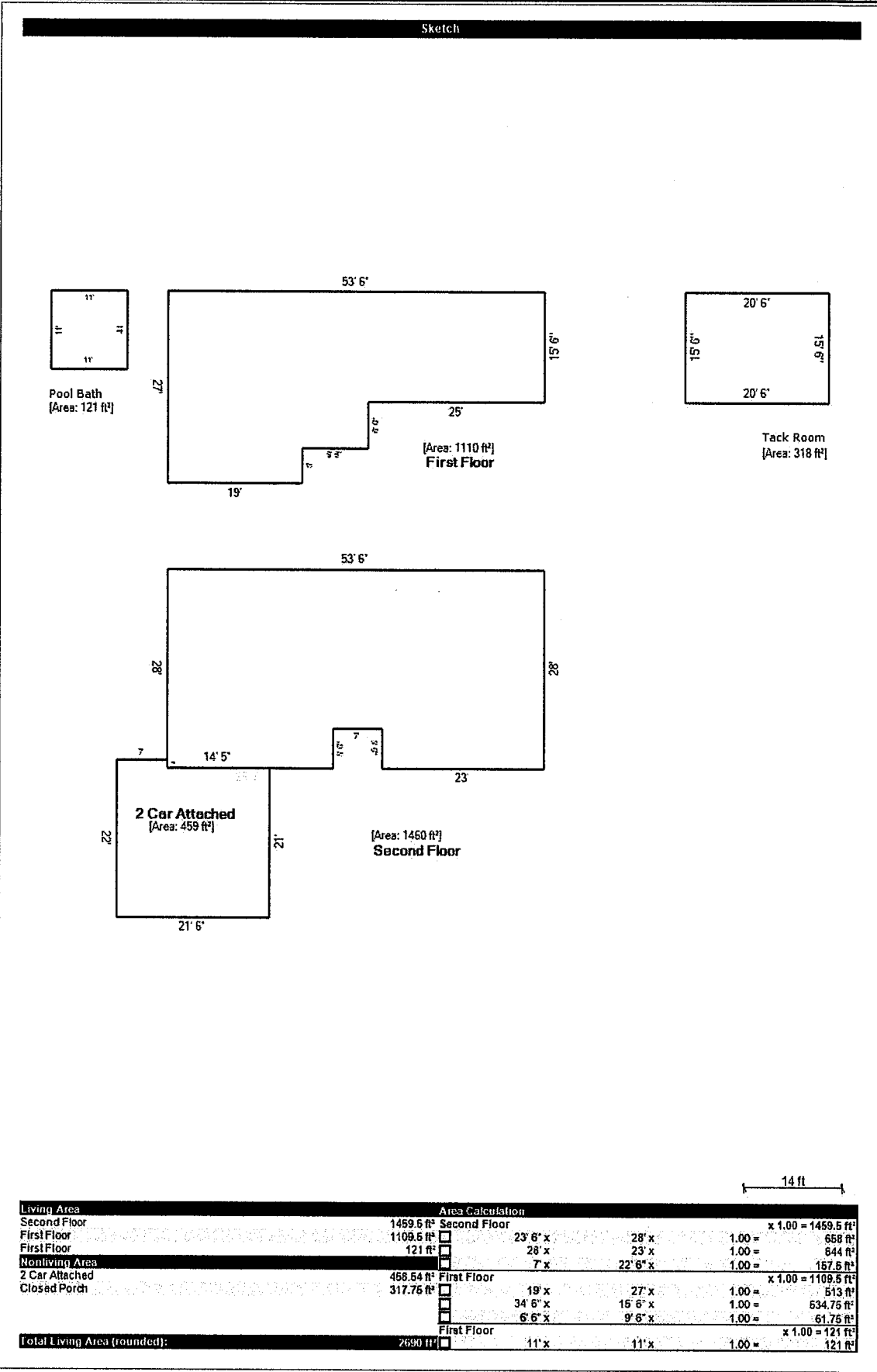

Living Area		Area Calculation			
Second Floor	1459.5 ft²	Second Floor			x 1.00 = 1459.5 ft²
First Floor	1109.5 ft²	23' 6" x	28' x	1.00 =	656 ft²
First Floor	121 ft²	28' x	23' x	1.00 =	644 ft²
Nonliving Area		7' x	22' 6" x	1.00 =	157.5 ft²
2 Car Attached	459.54 ft²	First Floor			x 1.00 = 1109.5 ft²
Closed Porch	317.76 ft²	19' x	27' x	1.00 =	513 ft²
		34' 6" x	15' 6" x	1.00 =	534.75 ft²
		6' 6" x	9' 8" x	1.00 =	61.75 ft²
Total Living Area (rounded):	2690 ft²	First Floor			x 1.00 = 121 ft²
		11' x	11' x	1.00 =	121 ft²