

# FLOORPLAN SKETCH

Borrower:	File No.: 307 Anderson St
Property Address: 307 Anderson St	Case No.: 307 Anderson St
City: Manhattan Beach	State: CA
Lender: South Bay Land Management and Development LLC	Zip: 90266

Sketch

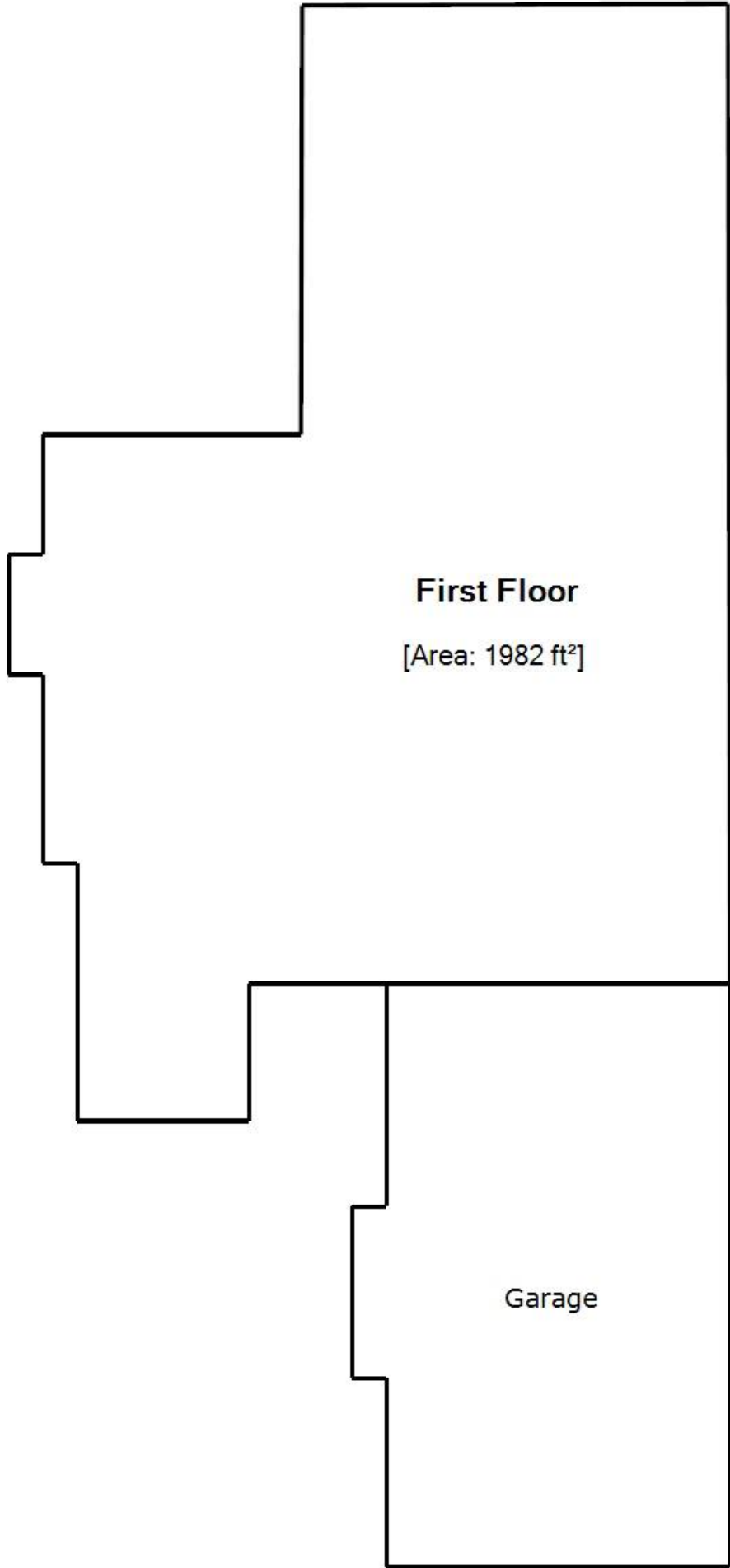

8 ft

Living Area	Area Calculation			
First Floor	1981.64 ft <sup>2</sup>	□	First Floor	x 1.00 = 1981.64 ft <sup>2</sup>
Nonliving Area	700.00 ft <sup>2</sup>	□	8ft x 10ft x 1.00 =	80 ft <sup>2</sup>
3 Car Built-In		△	24.8ft x 25ft x 0.50 =	309.99 ft <sup>2</sup>
		□	2ft x 7ft x 1.00 =	14 ft <sup>2</sup>
		□	2ft x 25ft x 1.00 =	50 ft <sup>2</sup>
		△	57.10ft x 35.33ft x 0.35 =	711.64 ft <sup>2</sup>
		△	25ft x 40.61ft x 0.39 =	400 ft <sup>2</sup>
<b>Total Living Area (rounded):</b>	<b>1982 ft<sup>2</sup></b>	□	13ft x 32ft x 1.00 =	416 ft <sup>2</sup>

# FLOORPLAN SKETCH

Borrower:	File No.: 307 Anderson St
Property Address: 307 Anderson St	Case No.: 307 Anderson St
City: Manhattan Beach	State: CA
Lender: South Bay Land Management and Development LLC	Zip: 90266

**Sketch**

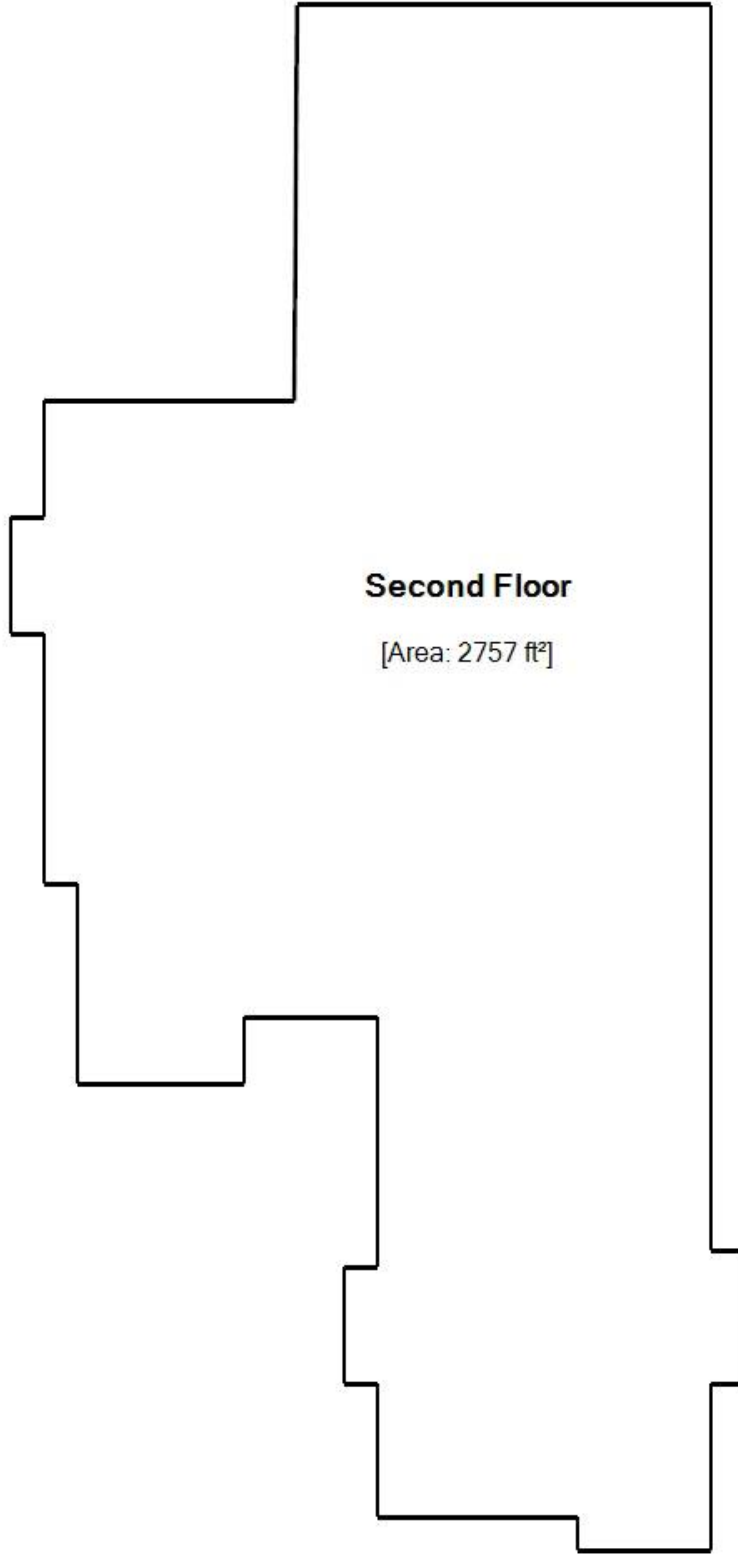

Living Area	Area Calculation			
Second Floor	2757.01 ft <sup>2</sup>	Second Floor	x 1.00 =	2757.01 ft <sup>2</sup>
		2ft x 8ft	1.00 =	16 ft <sup>2</sup>
		2ft x 8ft	1.00 =	16 ft <sup>2</sup>
		2ft x 7ft	1.00 =	14 ft <sup>2</sup>
		2ft x 7ft	1.00 =	14 ft <sup>2</sup>
		2ft x 29ft	1.00 =	58 ft <sup>2</sup>
		10ft x 41ft	1.00 =	410 ft <sup>2</sup>
		30ft x 20ft	1.00 =	600 ft <sup>2</sup>
		37ft x 28ft	1.00 =	1036 ft <sup>2</sup>
		23.8ft x 0.17ft	0.50 =	1.97 ft <sup>2</sup>
<b>Total Living Area (rounded):</b>	<b>2757 ft<sup>2</sup></b>	24.83ft x 23.80ft	1.00 =	591.04 ft <sup>2</sup>