



# Riverside County Parcel Report

APN(s):607040037

## DISCLAIMER

Maps, permit information and data are to be used for reference purposes only. Map features are approximate, and are not necessarily accurate to surveying or engineering standards. The County of Riverside makes no warranty or guarantee as to the content (the source is often third party), accuracy, timeliness, or completeness of any of the data provided, and assumes no legal responsibility for the information contained on this map. Any use of this product with respect to accuracy and precision shall be the sole responsibility of the user.

## MAPS/IMAGES

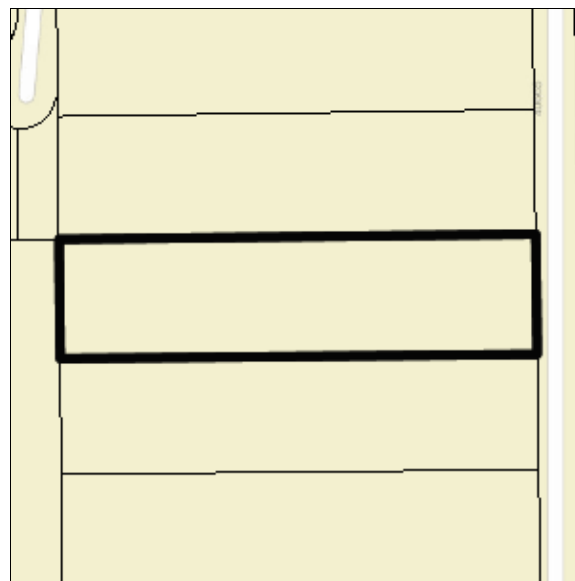

## PARCEL

APN	607-040-037-3	Supervisorial District	V MANUEL PEREZ, DISTRICT 4
Previous APN	607040037 607040007, 607040008, 607040009, 607040010, more	Township/Range	T5SR7E SEC 7 NW
Owner Name	NOT AVAILABLE ONLINE	Elevation	101 ft
Address	607040037 40775 YUCCA LN INDIO CA 92203	Thomas Bros. Map Page/Grid	PAGE: 819, GRID: F3 PAGE: 819, GRID: F4
Mailing Address	607040037 35450 PEGASUS CT PALM DESERT CA 92211	Indian Tribal Land	NOT IN A TRIBAL LAND
Legal Description	607040037 Recorded Book/Page: RS 23/43 Subdivision Name: Lot/Parcel: 27 Block: Tract Number:	City Boundary	NOT IN A CITY
		City Spheres of influence	PALM DESERT
Lot Size	607040037 Recorded lot size is 2.30 acres	March Joint Powers Authority	NOT IN THE JURISDICTION OF THE MARCH JOINT POWERS AUTHORITY

Property	607040037	County Service Area	NOT IN A COUNTY SERVICE AREA
Characteristics	Year Constructed: 1997 Baths: 2 Bedrooms: 2 Construction Type: Wood or Light Steel (D) Garage Type: Attached Garage Property Area (sq ft): 3629 Roof Type: Tile/Slate Stories: 1 Pool: NO Central Cool: YES Central Heat: YES		

Annexation Date	N/A	LAFCO Case	N/A
-----------------	-----	------------	-----

Proposals	N/A
-----------	-----

### PLANNING more...

Specific Plans	NOT IN A SPECIFIC PLAN	Historic Preservation Districts	NOT IN A HISTORIC PRESERVATION DISTRICT
Land Use Designations	VLDR	Agricultural Preserve	NOT IN AN AGRICULTURAL PRESERVE
General Plan Policy Overlays	N/A		
Area Plan (RCIP)	Western Coachella Valley	Airport Influence Areas	BERMUDA DUNES
General Plan Policy Areas	NOT IN A GENERAL PLAN POLICY AREA	Airport Compatibility Zones	BERMUDA DUNES, ZONE C
<a href="#">Zoning Classifications (ORD. 348)</a>	R-1-12000	Zoning Districts and Zoning Areas	BERMUDA DUNES DIST
Zoning Overlays	BERMUDA DUNES	Community Advisory Councils	BERMUDA DUNES CC

Residential Permit Stats	N/A		
--------------------------	-----	--	--

### ENVIRONMENTAL more...

<a href="#">CVMSHCP (Coachella Valley Multi-Species Habitat Conservation Plan) Plan Area</a>	COACHELLA VALLEY	WRMSHCP (Western Riverside County Multi-Species Habitat Conservation Plan) Cell Group	NOT IN A CELL GROUP
CVMSHCP (Coachella Valley Multi-Species Habitat Conservation Plan) Conservation Area	NOT COACHELLA VALLEY CONSERVATION AREA	WRMSHCP Cell Number	NOT IN A CELL NUMBER
CVMSHCP Fluvial Sand Transport Special Provision Areas	NOT IN A FLUVIAL SAND TRANSPORT SPECIAL PROVISION AREA	HANS/ERP (Habitat Acquisition and Negotiation Strategy/Expedited Review Process)	NOT IN A HANS/ERP PROJECT
<a href="#">WRMSHCP (Western Riverside County Multi-Species Habitat Conservation Plan) Plan Area</a>	NOT IN A WESTERN RIVERSIDE COUNTY PLAN FEE AREA	Vegetation (2005)	NOT IN A VEGETATION AREA

### Fire

Fire Hazard Classification ( <a href="#">Ord. 787</a> )	NOT IN A FIRE HAZARD ZONE	Fire Responsibility Area	NOT IN A FIRE RESPONSIBILITY AREA
---	---------------------------	--------------------------	-----------------------------------

### DEVELOPMENT FEES

<a href="#">CVMSHCP (Coachella Valley Multi-Species Habitat Conservation Plan) Fee Area (Ord 875)</a>	COACHELLA VALLEY	RBBB (Road & Bridge Benefit District)	NOT IN A ROAD BRIDGE BENEFIT DISTRICT
<a href="#">WRMSHCP (Western Riverside County Multi-Species Habitat Conservation Plan) Fee Area (Ord. 810)</a>	NOT IN A WESTERN RIVERSIDE COUNTY PLAN FEE AREA	<a href="#">DIF (Development Impact Fee Area Ord. 659)</a>	WESTERN COACHELLA VALLEY, AREA 2
<a href="#">Western TUMF (Transportation Uniform Mitigation Fee Ord. 824)</a>	NOT IN THE WESTERN TUMF FEE AREA	<a href="#">SKR Fee Area (Stephen's Kagaroo Rat Ord. 663.10)</a>	NOT IN THE SKR FEE AREA
<a href="#">Eastern TUMF (Transportation Uniform Mitigation Fee Ord. 673)</a>	IN OR PARTIALLY WITHIN A TUMF FEE AREA	DA (Development Agreements)	NOT IN A DEVELOPMENT

**TRANSPORTATION more...**

Circulation Element	NOT IN A CIRCULATION ELEMENT	Road Book Page	207A
Ultimate Right-of-Way	RIGHT-OF-WAY	Transportation Agreements	NOT IN A TRANS AGREEMENT
		CETAP (Community and Environmental Transportation Acceptability Process) Corridors	NOT IN A CETAP CORRIDOR

**HYDROLOGY**

Flood Plan Review	OUTSIDE FLOODPLAIN, REVIEW NOT REQUIRED	Watershed	WHITEWATER
Water District	COACHELLA VALLEY WATER DISTRICT		
Flood Control District	COACHELLA VALLEY WATER DISTRICT		

**GEOLOGIC**

Fault Zone	NOT IN A FAULT ZONE	Paleontological Sensitivity	LOW POTENTIAL (L): FOLLOWING A LITERATURE SEARCH, RECORDS CHECK AND A FIELD SURVEY, AREAS MAY BE DETERMINED BY A QUALIFIED VERTEBRATE PALEONTOLOGIST AS HAVING LOW POTENTIAL FOR CONTAINING SIGNIFICANT PALEONTOLOGICAL RESOURCES SUBJECT TO ADVERSE IMPACTS.
Faults	NOT IN A FAULT LINE		
Liquefaction Potential	MODERATE		
Subsidence	SUSCEPTIBLE		

**MISCELLANEOUS**

School District	DESERT SANDS UNIFIED
Communities	BERMUDA DUNES
Lighting (Ord. 655)	ZONE: B
2010 Census Tract	452.33
Farmland	URBAN-BUILT UP LAND
Special Notes	PLEASE REFER TO ORDINANCE 457.96 FOR COACHELLA VALLEY AGRICULTURAL GRADING EXEMPTIONS.
Tax Rate Areas	075004 - CITRUS PEST CONTROL 2 075004 - CO FREE LIBRARY 075004 - CO STRUCTURE FIRE PROTECTION 075004 - CO WASTE RESOURCE MGMT DIST 075004 - COACHELLA VALLEY JOINT BLO HS 075004 - COACHELLA VALLEY PUBLIC CEMETERY 075004 - COACHELLA VALLEY REC & PK 075004 - COACHELLA VALLEY RESOURCE CONS 075004 - COACHELLA VALLEY WATER DISTRICT 075004 - CSA 152 075004 - CV MOSQUITO & VECTOR CONTROL 075004 - CVWD IMP DIST 1 DS 075004 - CVWD STORM WATER UNIT 075004 - DESERT COMMUNITY COLLEGE 075004 - DESERT SANDS UNIFIED SCHOOL 075004 - GENERAL 075004 - GENERAL PURPOSE 075004 - RIV CO REGIONAL PARK & OPEN SP 075004 - RIVERSIDE CO OFC OF EDUCATION 075004 - SUPERVISORIAL RD DIST 4

**Department of Environmental Health Permits**

**Septic Permits**

Record Id	Application Date	Plan Check Approved Date	Final Inspection Date	Approved Date
N/A	N/A	N/A	N/A	N/A
<b>Septic Permits</b>				
<b>Well Water Permits</b>				
Record Id	PE	Permit Paid Date	Permit Approved Date	Well Finaled Date
N/A	N/A	N/A	N/A	N/A
<b>PLUS PERMITS &amp; CASES</b>				
<b>Administrative Cases</b>				
Case	Case Description			Status
MT990686	TR22023 LOT 27			PAID
<b>Building and Safety Cases</b>				
Case	Case Description			Status
418083	SFR DEPOSIT BASED PC/BP FEES AIR896 R-3 R 1528 3590 DWELL896 R-3 WOOD 1528 50821 PAT896 U V-N 496 5376 PRIGR896 U-1 WOOD 487 7363			FINAL
BAR000391	ADD HOBBY ROOM TO EXISTING GARAGE 1000 SQ FT			FINAL
BWL140615	BLOCK WALL/14 PILASTERS W/I PROPERTY LINE CO STAND			EXPIRED
BWL151067	ELEC TO ENTRY GATE PILASTERS (FINAL BWL140615)			FINAL
BXX070987	RE-ROOF REPLACE WITH METRO SHINGLES ICBO#5626			EXPIRED
BXX980806	DETACHED METAL SHED			FINAL
<b>Code Cases</b>				
Case	Case Description			Status
CV1505385				Closed - RMAP Field
<b>Fire Cases</b>				
Case	Case Description			Status
N/A	N/A			N/A
<b>Planning Cases</b>				
Case	Case Description			Status
CZ07697	ORD AMD 348.4636 TO EST PROPERTY MAINT STANDARDS			APPROVED
PPA210026	MINOR PLOT PLAN WQMP - FOR PROPOSED ACCESSORY STRUCTURES TO EXCEED 5,000 SQUARE FEET			ASSIGNED
<b>Survey Cases</b>				
Case	Case Description			Status
N/A	N/A			N/A
<b>Transportation Cases</b>				
Case	Case Description			Status
BIC090776	LIC: 003269			COMPLETED
BIC092182	LIC: 000947			COMPLETED
BIC120628	LIC: 000947			COMPLETED

