

## Building Sketch

Borrower				
Property Address 1729 Haynes Ln				
City	Redondo Beach	County	Los Angeles	State CA Zip Code 90278
Lender/Client				

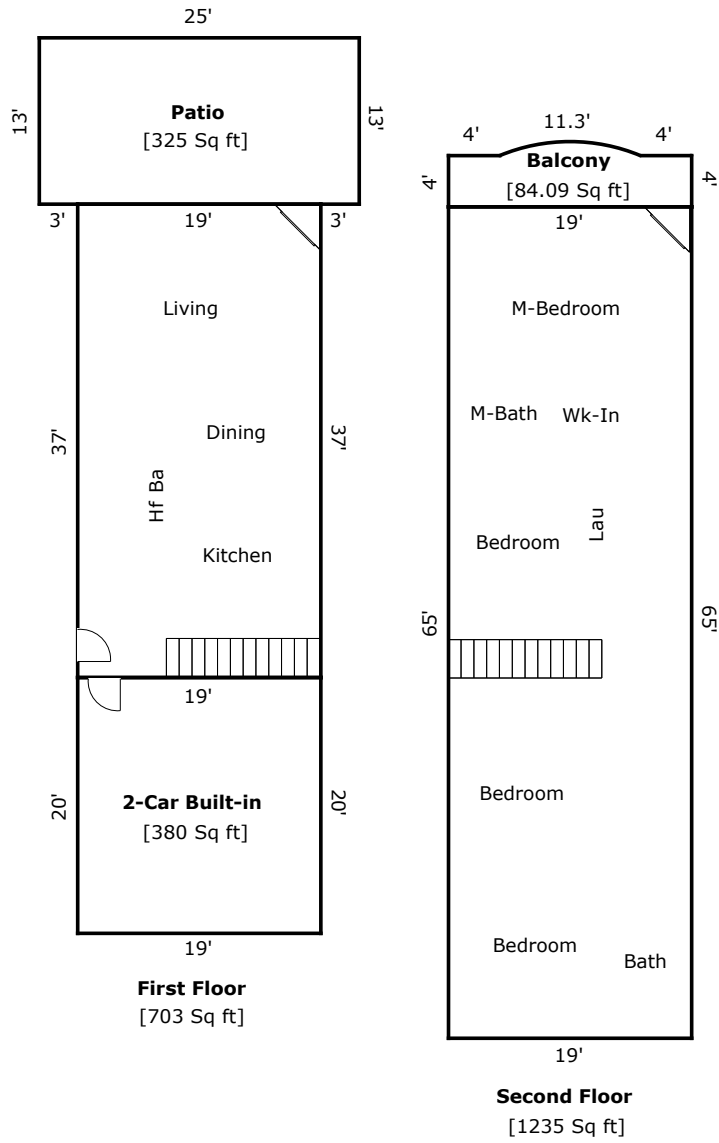

TOTAL Sketch by a la mode

### Area Calculations Summary

Living Area	Calculation Details	
First Floor	703 Sq ft	$37 \times 19 = 703$
Second Floor	1235 Sq ft	$19 \times 65 = 1235$
<b>Total Living Area (Rounded):</b>	<b>1938 Sq ft</b>	
Non-living Area		
2-Car Built-in	380 Sq ft	$19 \times 20 = 380$
Patio	325 Sq ft	$13 \times 25 = 325$
Balcony	84.1 Sq ft	$19 \times 4 = 76$ Arc = 8.1