

**Estimated Total Finished
Square Footage: 1,705 SQ FT**

Above-Grade: 1,470 SQ FT Below-Grade: 235 SQ FT

Plus 425 SQ FT 2-Car Garage on Lower Level

Calculated per ANSI Standard Z765-2003.

106 S LUCIA AVENUE | UNIT 4

REDONDO BEACH, CA 90278

* Estimated Total Finished & Unfinished Square Footage: 2,130 SQ FT

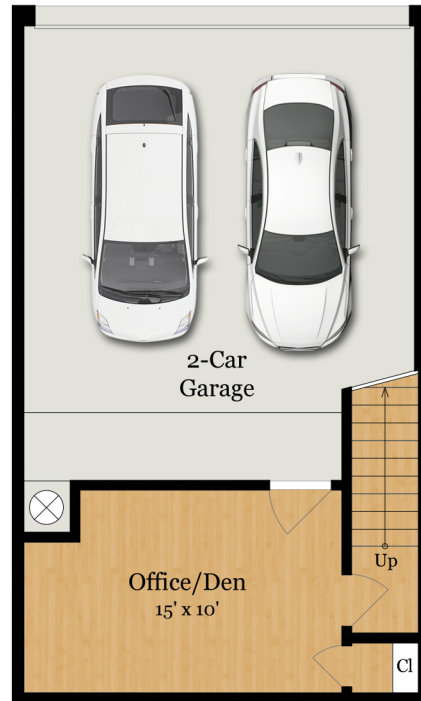

LOWER LEVEL
235 SQ FT

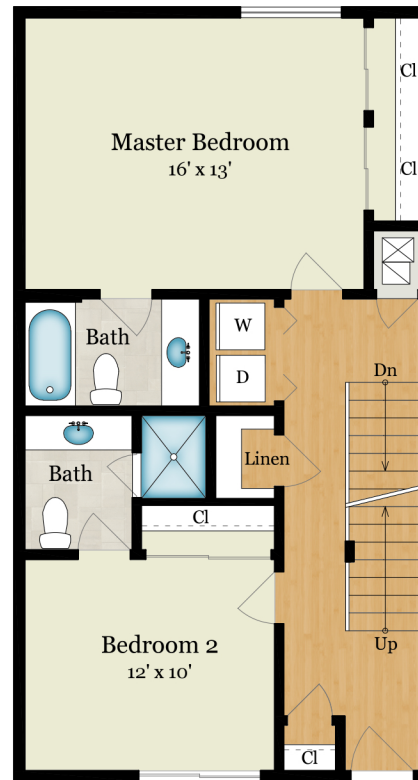

FIRST FLOOR
735 SQ FT

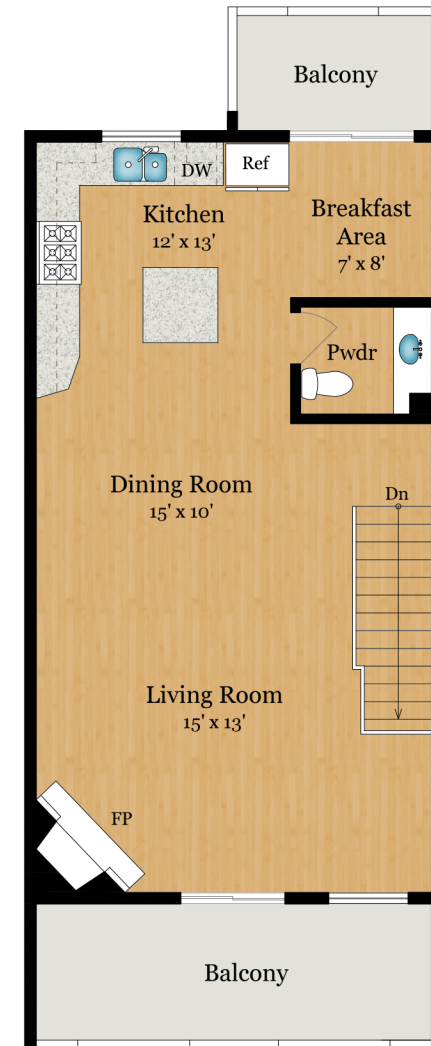

SECOND FLOOR
735 SQ FT

