

CHICO SEPTIC

Complete
SEPTIC SERVICE

5050 Cohasset Rd Suite 70, Chico, CA 95926
530-343-6340

SEPTIC TANK PUMPER'S INSPECTION REPORT (Page 1 of 3)

Owner/Agent: Andrew Bays

Date of Inspection: 11/22/21

Address: 15 Dream Lane

SEPTIC TANK INFORMATION & CONDITION

Septic Tank Sectional View

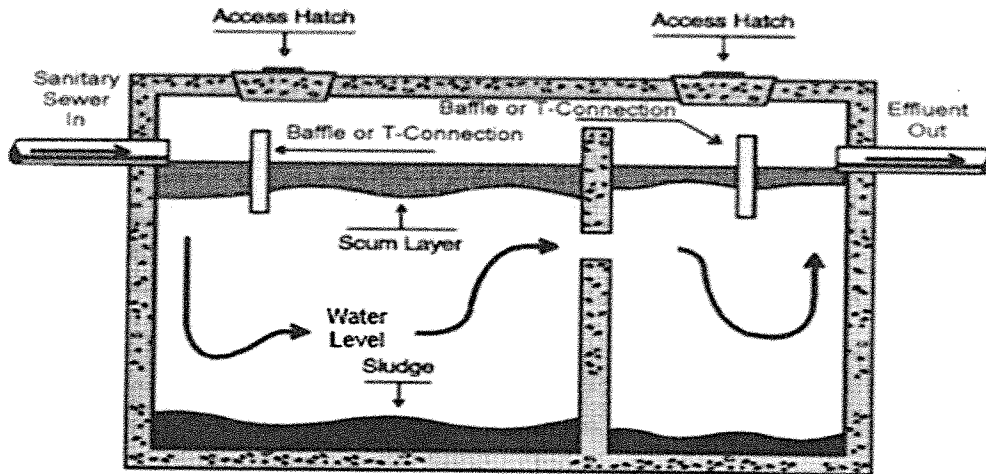

ACCESS HATCH/LID (We check the lids to make sure there are no major cracks and That it fits snug. There needs to be enough lids to access each compartment, and their construction need to be sound and meets code.)

Lid Construction &
Quantity: (2)Concrete

RISERS (Risers are lid extensions and if they are at the surface this makes it easier to service and monitor the system. If they are present we will check them for safety and operation.)

Lid Condition: Good

Risers: N/A

TANK (We check condition of tank, walls, floor, etc. to determine its construction is sound, meets code, and is free from defects. We then measure the septic to determine its size and gallons pumped. Tanks need to be pumped for two reasons: 1 To inspect the septic tank 2. When the scum and sludge thickness exceeds 25% of the tank's depth to insure proper bacterial action and to keep the system working efficiently. Tanks are measured to the best of our ability with a tape measure and can vary due to the limited access.)

Tank Construction: Concrete

Tank Condition: Good

Inside Length: 9ft x Inside Width: 3.5ft x Depth of Effluent: 5ft x 7.48 = Gallons: 1200

Crust Thickness: 19in

Sludge Thickness: 4in

Gallons Pumped: 1200

**If the above "Percent of Solids" is greater than 40% this may indicate a lack of pumping and/or maintenance of the system, if there is a concern that solids may have filtered out to the leach field, we can do further investigation upon your request.*

SEPTIC TANK PUMPER REPORT (Page 2 of 3)

Address: 15 Dream Lane

Date of Inspection: 11/22/21

SEPTIC TANK INFORMATION & CONDITION (continued)

OPERATION (We are looking for evidence of abnormal water levels. Level should be at the invert (bottom) of outlet sanitary tee. Water level higher than the outlet pipe or evidence of seepage into the soil through the lids of the tank may point to possible leach field problems. If the water level is low in the septic then it could be evidence of seam leaking septage out of the tank. We also check around the septic area, if known, to determine if there is any evidence of possible problems indicated by seepage in the soil, odor, or other. If available we will attempt to test the outgoing line with 100-150 gallons of water – all of the water should be accepted by this line.)

Water Level: Operating

Did Water Flow Back: No

Evidence of Surfacing: No

Gallons Used For
Operation Test: 150

Result of Load Test: Excellent

BAFFLE (The baffle separates the solids in the first compartment and allows liquid into the second compartment. The baffles are checked for defects, that its construction is sound, and meets code.)

Baffle Construction &
Condition: Concrete/ Good

INLET & OUTLET TEES (We check the inlet and outlet sanitary tees to make sure they are securely attached with approximately 12 to 18 inch drop lines on each, and that their construction is sound and meets code.)

Inlet Construction &
Condition: 4"ABS/Good

EFFLUENT FILTER (If present, we will pull this filter, inspect it, and clean it of sludge buildup and reinstall. Not all septic have this filter, but if one is present it should be cleaned annually.)

Outlet Construction &
Condition: (2)4"SDR/ Good

Outlet Filter: None

OTHER (Some systems may require additional services like county required annual maintenance and 24hr monitoring)

County Maintenance
Required: No

TIPS TO KEEP THIS SEPTIC SYSTEM FREE-FLOWING

When doing laundry wash loads evenly throughout the week and always run full loads to use water wisely.

Normal amounts of household detergents, bleaches, drain cleaners, and other household chemicals can be used and won't stop the bacterial action in the septic tank. But don't use excessive amounts of any household chemicals. Do not dump cleaning water for latex paint brushed and cans into the house sewer

Don't deposit coffee grounds, cooking fats, wet-strength towels, disposable diapers, facial tissues, cigarette butts, and other non-decomposable material into the house sewer. These materials won't decompose and will fill the septic tank and plug the system.

If you must use a garbage disposal, you will likely need to remove septic tank solids more often. Ground garbage will likely find its way out of the septic tank and plug up the drain field. It is better to compost, incinerate, or deposit the materials in the garbage that will be hauled away.

Clean your septic tank every three to five years. How often depends on the size of the tank and how many solids go into it. A rule of thumb is once every 3 years for a 1,000 gallon tank serving a 3 bedroom home with 4 occupants.

SEPTIC TANK PUMPER REPORT (Page 3 of 3)

Address: 15 Dream LN

Date of Inspection:11/22/21

RECOMMENDATIONS/CORRECTION/REMARKS

Passing Inspection. Everything is in good working condition.

The average septic tank should be pumped every three to five years to insure proper bacterial action and to keep the system working efficiently. As you know, this maintenance is critical to the over-all performance of the sewage disposal system, neglecting to perform this maintenance can lead to premature backing up of your septic tank.

I also recommend water conservation should be enlisted for household water use to maximize the life expectancy of the absorption trenches. Each septic system has a certain capacity. When this capacity is reached or exceeded, there will likely be problems because the system won't take as much sewage as you want to discharge into it. When the onsite sewage treatment system reaches its daily capacity, be conservative with your use of water. Each gallon of water that flows into the drain must go through the septic tank and into the soil absorption unit. There may be other ways to conserve water that you can think of in your home. The main idea is to consider water as a valuable resource and not to waste it. Take care of any household leaks to avoid unnecessarily saturating the leach trenches.

Following a few simple rules like not using too much water and not depositing materials in the septic tank that bacteria can't decompose should help to make a septic system trouble free for many years. But don't forget the septic tank does need to be cleaned out when too many solids build up. Septic tanks need tender, loving care too!

On behalf of all of us, thank you for this opportunity to work with you.

Rachel Bartlett, Owner

WE DECLARE THAT THE INFORMATION HEREIN IS TRUE AND CORRECT TO THE BEST OF OUR KNOWLEDGE. We can only attest to the condition of the tank at the time of pumping on the above date and cannot be held liable for any condition that might arise after inspection. We cannot be held liable for any past or future problems that may arise due to weather conditions, vacancy during time of inspection, changes in the size of household and/or proper care and maintenance of the septic system. If system passes inspection, satisfactory performance is expected. However, the septic system is existing and "used" which means that no guarantee can be made as to the length of time that satisfactory service will occur.

5050 Cohasset Rd, Suite 70
Chico, CA 95926
530-343-6340
www.chicoseptic.com

CHICO SEPTIC

Complete
SEPTIC SERVICE

15 Dream Lane

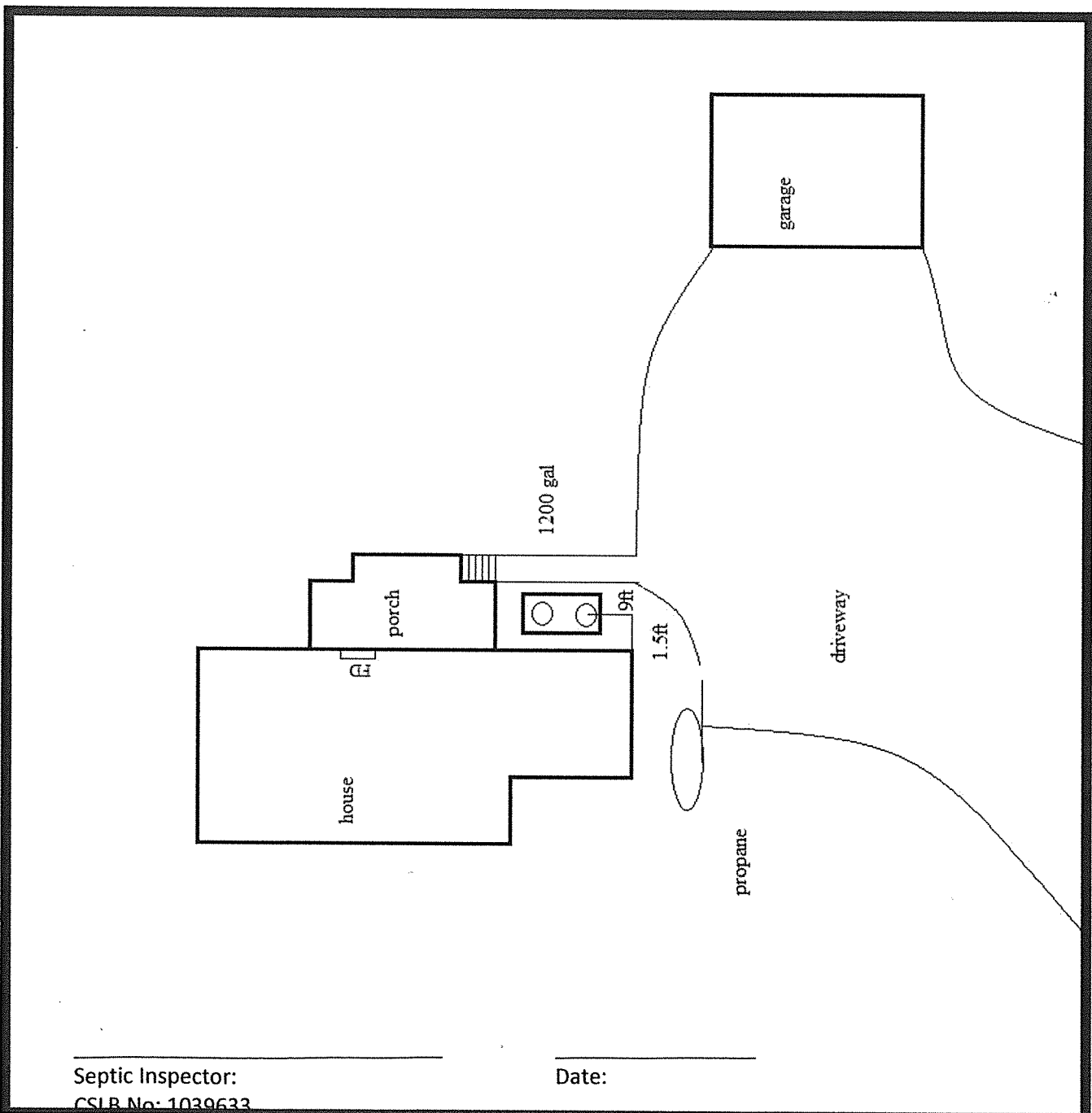

Septic Inspector: _____
CSLB No: 1039633

Date: _____