

## WOOD DESTROYING PESTS AND ORGANISMS INSPECTION REPORT

Building Address: <b>9439 Shade Ln., Pico Rivera, CA 90660</b>		Date of Inspection <b>03/21/2024</b>	Number of Pages <b>7</b>
	<b>A1 Termite and Pest Control Co.</b> 1001 S. Olive St. #147 Los Angeles, CA 90015 Ph: (213) 388-4506 a1termiteandpestcontrol@gmail.com		Report # <b>W14578</b>
			Lic. Registration # <b>PR 4805</b>
			Escrow #
Ordered by: Your Home Sold Guaranteed Realty Sunny Wong (626) 636-5577 - Cell	Property Owner and/or Party of Interest:	Report Sent to: Your Home Sold Guaranteed Realty Sunny Wong (626) 636-5577 - Cell	
COMPLETE REPORT <input checked="" type="checkbox"/> LIMITED REPORT <input type="checkbox"/> SUPPLEMENTAL REPORT <input type="checkbox"/> REINSPECTION REPORT <input type="checkbox"/>			
General Description: Single Family Residence, 1 Story, Frame and Stucco, Composition Roof		Inspection Tag Posted:	
		Other Tags Posted: None	
An inspection has been made of the structure(s) shown on the diagram in accordance with the Structural Pest Control Act. Detached porches, detached steps, detached decks and any other structures not on the diagram were not inspected.			
Subterranean Termites <input type="checkbox"/> Drywood Termites <input checked="" type="checkbox"/> Fungus / Dryrot <input checked="" type="checkbox"/> Other Findings <input type="checkbox"/> Further Inspection <input type="checkbox"/>			
If any of the above boxes are checked, it indicates that there were visible problems in accessible areas. Read the report for the details on checked items.			

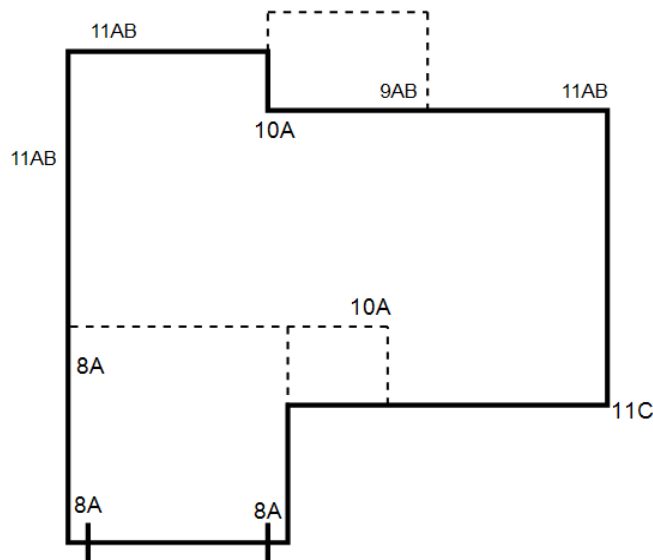
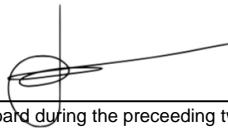

This Diagram is not to scale

Inspected by: Juan F Tejada Jr. State License No. FR 56019 Signature 

You are entitled to obtain copies of all reports and completion notices on this property reported to the Structural Pest Control Board during the preceding two years. To obtain copies contact: Structural Pest Control Board, 2005 Evergreen Street, Ste. 1500, Sacramento, California 95815.

NOTE: Questions or problems concerning the above report should be directed to the manager of the company. Unresolved questions or problems with the services performed may be directed to the Structural Pest Control Board at (916) 561-8708, (800) 737-8188 or www.pestboard.ca.gov

SECOND PAGE OF STANDARD INSPECTION REPORT OF THE PROPERTY LOCATED AT:

Address 9439 Shade Ln., Pico Rivera, CA 90660

03/21/2024

W14578

Date

Report #

What is a Wood Destroying Pest and Organism Inspection Report?

The following explains the scope and limitations of a structural pest control inspection and a Wood Destroying Pest & Organism Inspection Report.

A Wood Destroying Pest & Organism Inspection Report contains finding as to the presence or absence of wood destroying insects or organisms in visible and accessible areas on the date of inspection and contains our recommendations for correcting any infestations, infections, or conditions found. The contents of the wood destroying pest & organism inspection report are governed by the structural pest control act and its rules and regulations.

Some structures may not comply with building code requirements or may have structural, plumbing, electrical, heating and air conditioning, or other defects that do not pertain to this report. This report does not address any such defects as they are not within the scope of the license of the inspector or the company issuing this report.

The following areas are considered inaccessible for purposes of inspection or are not included in a normal inspection report and therefore are excluded in this report: the interior of hollow walls; spaces between an upstairs floor and the ceiling below or a porch deck and soffit below; stall showers over finished ceilings; such structural segments as areas enclosed by bay windows, buttresses, built in cabinet work, areas under floor covering; any areas requiring the removal of storage, furnishings or appliances; any areas to which there is no access without defacing or removing lumber, masonry or finished workmanship.

Certain areas are recognized by the industry as inaccessible and/or for other reasons not inspected. These include but are not limited to: inaccessible and/or, insulated attics or portions thereof, attics with less than 18" clear crawl space, the interior of hollow walls; spaces between a floor or porch deck and the ceiling below; areas where there is no access without defacing or tearing out lumber, masonry or finished work; make inspection impractical; and areas or timbers around eaves that would require use of an extension ladder.

Certain areas may be inaccessible for inspection due to construction or storage. We recommend further inspection of areas where inspection was impractical. Re: Structural Pest Control Act, Article 6, section 8516 (b), paragraph 1990 (l). Amended effective March 1, 1974. Stall shower, if any, are water tested in compliance with Section 1991 (12) of the Structural Pest Control Act. The absence or presence of leaks through sub-floor, adjacent floors or walls will be reported. This is a report of the condition of the stall shower at the time of inspection only, and should not be confused as a guarantee. Although we make a visual examination, we do not deface or probe into window or door frames, decorative trim, roof members, etc., in search of wood destroying pests or organisms.

**"This company will reinspect repairs done by others within four months of the original inspection. A charge, if any, can be no greater than the original inspection fee for each reinspection. The reinspection must be done within ten (10) working days of request. The reinspection is a visual inspection and if inspection of concealed areas is desired, inspection of work in progress will be necessary. Any guarantees must be received from parties performing repairs."**

**Structural Pest Control Act, page 131: Title 16. Professional and Vocational Regulations Article 5, §1993.1**

NOTE: We do not inspect or certify plumbing, plumbing fixtures, etc.

**NOTE: "The exterior surface of the roof was not inspected. If you want the water tightness of the roof determined, you should contract a roofing contractor who is licensed by the Contractor's State License Board."**

"NOTICE: The charge for service that this company subcontracts to another person or entity may include the company's charges for arranging and administering such services that are in addition to the direct costs associated with paying the subcontractor. You may accept A1 Termite and Pest Control Inc.'s bid or you may contract directly with another registered company licensed to perform the work.

If you choose to contract directly with another registered company, A1 Termite and Pest Control Inc. will not in any way be responsible for any act or omission in the performance of work that you directly contract with another to perform."

**"NOTICE: Reports on this structure prepared by various registered companies should list the same findings (i.e. termite infestations, termite damage, fungus damage, etc.). However, recommendations to correct these findings may vary from company to company. You have a right to seek a second opinion from another company."**

This Wood Destroying Pest & Organisms Report DOES NOT INCLUDE MOLD or any mold like conditions. No reference will be made to mold or mold-like conditions. Mold is not a Wood Destroying Organism and is outside the scope of this report as defined by the Structural Pest Control Act. If you wish your property to be inspected for mold or mold like conditions, please contact the appropriate mold professional.

"Local treatment is not intended to be an entire structure treatment method. If infestations or wood-destroying pests extend or exist beyond the area(s) of local treatment, they may not be exterminated."

---

THIRD PAGE OF STANDARD INSPECTION REPORT OF THE PROPERTY LOCATED AT:

Address 9439 Shade Ln., Pico Rivera, CA 90660

03/21/2024

W14578

Date

Report #

A separated report has been requested which is defined as section I / section II conditions evident on the date of inspection. Section I contains items where there is evidence of active infestation, infection of conditions that have resulted in or from infestation of infection. Section II items are conditions deemed likely to lead to infestation or infection but where no visible evidence of such was found. Further inspection items are defined as recommendations to inspect area(s) which during the original inspection did not allow the inspector access to complete his inspection and cannot be defined as section I or section II.

---

**FINDINGS AND RECOMMENDATIONS**

---

**Substructure Area:** Concrete slab

**Foundations:** Concrete above grade

**Porches - Steps:** Concrete

**Ventilation:** Adequate above grade

**Abutments:** None

**Attic Spaces:** None

**Garages:** Finished walls

8A PRICE: \$1,850.00 (Section I)  
FINDINGS: Evidence of dry-wood termite infestations at wood members as indicated on the diagram.  
RECOMMENDATION: Vacate the premises and seal the structure for fumigation with Vikane Gas. Remove or cover accessible evidence of infestation. Fumigation warranted for two years. Fumigation awareness notice must be signed prior to fumigation. See fumigation notice for terms and liabilities.

**Decks - Patios:** Patio

9A PRICE: See 8A (Section I)  
FINDINGS: Evidence of dry-wood termite infestations at wood members as indicated on the diagram.  
RECOMMENDATION: Vacate the premises and seal the structure for fumigation with Vikane Gas. Remove or cover accessible evidence of infestation. Fumigation warranted for two years. Fumigation awareness notice must be signed prior to fumigation. See fumigation notice for terms and liabilities.

9B PRICE: \$785.00 (Section I)  
FINDINGS: Evidence of termite damaged wood members noted at time of inspection at ledger as indicated on the diagram.  
RECOMMENDATION: Repair or cut and replace termite damaged wood members as necessary. Only one coat of painting is included in this estimate.

**Other Interior:** Vacant

Address 9439 Shade Ln., Pico Rivera, CA 90660

03/21/2024

W14578

Date

Report #

**- Findings and Recommendations continued from previous page -**

- 10A PRICE: See 8A (Section I)  
FINDINGS: Evidence of dry-wood termite infestations at wood members as indicated on the diagram.  
RECOMMENDATION: Vacate the premises and seal the structure for fumigation with Vikane Gas. Remove or cover accessible evidence of infestation. Fumigation warranted for two years. Fumigation awareness notice must be signed prior to fumigation. See fumigation notice for terms and liabilities.

**Other Exterior:**

- 11A PRICE: See 8A (Section I)  
FINDINGS: Evidence of dry-wood termite infestations at wood members as indicated on the diagram.  
RECOMMENDATION: Vacate the premises and seal the structure for fumigation with Vikane Gas. Remove or cover accessible evidence of infestation. Fumigation warranted for two years. Fumigation awareness notice must be signed prior to fumigation. See fumigation notice for terms and liabilities.
- 11B PRICE: See 9B (Section I)  
FINDINGS: Evidence of termite damaged wood members noted at time of inspection at fascias and roof sheathings, as indicated on the diagram.  
RECOMMENDATION: Repair or cut and replace termite damaged wood members as necessary. Only one coat of painting is included in this estimate.
- 11C PRICE: See 9B (Section I)  
FINDINGS: Dry-rot wood members found at time of inspection at fascia as indicated on the diagram.  
RECOMMENDATION: Cut and replace, scrape off and patch and/or cut off dry-rot damaged wood members as necessary. Only one coat of painting is included in this estimate.
-

FIFTH PAGE OF STANDARD INSPECTION REPORT OF THE PROPERTY LOCATED AT:

Address 9439 Shade Ln., Pico Rivera, CA 90660

03/21/2024

W14578

Date

Report #

In accordance with the laws and regulation of the State of California, we are required to provide you with the following information prior to application of pesticides to your property.

"State law requires that you be given the following information: CAUTION, PESTICIDES ARE TOXIC CHEMICALS. Structural Pest Control Companies are registered and regulated by the Structural Pest Control Board, and apply pesticides which are registered and approved for use by the California Dept. of Pesticide Regulation and the United States Environmental Protection Agency. Registration is granted when the State finds that based on existing scientific evidence there are no appreciable risks if proper use conditions are followed or that the risks are outweighed by the benefits. The degree of risk depends upon the degree of exposure, so exposure should be minimized."

"If within 24 hours following application, you experience symptoms similar to common seasonal illness comparable to the flu, contact your physician or poison control center (800) 876-4766 and your pest control operator immediately." Effects of over exposure to these materials can include tremors and tonic and colonic convulsions.

For further information, contact any of the following:

<b>A1 Termite and Pest Control Inc.</b>	<b>(213) 388-4506</b>
<b>Poison Control Center</b>	<b>(800) 876-4766</b>
<b>(Health Questions) County Health Dept.</b>	
<b>Orange County</b>	<b>(714) 834-7700</b>
<b>Los Angeles County</b>	<b>(213) 250-8055</b>
<b>San Bernardino County</b>	<b>(909) 387-6280</b>
<b>Riverside County</b>	<b>(909) 358-5000</b>
<b>(Application Info.) County Agriculture Commission</b>	
<b>Orange County</b>	<b>(714) 447-7100</b>
<b>Los Angeles County</b>	<b>(626) 575-5465</b>
<b>San Bernardino County</b>	<b>(909) 387-2115</b>
<b>Riverside County</b>	<b>(909) 955-3045</b>
<b>Structural Pest Control Board (Regulatory Info.)</b>	<b>(916) 561-8704</b>
<b>2005 Evergreen St. Ste. 1500, Sacramento, CA 95815</b>	

TERMITE AND FUNGUS CONTROL CHEMICALS

Vikane (EPA Reg. No. 62719-4)

Active Ingredients: Vikane-sulfuryl floride 99.5%, Chloropicrin .5%

NOTICE TO OWNER

Under the California Mechanic's Lien Law any structural pest control company which contracts to do work for you, any contractor, subcontractor, laborer, supplier or other person who help to improve your property, but is not paid for his work or supplies, has the right to enforce a claim against your property. This means that after a court hearing, your property could be sold by a court officer and the proceeds of the sale used to satisfy the indebtedness. This can happen even if you have paid your structural pest control company in full if the sub-contractor, laborers, or suppliers remain unpaid. To preserve their right to file a claim of lien against your property, certain claimants such as subcontractors or material suppliers are required to provide you with a document entitled "Preliminary Notice". Prime contractors and laborers for wages do not have to provide this notice. A Preliminary Notice is not a lien against your property. Its purpose is to notify you of persons who may have a right to file a lien against your property if they are not paid.

NOTE: If the Home Owner fails to pay billing in full, A1 Termite and Pest Control Inc. will have the right to be paid back for all its costs and expenses to the extent not prohibited by applicable law. Those expenses include, for example (but not limited to), reasonable attorney's fees. If for any reason this account is to be turned over to our collection agency, You will be responsible for all cost of collecting.

SIXTH PAGE OF STANDARD INSPECTION REPORT OF THE PROPERTY LOCATED AT:

Address 9439 Shade Ln., Pico Rivera, CA 90660

03/21/2024

W14578

---

Date

Report #

CONDITIONAL GUARANTEE: A1 Termite and Pest Control Inc. guarantees fumigation for 2 years and local treatment ( at the area/areas treated ) for 1year performed by this company , Wood repair work is guaranteed 6 months. This company is not responsible for any future infestation, dry rot or adverse conditions beyond the time of inspection. If fumigation is performed, A1 Termite and Pest Control Inc. is not liable for any damage to shrubs, vines, trees, etc. or any damage to roofs or roof members at the time of Fumigation. In the event that a re-treatment, re-fumigation or any other repair work is to be performed to honor a guarantee issued by A1 Termite and Pest Control Inc.; the homeowner is responsible to make the property available for any work to be performed. A1 Termite and Pest Control Inc. will not be liable for any cost of vacating or preparing the residence for re-treatment; and/or wood repairs. The clearance report issued by this company is valid for 1 month from the date of inspection. NOTE: A new and/or extension of guarantee is never given for re-treatments done under original guarantee.

SEVENTH PAGE OF STANDARD INSPECTION REPORT OF THE PROPERTY LOCATED AT:

Address 9439 Shade Ln., Pico Rivera, CA 90660

03/21/2024

W14578

Date

Report #

**Findings and Recommendations estimated by this Company:**

Item	Approval	Primary Estimate	Section
8A	<input type="checkbox"/>	\$1,850.00	I
9A	<input type="checkbox"/>	Included in 8A	I
9B	<input type="checkbox"/>	\$785.00	I
10A	<input type="checkbox"/>	Included in 8A	I
11A	<input type="checkbox"/>	Included in 8A	I
11B	<input type="checkbox"/>	Included in 9B	I
11C	<input type="checkbox"/>	Included in 9B	I

Complete all of the items quoted above with Primary Estimate.

**Total Estimate \$2,635.00**

Complete only the above Items checked.

Total \$ \_\_\_\_\_

*I have read and understand the terms of the Report referenced above and agree to the terms and conditions set forth. A1 Termite and Pest Control Inc. is hereby authorized to complete the Items selected above and it is agreed that payment shall be made as follows:*

Payment shall be made as follows:  With close of Escrow  \$ \_\_\_\_\_ Deposit  \$ \_\_\_\_\_ on Completion

Escrow Number: \_\_\_\_\_ Escrow Company: \_\_\_\_\_ Escrow Officer: \_\_\_\_\_

Phone ( ) \_\_\_\_\_ - \_\_\_\_\_ Email: \_\_\_\_\_ Address: \_\_\_\_\_

Owner or Authorized Representative:  Owner  Representative's Title: \_\_\_\_\_

Print Name: \_\_\_\_\_ X \_\_\_\_\_ Date \_\_\_\_\_

Owner or Authorized Representative:  Owner  Representative's Title: \_\_\_\_\_

Print Name: \_\_\_\_\_ X \_\_\_\_\_ Date \_\_\_\_\_

