

RPRR# 6677

CITY OF PALOS VERDES ESTATES
Application for Real Property Records Report
340 Palos Verdes Drive West
Palos Verdes Estates, CA 90274-1299

Escrow #

Property Address 1636 Via Machado Owner Petillon Family Trust Date Received 01/17/2023

Applicant REMAX Estate Properties Applicant's Phone (310)936-5875

Email Address phedstrom@gmail.com City Business License 01201243

Obtaining a Real Property Records Report is a requirement prior to sale of home per PVEMC 5.25.030.

FEE: **Effective 9/14/2020, fee is \$156.00** payable upon application. Completed reports are available ten (10) working days after date of application.

NOTICE: The issuance of the Real Property Records is not a warranty or representation by the City that the subject property or its present use is, or is not, in compliance with the law. The City does not represent or warrant that the information contained in the Report will always be complete and /or accurate, and all persons receiving the report should independently verify the information contained therein before relying upon it. The preparation and delivery of this report shall not impose any mandatory duty upon the City to completely and accurately report the information from its records or impose any liability upon the City for any errors or omissions contained in said Report.

(Office Use Only)

APN#7541032023

Lot	Block	Tract	Zone	Occupancy	DWELLING
Building	Date of	Nature of Construction	Permit Status		
Permit #	Issuance				
		<u>6889</u>	<u>R-1</u>		
B-4021	09/18/61	Single family residence			Final 01/18/62
S-1769	08/23/66	House sewer connecting to public sewer			Final 08/26/66
23152	05/30/97	Interior remodel			Final 11/12/97
23219	07/01/97	Interior remodel			Final 10/31/97
29438	08/12/05	Re-roof			Final 10/31/05
19-00665	09/18/19	Sewer cleanout			Final 09/20/19
21-00636	11/29/21	Sewer repair			Final 11/30/21

DEPARTMENT OF BUILDING AND SAFETY
CITY OF PALOS VERDES ESTATES

APPLICATION FOR CERTIFICATE OF COMPLETION

Art Jury Approval

BY

DATE

H. A. No. 4459

Lot 1/2 of 20-21

Block 1431

Tract 6889

Palos Verdes Estates June 11, 1962

I, Mrs. R. A. Cully (Name)

1636 Via Machado (Address)

hereby apply for certificate of completion. I certify the building to be fully completed in all details and in compliance with plans as approved by the Palos Verdes Art Jury, as issued under Building Permit No. _____

Occupancy prior to receiving certificate is a violation of City Ordinance No. 80.

Ready 1-22-62 Hold

Key under rock on front OK _____ (Signed) R. A. Cully

500 SETS 11-58 T-B35

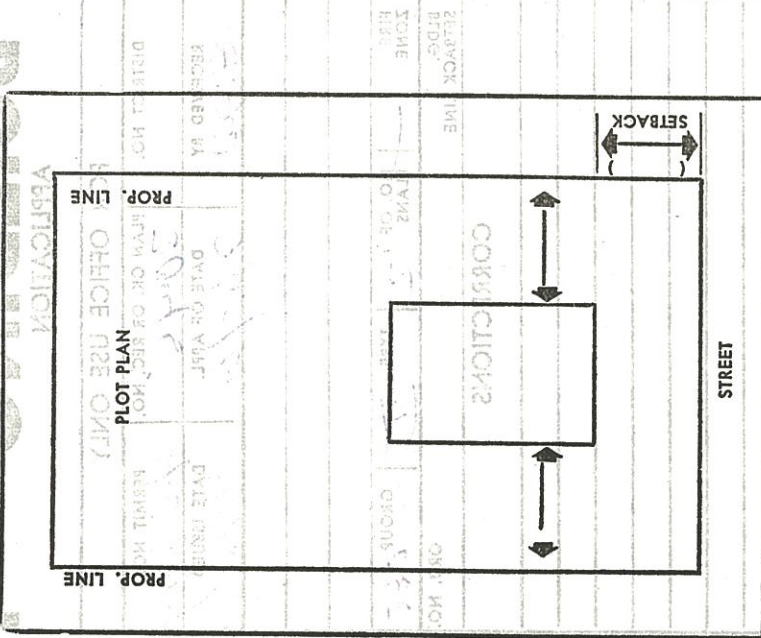

APPROVALS	DATE
INSPECTOR'S SIGNATURE	
PLANNING	
PERMITS	
ENGINEER	
ARCHITECT	
FOUNDATION	
FRAME	
ROOF	
INTERIOR	
MECHANICAL	
ELECTRICAL	
PLUMBING	
PAINT	
FINISH	
NO. SETS	
REMARKS	

REQUIRED INFORMATION

1. INDICATE ALL BUILDINGS ON PROPERTY.
2. INDICATE AND DIMENSION SEWAGE DISPOSAL SYSTEM WITH TIE DISTANCES TO BUILDINGS AND PROPERTY LINES.
3. INDICATE SIZE OF SEPTIC TANK — DEPTH OF SEEPAGE PIT(S) — SIZE OF CESSPOOL(S):
4. INDICATE NORTH DIRECTION ON PLOT.
5. INDICATE BOTH STREETS IF CORNER.

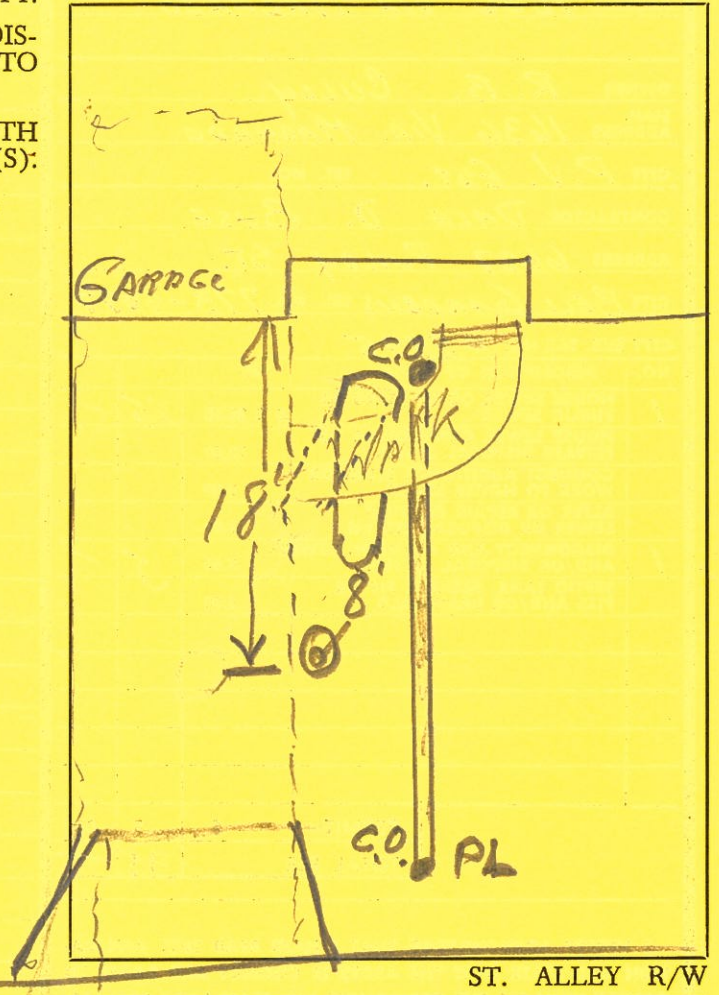

FIELD NOTES

← Via Machado →

**APPLICATION FOR COMBO PERMIT
CITY OF PALOS VERDE ESSTATE**

Permit No: PV9715004/23152
 Parcel No: 7541-032-023
 Site Addr: 1636 VIA MACHADO
 PALOS VERDES EST CA 90274

Issued By: adm Issued On: 05/30/97
 Tract: 06889 Lot: 020 Block: 01481
 Expire On: 11/30/98

-1-

Owner: PETILLON, LEE R AND MARY K
 Address: 1636 VIA MACHADO
 PLS VRDS EST CA 90274

Phone:

Applicant: 34155 - GENE FRANK CONSTRUCTION
 Address: 82 NARCISSA DRIVE
 RANCHO PALOS VERDES CA 90274

Phone: 310-544-0438

Arch/Engr:
 Address:

Reg#:

Phone:

Contractr:
 Address:

Phone:

Com.Improvement Case#	Precise Plan Case#					
PROPOSED WORK - New: N	Add: Alter: Repair: Demolish: Tenant Impr:					
Type Construction...:	Occup. Group: Zoning: R1*					
New Building: N Sq.Ft: 0	#Units: #Stories: 0	#Bedrms: 0	#Bath: 0.00			
Valuation: 1000	Fees Paid: 214.86	Check No.:	Receipt No.:			

Remarks...: Kitchen remodel, bath remodel, relocate laundry approved by
 lgg/dd

[Signature] /Date 5/30/97 *[Signature]* /Date 11/2/97

Permit Approved By
 FEES:

Final Inspection By

QTY/AMT	DESCRIPTION OF WORK (ITEM)	BASE FEE	ITEM FEE	QTY/AMT	DESCRIPTION OF WORK (ITEM)	BASE FEE	ITEM FEE
	B -PLAN REVIEW FEE			68.000	B -ABB-010-TOTAL BUILDING		68.00
1.000	B -ADD-010-PERMIT ISSUE	22.00	22.00		E -ELECTRICAL		
15.360	E -ABB-010-TOTAL ELECTRIC		15.36		M -MECHANICAL PRMT		
11.900	M -ABB-010-TOTAL MECHANIC		11.90		P -PLUMBING		
97.600	P -ABB-010-TOTAL PLUMBING		97.60				

TOTAL FEES\$

214.86

CITY OF PALOS VERDES ESTATES
THIS PERMIT WILL EXPIRE ON THIS DATE:

NOV 30

[Signature]

Building Permits Have a 18 Month Limitation

BUILDING INSPECTIONS RECORD PERMIT# 23152 DATE 5/30/97 ADDRESS 1636 Via Machuca

POST IN A CONSPICUOUS PLACE ON THE JOB SITE/ FOR NEXT DAY INSPECTIONS CALL BEFORE 4:00 P.M. THE DAY BEFORE - AT 791-8400

PLUMBING	DATE	INSPECTION	REMARKS
Ground Soil/Ground Water			
Shower Pan	8/11/97	DD	2
Rough / Top Out	7/23/97	DD	7/18/97 Top-out & only DD
Sewer			
Building Water			
Gas Test	7/30/97	WDD	
Water Heater			
Final Plumbing Inspection			
MECHANICAL			
Underground / Floor			
Rough Mechanical	7/18/97	DD	
Air Conditioner / Heating Unit			
Final Mechanical Inspection			
ELECTRICAL			
Temporary Power Pole			
Underground			
Rough Wiring	7/18/97	DD	
Rough Service / Circuit			
Final Electrical Inspection			
STRUCTURAL			
Foundation Location			
Reinforced Ufer			
Slab: Reinforced Membrane			
Floor Joist / Insulation			
Fireplace			
Masonry Grout			
Roof Framing / Sheathing			
Framing	7/18/97	DD	
Insulation Sound / Energy	7/23/97	DD	
Shower Pan/Lath	8/11/97	DD	
Lath Exterior			
Lath Interior / Gypboard	7/30/97	WDD	
Final Building Inspection			

CITY OF PALOS VERDES ESTATES
 THIS PERMIT WILL EXPIRE ON THIS DATE:
NOV 30 1997
 Building Permits Have a 18 Month Limitation

**APPLICATION FOR BUILDING PERM
CITY OF PALOS VERDE ESSTATE**

Permit No: PV9718202/23219
 Parcel No: 7541-032-023
 Site Addr: 1636 VIA MACHADO
 PALOS VERDES EST CA 90274

Issued By: adm Issued On: 07/01/97
 Tract: 06889 Lot: 020 Block: 01481
 Expire On: 01/01/99

-1-

Owner: PETILLON, LEE R AND MARY K
 Address: 1636 VIA MACHADO
 PLS VRDS EST CA 90274

Phone:

Applicant: 34155 - GENE FRANK CONSTRUCTION.
 Address: 82 NARCISSA DRIVE
 RANCHO PALOS VERDES CA 90274

Phone: 310-544-0438

Arch/Engr:
 Address:

Reg#:

Phone:

Contractr:
 Address:

Phone:

Com.Improvement Case# Precise Plan Case#
 PROPOSED WORK - New: N Add: Alter: Repair: Demolish: Tenant Impr:
 Type Construction.: Occup. Group: Zoning: R1*
 New Building: N Sq.Ft: 156 #Units: #Stories: 0 #Bedrms: 0 #Bath: 0.00
 Valuation: 17628 Fees Paid: 446.00 Check No.: Receipt No.:

Remarks.: 156 sq ft remodel for kitchen and master bathroom approved
 by lcg/bpz

Permit Approved By [Signature] /Date 7/1/97 Final Inspection By [Signature] /Date 10/31/97

FEES:

QTY/AMT	DESCRIPTION OF WORK (ITEM)	BASE FEE	ITEM FEE	QTY/AMT	DESCRIPTION OF WORK (ITEM)	BASE FEE	ITEM FEE
1.000	B -PLAN REVIEW FEE			424.000	B -ABB-010-TOTAL BUILDING		424.00
	B -ADD-010-PERMIT ISSUE	22.00	22.00				

TOTAL FEES\$ 446.00

**CITY OF PALOS VERDES ESTATES
 THIS PERMIT WILL EXPIRE ON THIS DATE:
 JAN 1 1999
 Building Permits Have a 18 Month Limitation**

FINAL SIGNATURE FROM BUILDING OFFICIAL DENOTES CERTIFICATE OF USE &
 OCCUPANCY. CITY PHONE #S (310) 378-0383 OR INSPECTION REQUEST LINE
 (310) 791-8400

BUILDING INSPECTIONS RECORD PERMIT# 23219 DATE 7/1/97 ADDRESS 1626 Vic Olachado

POST IN A CONSPICUOUS PLACE ON THE JOB SITE/ FOR NEXT DAY INSPECTIONS CALL BEFORE 4:00 P.M. THE DAY BEFORE - AT 791-8400

PLUMBING	DATE	INSPECTION	REMARKS
Ground Soil/Ground Water			
Shower Pan	<u>8/11/97</u>	<u>DD</u>	
Rough / Top Out	<u>7/23/97</u>	<u>DD</u>	<u>7/18/97 Top-out only DD</u>
Sewer			
Building Water			
Gas Test			
Water Heater			
Final Plumbing Inspection			
MECHANICAL			
Underground / Floor			
Rough Mechanical	<u>7/18/97</u>	<u>DD</u>	
Air Conditioner / Heating Unit			
Final Mechanical Inspection			
ELECTRICAL			
Temporary Power Pole			
Underground			
Rough Wiring	<u>7/18/97</u>	<u>DD</u>	
Rough Service / Circuit			
Final Electrical Inspection			
STRUCTURAL			
Foundation Location			<u>Pad f# 2' sq x 12" dp 7/18/97</u>
Reinforced Ufer			
Slab: Reinforced Membrane			
Floor Joist / Insulation			
Fireplace			
Masonry Grout			
Roof Framing / Sheathing	<u>7/18/97</u>	<u>DD</u>	
Framing	<u>7/23/97</u>	<u>DD</u>	
Insulation Sound / Energy			
Shower Pan/Lath	<u>8/11/97</u>	<u>DD</u>	
Lath Exterior	<u>8/11/97</u>	<u>DD</u>	
Lath Interior / Gypboard	<u>7/30/97</u>	<u>DD</u>	
Final Building Inspection			

CITY OF PALOS VERDES ESTATES
 THIS PERMIT WILL EXPIRE ON THIS DATE:
JAN 1 1999
 Building Permits Have a 18 Month Limitation



City of Palos Verdes Estates

Building and Safety
340 Palos Verdes Drive West
Palos Verdes Estates, CA 90274
(310) 378-0383 Fax (310) 378-7820

APPLICATION FOR BUILDING PERMIT AND CERTIFICATE OF OCCUPANCY

Inspection request line 310-791-8400

Building Address St No. <u>01636</u> Street <u>VIA MACHADO</u> APN <u>7541032023</u> Lot <u>020</u> Tract <u>7112</u> Block <u>01481</u>	Permit Number <p style="text-align: center;">29438</p>	Plan Review No.:																										
The following work is authorized by this permit <input type="checkbox"/> Struct. <input type="checkbox"/> Plumb. <input type="checkbox"/> Mech. <input type="checkbox"/> Elect.																												
Type of Project <input type="checkbox"/> New <input type="checkbox"/> Alter <input type="checkbox"/> Addition <input checked="" type="checkbox"/> Repair <input type="checkbox"/> Tenant Improvement <input type="checkbox"/> Demo <input type="checkbox"/> Occupancy Permit																												
Applicant <u>J. Taylor Roofing Inc.</u> St No. _____ Street <u>P.O. Box 4050</u> City <u>Torrance Ca</u> Zip _____ Phone <u>310-378-7733</u> Engr/Arch _____ Lic No. _____	<table border="1" style="width:100%; border-collapse: collapse;"> <thead> <tr> <th style="width:70%;">Project Description</th> <th style="width:15%;">Location on Property</th> <th style="width:15%;">Size in Sq. Feet</th> </tr> </thead> <tbody> <tr> <td>1. <u>Re-Roof</u></td> <td><u>other</u></td> <td><u>3000</u></td> </tr> <tr> <td>2. _____</td> <td>_____</td> <td>_____</td> </tr> <tr> <td>3. _____</td> <td>_____</td> <td>_____</td> </tr> </tbody> </table>		Project Description	Location on Property	Size in Sq. Feet	1. <u>Re-Roof</u>	<u>other</u>	<u>3000</u>	2. _____	_____	_____	3. _____	_____	_____														
Project Description	Location on Property	Size in Sq. Feet																										
1. <u>Re-Roof</u>	<u>other</u>	<u>3000</u>																										
2. _____	_____	_____																										
3. _____	_____	_____																										
Owners name <u>Petillon</u> Telephone <u>378-1852</u>	<p style="text-align: center;">Business Lic No</p>																											
Contractor <u>J. Taylor Roofing Inc.</u> Lic No. <u>399009</u> <u>P.O. Box 4050</u> <u>Torrance Ca 90510</u> Licensed Contractor's Declaration I hereby affirm that I am licensed under the provisions of Chapter 9 (commencing with Section 7000 of Division 3 of the Business and Professions Code) and my license is in full force and effect. License Class <u>C-39</u> License Number <u>399009</u> Date <u>8/12/2005</u> Contractor <u>J. Taylor Roofing Inc.</u> Address <u>P.O. Box 4050</u> City and Zip <u>Torrance CA 90510</u> Phone <u>310-378-7733</u>	Remarks/Special Conditions/Project Description <u>replace like for like (shake)</u> <u>CAP SEET INSPECTION</u>																											
Construction Lending Agency I hereby affirm that there is a construction lending agency for the performance of the work for which this permit is issued (Sec. 1097, Civ..C) Lender's Name _____ Lender's Address _____	<div style="border: 2px solid red; padding: 10px; text-align: center; color: red;"> <p>City of Palos Verdes Estates This permit will expire on the following date: <div style="border: 1px solid red; padding: 5px; margin: 5px 0;"> <p style="font-size: 1.2em;">FEB 12 2007</p> </div> Building permits have an 18 month limitation, unless otherwise described in Section 15.16.940</p> </div>																											
Owner-Builder Declaration I hereby affirm that I am exempt from the Contractor's License Law for the following reason [Sec.7031.5, Business and Professions Code: Any city or county which requires a permit to construct, alter, improve, demolish, or repair any structure, prior to its issuance, also requires the applicant for such permit to file a signed statement that he is licensed pursuant to the provisions of the contractor's License Law(Chapter 9, commencing with Section 7000, of Division 3 of the Business and Professions Code) or that he is exempt therefrom, and the basis for the alleged exemption. Any violation of section 7031.5 by any applicant for a permit subjects the applicant to a civil penalty of not more than five <input type="checkbox"/> I, as owner of the property, or my employees with wages as their sole compensation, will do the work, and the structure is not intended or offered for sale (Sec. 7044, Business and Professions Code: The Contractor's Licensed Law does not apply to an owner of property who builds or improves thereon, and who does such work himself or through his own employees, provided that such improvements are not intended or offered for sale. If, however, the building or improvement is sold within one year of completion, the owner-builder will have the burden of proving that he did not build or improve the purpose of sale.) <input type="checkbox"/> I, as owner of the property, am exclusively contracting with licensed contractors to construct the project(Sec.7044, Business and Professions Code The Contractor's License Law does not apply to an owner of property who builds or improves thereon, and contracts for such projects with contractor(s) licensed pursuant to the contractor's License Law). I am exempt under Sec. _____, B&PC for this reason Date _____ Initial _____	Finaled Date: <u>10-31-05</u> Inspector: <u>Jon</u> <p style="text-align: center;">All work shall conform to the 2001 C.B.C., 2001 C.M.C., 2001 C.P.C. and the 1999 N.E.C.</p>																											
Workers' Compensation Declaration <input type="checkbox"/> I hereby affirm under penalty of perjury one of the following declarations: a. I have and will maintain a certificate of consent to self-insure for workers' compensation as provided by Section 3700 of the Labor Code, for the performance of the work for which this permit is issued. <input checked="" type="checkbox"/> b. I have and will maintain worker's compensation, as required by Section 3700 of the Labor Code, for the performance of the work for which this permit is issued. My worker's compensation insurance carrier and policy number are: Ins. Co.: <u>STATE FUND</u> Policy No: <u>11416-2005</u> Exp Date: <u>1-1-06</u>	<table border="1" style="width:100%; border-collapse: collapse;"> <tr> <td style="width:50%;">Group/Division/Type</td> <td style="width:50%;"></td> </tr> <tr> <td>7500</td> <td style="text-align: right;">Lot sqft 56593</td> </tr> <tr> <td>Valuation</td> <td style="text-align: right;">House sqft 1984</td> </tr> <tr> <td>Structural</td> <td style="text-align: right;">\$246.00</td> </tr> <tr> <td>Elect</td> <td></td> </tr> <tr> <td>Mech</td> <td></td> </tr> <tr> <td>Plumb</td> <td></td> </tr> <tr> <td>Plan check</td> <td></td> </tr> <tr> <td>Issuance</td> <td style="text-align: right;">\$25.00</td> </tr> <tr> <td>Grading</td> <td></td> </tr> <tr> <td>Soils/Geology</td> <td></td> </tr> <tr> <td>Total City Fee Due</td> <td style="text-align: right;">\$271.00</td> </tr> <tr> <td>Total Amount Paid</td> <td style="text-align: right;">\$271.00</td> </tr> </table>		Group/Division/Type		7500	Lot sqft 56593	Valuation	House sqft 1984	Structural	\$246.00	Elect		Mech		Plumb		Plan check		Issuance	\$25.00	Grading		Soils/Geology		Total City Fee Due	\$271.00	Total Amount Paid	\$271.00
Group/Division/Type																												
7500	Lot sqft 56593																											
Valuation	House sqft 1984																											
Structural	\$246.00																											
Elect																												
Mech																												
Plumb																												
Plan check																												
Issuance	\$25.00																											
Grading																												
Soils/Geology																												
Total City Fee Due	\$271.00																											
Total Amount Paid	\$271.00																											
<input type="checkbox"/> (This section need not be completed if the permit is for one hundred dollars (\$100) or less). c. I certify that in the performance of the work for which this permit is issued, I shall not employ any person in any manner so as to become subject to the Workers' Compensation Laws of California and agree that if I should become subject to the workers' compensation provisions of Section 3700 of the Labor Code, I shall forthwith comply with those provisions. Date _____ Signature _____ Warning: Failure to secure workers' compensation coverage is unlawful, and shall subject an employer to criminal penalties and civil fines up to one hundred thousand dollars (\$100,000), in addition to the cost of compensation, damages as provided for in Section 3706 of the Labor Code, interest, and attorney's fees.	Issuance Approved <u>Mike Ross</u>																											
I certify that I have read this application and state that the above information is correct, and that I am the owner or the duly authorized agent of the owner. I agree to comply with all city and state laws relating to building construction. I hereby authorize representatives of the City of Palos Verdes Estates to enter upon the above mentioned property for inspection purposes. <u>[Signature]</u> Signature of Applicant or Agent <u>ROD TAYLOR</u> Print Applicant's/Agent's Name <u>8-12-05</u> Date	Date Issued <u>Fri, Aug 12, 2005</u> Permit Number <u>29438</u>																											
Check # <u>20418</u> <input type="checkbox"/> Cash																												

**POST THIS INSPECTIONS RECORD IN A CONSPICUOUS PLACE ON THE JOB SITE - FOR
NEXT DAY INSPECTION CALL BEFORE 4:00 P.M. THE DAY BEFORE @ 791-8400 OR CALL
CITY OFFICES AT 378-0383**

DATE:	PERMIT #	ADDRESS:		
		DATE	INSPECTOR	REMARKS/NOTES
PLUMBING				
Ground Soil/Ground Water				
Shower Pan				
Rough/Top Out				
Sewer				
Building Water				
Gas Test				
Water heater				
Final Plumbing Inspection				
MECHANICAL				
Underground / Floor				
Rough Mechanical				
Air Conditioner/Heating Unit				
Final Mechanical Inspection				
ELECTRICAL				
Temporary Power Pole				
Underground				
Rough Wiring				
Rough Service/Circuit				
Final Electrical Inspection				
GRADING				
Pre-Grade Meeting				
Toe of Fill				
Excavation				
Drainage Devices				
Rough grading & Building release				
Retaining wall footing				
Block wall footing				
Grout lift #1				
Grout lift #2				
Grout lift #3				
Final Grading Inspection				
SWIMMING POOL/SPA				
Location/Dig				
Steel Bonding/Plumbing Test				
Approved gunite				
P" Trap				
Gas test				
Underground electric				
Fence enclosure				
Final Pool/Spa Inspection				
STRUCTURAL				
Foundation Location				
Reinforced Ufer				
Slab: Reinforced Membrane				
Floor Joist / Insulation				
Fireplace				
Masonry Grout				
Roof framing / Sheathing				
Framing				
Insulation Sound / Energy				
Shower Pan / Lath				
Lath exterior				
Lath interior / Gypboard				
Final Building Inspection				

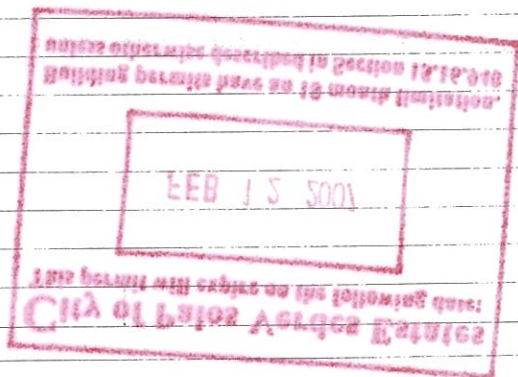

CapSheet 8-16-05 RLR

FINAL SIGNATURE FROM BUILDING OFFICIAL DENOTES CERTIFICATE OF USE & OCCUPANCY.



CITY OF PALOS VERDES ESTATES
BUILDING AND SAFETY

APPLICATION FOR BUILDING PERMIT

340 PALOS VERDES DR WEST
PALOS VERDES ESTATES, CA 90274 310-378-0383
http://www.pvestates.org
INSPECTION REQUEST LINE: 310-791-8400 By: 4PM

PERMIT NUMBER: 19-00665
ISSUED DATE: 09/18/2019
EXPIRATION DATE: 03/18/2021

PARCEL NUMBER: 7541-032-023 LOT SIZE:
LEGAL DESCRIPTION:

1636 VIA MACHADO
PLUMBING PERMIT

ONLINE ACCESS CODE: 6NXS3-5H5OP

PROJECT: SEWER CLEAN OUT ON PRIVATE PROPERTY

	<u>NAME</u>	<u>ADDRESS</u>	<u>PHONE</u>
APPLICANT:	PETILLON, LEE RITCHEY	1636 VIA MACHADO PALOS VERDES ESTATES, CA 90274	310-838-0408 x. 2140
OWNER:	PETILLON, LEE RITCHEY	1636 VIA MACHADO PALOS VERDES ESTATES, CA 90274	310-838-0408 x. 2140

FEE SUMMARY:

Permit Issuance Fee	\$41.00
Plumbing Fixture Fee	\$22.00
TOTAL FEES PAID:	\$63.00
Check Payment	34269

The above-referenced paid fees may not include all applicable fees for your project. Any and all outstanding fees must be paid in full prior to obtaining a final inspection.

9/26/19 ERIC MUSE FINAL

A violation of any local, state or federal regulation, statute, code, standard, or policy at this location will constitute a violation of permit conditions and will be subject to STOP WORK ORDER, INSPECTION HOLD, CERTIFICATE OF OCCUPANCY HOLD, NO OCCUPANCY NOTICE OR CEASE AND DESIST ORDER until such time as the violation(s) is corrected.

I certify that I have read this application and state that the above information is correct, and that I am the owner or the duly authorized agent of the owner. I agree to comply with all city and state laws relating to building construction. I hereby authorize representatives of the City of Palos Verdes Estates to enter upon the above mentioned property for inspection purposes.

SIGNATURE OF OWNER OR AGENT: _____ DATE: _____

PRINTED NAME: _____

ISSUED BY: Donna Shellabarger DATE ISSUED: 09/18/2019



CITY OF PALOS VERDES ESTATES
BUILDING AND SAFETY

APPLICATION FOR BUILDING PERMIT

340 PALOS VERDES DR WEST
PALOS VERDES ESTATES, CA 90274 310-378-0383
http://www.pvestates.org
INSPECTION REQUEST LINE: 310-791-8400 By: 4PM

PERMIT NUMBER: 21-00636
ISSUED DATE: 11/29/2021
EXPIRATION DATE: 05/29/2023

PARCEL NUMBER: 7541-032-023 LOT SIZE:
LEGAL DESCRIPTION:

1636 VIA MACHADO
ALTERATION/REPAIR - RESIDENTIAL

ONLINE ACCESS CODE: QVIXK-JGZ4J

PROJECT: SPOT REPAIR WITH 4" CLEAN OUT ON PRIVATE
PROPERTY - NOT INTERSECTING ON PROW

	<u>NAME</u>	<u>ADDRESS</u>	<u>PHONE</u>
APPLICANT:	DRAIN RIGHT SERVICES	1891 TARRASA DR.N. GAFFEY #R SAN PEDRO, CA 90731	310-919-7851
OWNER:	PETILLON, LEE RITCHEY & MARY	1636 VIA MACHADO PALOS VERDES ESTATES, CA 90274	310-838-0408 x. 2140
CONTRACTOR:	DRAIN RIGHT SERVICES	1891 TARRASA DR.N. GAFFEY #R SAN PEDRO, CA 90731	310-919-7851
	LIC: 852708	EXP:	

FEE SUMMARY:

Permit Issuance Fee	\$42.00
Plumbing Fixture Fee	\$76.00
TOTAL FEES PAID:	\$118.00
Check Payment	7869

11/30/21
FINAL

The above-referenced paid fees may not include all applicable fees for your project. Any and all outstanding fees must be paid in full prior to obtaining a final inspection.

A violation of any local, state or federal regulation, statute, code, standard, or policy at this location will constitute a violation of permit conditions and will be subject to STOP WORK ORDER, INSPECTION HOLD, CERTIFICATE OF OCCUPANCY HOLD, NO OCCUPANCY NOTICE OR CEASE AND DESIST ORDER until such time as the violation(s) is corrected.

I certify that I have read this application and state that the above information is correct, and that I am the owner or the duly authorized agent of the owner. I agree to comply with all city and state laws relating to building construction. I hereby authorize representatives of the City of Palos Verdes Estates to enter upon the above mentioned property for inspection purposes.

SIGNATURE OF OWNER OR AGENT: DATE: 11/29/21

PRINTED NAME: Andy Cruz

ISSUED BY: Kimberly Bernal DATE ISSUED: 11/29/2021