

Building Sketch

Borrower/Client				
Property Address 11325 Culver Dr				
City	Culver City	County	Los Angeles	State CA Zip Code 90230
Lender				

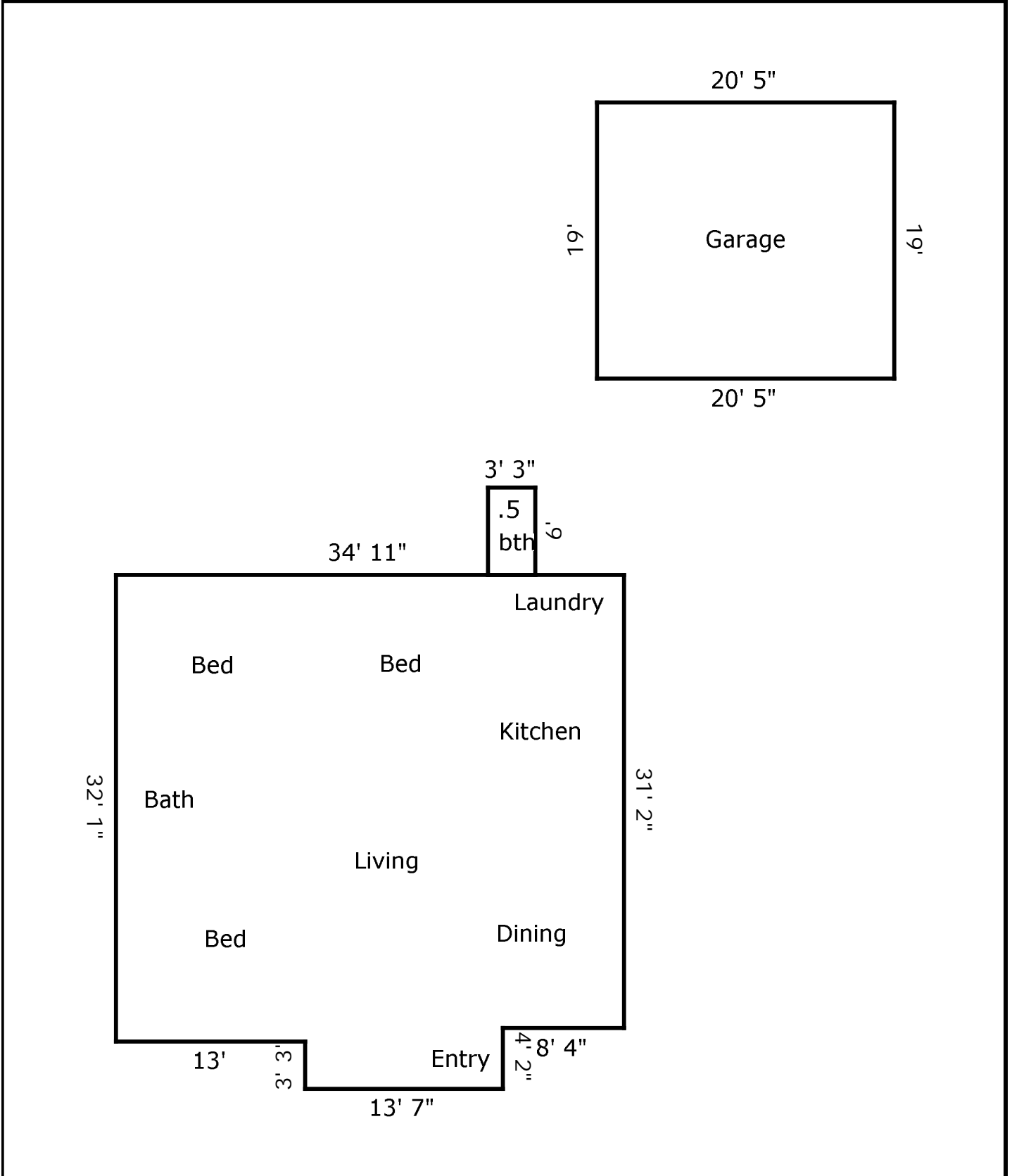

TOTAL Sketch by a la mode

Area Calculations Summary

Living Area	Calculation Details	
First Floor	1156.75 Sq ft	$31.17 \times 8.33 = 259.72$ $35.33 \times 13.58 = 479.94$ $32.08 \times 13 = 417.08$
Total Living Area (Rounded):	1157 Sq ft	
Non-living Area		
Exterior Half Bath	19.5 Sq ft	$3.25 \times 6 = 19.5$
Garage	387.92 Sq ft	$19 \times 20.42 = 387.92$