

Find a homesite you'll love

Dawn at Solis Park

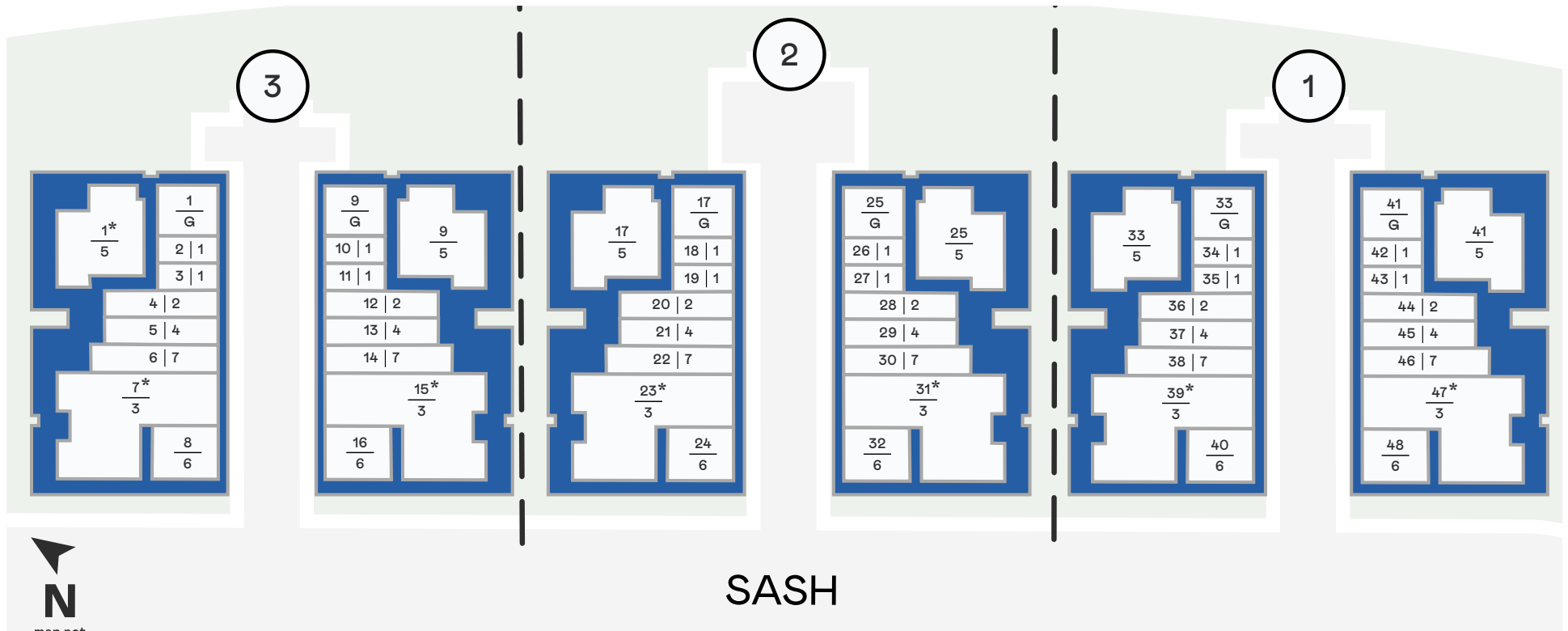

- 00 PHASE NUMBER
- * = ADA HOMESITE
- $\frac{28}{3}$ = HOMESITE NUMBER
= PLAN NUMBER
- $\frac{73}{G}$ = HOMESITE NUMBER
= GARAGE



LENNAR

Dawn by Lennar
Solis Park in Great Park Neighborhoods
949-234-7886 | Lennar.com

Siteplans are conceptual in nature and are merely an artist's rendition. They are solely for illustrative purposes, should never be relied upon, and are subject to change. This is not an offer in states where prior registration is required. Void where prohibited by law. Copyright © 2021 Lennar Corporation. Lennar and the Lennar logo are U.S. registered service marks or service marks of Lennar Corporation and/or its subsidiaries. CalAtlantic Group, Inc., CA DRE Broker #02058246 (Responsible Broker: Joanna Duke). Lennar Sales Corp., CA DRE Broker #01252753 (Responsible Broker: Joanna Duke). Ryland Homes of California, Inc., CA DRE Broker #00352900 (Responsible Broker: John Patrick Higgins). BMR Construction, Inc., CA CSLB #830955. CalAtlantic Group, Inc., CA CSLB #1037780. Lennar Homes of California, Inc., CA CSLB #728102. Date 04/21



Find a homesite you'll love

Dawn at Solis Park

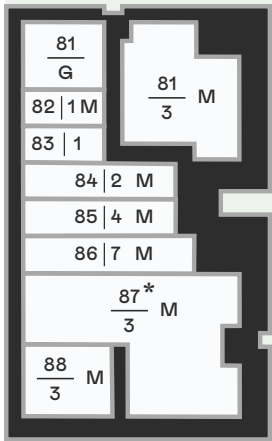

BIOME

- MODELS
- 00 PHASE NUMBER
- * = ADA HOMESITE
- $\frac{28}{3}$ = HOMESITE NUMBER
= PLAN NUMBER
- $\frac{73}{G}$ = HOMESITE NUMBER
= GARAGE



Dawn by Lennar
Solis Park in Great Park Neighborhoods
949-234-7886 | Lennar.com

LENNAR

Siteplans are conceptual in nature and are merely an artist's rendition. They are solely for illustrative purposes, should never be relied upon, and are subject to change. This is not an offer in states where prior registration is required. Void where prohibited by law. Copyright © 2021 Lennar Corporation. Lennar and the Lennar logo are U.S. registered service marks or service marks of Lennar Corporation and/or its subsidiaries. CalAtlantic Group, Inc., CA DRE Broker #02058246 (Responsible Broker: Joanna Duke). Lennar Sales Corp., CA DRE Broker #01252753 (Responsible Broker: Joanna Duke). Ryland Homes of California, Inc., CA DRE Broker #00352900 (Responsible Broker: John Patrick Higgins). BMR Construction, Inc., CA CSLB #830955. CalAtlantic Group, Inc., CA CSLB #1037780. Lennar Homes of California, Inc., CA CSLB #728102. Date 04/21



Find a homesite you'll love

Cascade at Solis Park

- 00 PHASE NUMBER
- * = ADA HOMESITE
- 14
10BR BUILDING NUMBER | ELEVATION
- 28 = HOMESITE NUMBER
- 1B = PLAN NUMBER & ELEVATION

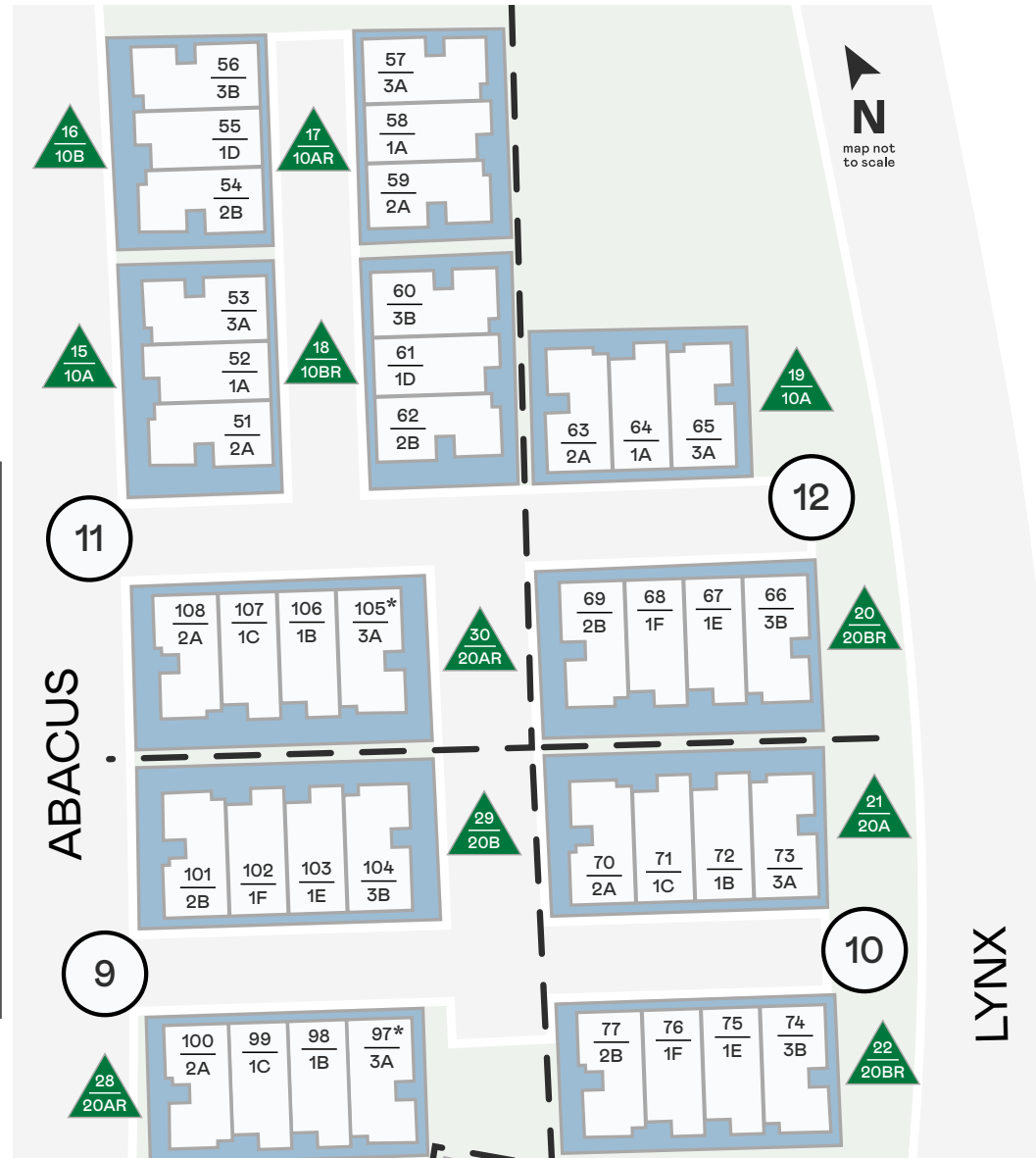

Cascade by Lennar
 Solis Park in Great Park Neighborhoods
 949-234-7886 | Lennar.com



Siteplans are conceptual in nature and are merely an artist's rendition. They are solely for illustrative purposes, should never be relied upon, and are subject to change. This is not an offer in states where prior registration is required. Void where prohibited by law. Copyright © 2021 Lennar Corporation. Lennar and the Lennar logo are U.S. registered service marks or service marks of Lennar Corporation and/or its subsidiaries. CalAtlantic Group, Inc., CA DRE Broker #02058246 (Responsible Broker: Joanna Duke). Lennar Sales Corp., CA DRE Broker #01252753 (Responsible Broker: Joanna Duke). Ryland Homes of California, Inc., CA DRE Broker #00352900 (Responsible Broker: John Patrick Higgins). BMR Construction, Inc., CA CSLB #830955. CalAtlantic Group, Inc., CA CSLB #1037780. Lennar Homes of California, Inc., CA CSLB #728102. Date 04/21

