

**QUADRUPLICATE**  
Use to comply with  
local requirements

STATE OF CALIFORNIA  
THE RESOURCES AGENCY  
DEPARTMENT OF WATER RESOURCES  
**WATER WELL DRILLERS REPORT**

Do not fill in

No. **302847**

Notice of Intent No. \_\_\_\_\_  
Local Permit No. or Date \_\_\_\_\_

State Well No. \_\_\_\_\_  
Other Well No. \_\_\_\_\_

(1) OWNER: Name \_\_\_\_\_  
Address \_\_\_\_\_  
City \_\_\_\_\_ ZIP **95965**

(2) LOCATION OF WELL (See instructions):  
County **Butte** Owner's Well Number **027-270-018**  
Well address if different from above **Same** **014**  
Township **T-18-N** Range **R-4-E** Section **16**  
Distance from cities, roads, railroads, fences, etc. **1 1/2 miles east**  
**off palermo honcutt rd. and approx. 400'**  
**north east.**

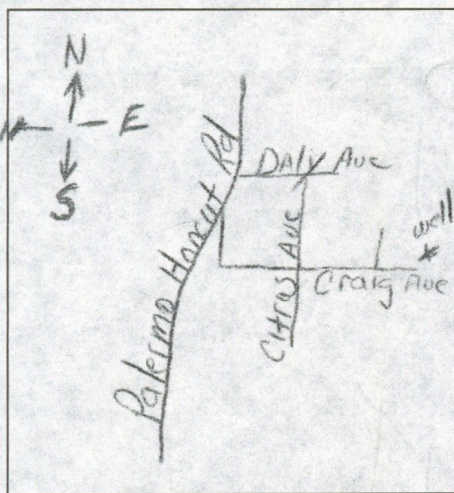

(3) TYPE OF WORK:  
New Well  Deepening   
Reconstruction   
Reconditioning   
Horizontal Well   
Destruction  (Describe destruction materials and procedures in Item 12)

(4) PROPOSED USE:  
Domestic   
Irrigation   
Industrial   
Test Well   
Municipal   
Other  (Describe)

(12) WELL LOG: Total depth \_\_\_\_\_ ft. Completed depth \_\_\_\_\_ ft.

from ft.	to ft.	Formation (Describe by color, character, size or material)
0'	2'	Red Clay Cobble stone
2'	18'	Brown clay cobble stone
18'	22'	Soft green & white mixture
22'	44'	Light grey mixture
44'	46'	Blue, green & white mixture
46'	49'	blue, green, white & brown clay
49'	53'	blue, green, white clay
53'	90'	solid blue clay
90'	91'	solid blue quartz
91'	97'	solid blue rock
97'	98'	soft blue rock
98'	141'	solid blue fock-some water
141'	142'	brown, blue & white clay
142'	189'	solid blue rock
189'	195'	soft blue, green & white clay
195'	220'	solid blue clay
220'	229'	solid blue white & brown granite
229'	252'	solid blue & white granite
252'	276'	solid blue & brown granite
276'	278'	soft blue & green mix
278'	300'	solid blue rock

WELL LOCATION SKETCH

(5) EQUIPMENT:  
Rotary  Reverse   
Cable  Air   
Other  Bucket

(6) GRAVEL PACK:  
Yes  No  Size \_\_\_\_\_  
Diameter of bore \_\_\_\_\_  
Packed from \_\_\_\_\_ to \_\_\_\_\_ ft.

(7) CASING INSTALLED:  
Steel  Plastic  Concrete

From ft.	To ft.	Dia. in.	Gage or Wall
0'	20'	6"	
0'	300'	4"	

(8) PERFORATIONS:  
Type of perforation or size of screen \_\_\_\_\_

From ft.	To ft.	Slot size
300'	200'	4"

(9) WELL SEAL:  
Was surface sanitary seal provided? Yes  No  If yes, to depth **20** ft.  
Were strata sealed against pollution? Yes  No  Interval \_\_\_\_\_ ft.  
Method of sealing **Cement & little Bentonite**

(10) WATER LEVELS:  
Depth of first water, if known **63 Feet** ft.  
Standing level after well completion **approx 63 Feet** ft.

(11) WELL TESTS:  
Was well test made? Yes  No  If yes, by whom? **Driller**  
Type of test Pump  60 Bailer  Air lift   
Depth to water at start of test \_\_\_\_\_ ft. At end of test \_\_\_\_\_ ft.  
Discharge **1/2** gal/min after **2** hours Water temperature \_\_\_\_\_  
Chemical analysis made? Yes  No  If yes, by whom? \_\_\_\_\_  
Was electric log made Yes  No  If yes, attach copy to this report

Environmental Health  
JAN 22 1991  
Oroville, California  
Work started **12-12** 19 **90** Completed **12-13-** 19 **90**

WELL DRILLER'S STATEMENT:  
This well was drilled under my jurisdiction and this report is true to the best of my knowledge and belief.  
Signed **David & Son Drilling Co.** (Well Driller)  
NAME **David & Son Drilling Co.**  
Address **P.O. Box 1019** (Person, firm, or corporation) (Typed or printed)  
City **Oroville** ZIP **95965**  
City **Oroville** ZIP **95965**  
License No. **425609** Date of this report **12-14-90**