

# STANDARD NOTICE OF WORK COMPLETED AND NOT COMPLETED

NOTICE - All recommendations may not have been completed - See below - Recommendations not completed.  
This form is prescribed by the Structural Pest Control Board.

Building No. 2525	Street Highcliff Dr	City Torrance	ZIP 90505	Date of Completion 12/08/2022
----------------------	------------------------	------------------	--------------	----------------------------------



**Y's Pest Control**  
 P.O.Box 150  
 Harbor City CA 90710  
 (424) 571-0528 (310) 617-2166  
 yspestcontrol@gmail.com

Report # : 10143 - 1  
 Registration # : PR7983  
 Escrow # :  
 CORRECTED REPORT

Ordered By: Steve Tanaka 2525 Highcliff Dr Torrance CA 90505 United States	Property Owner and/or Party of Interest: Steve Tanaka 2525 Highcliff Dr Torrance CA 90505 United States	Completion Sent To:
--	---	---------------------

The following recommendations on the above designated property, as outlined in Wood Destroying Pests and Organisms Inspection Report dated 10/19/2022 have been and/or have not been completed.

Recommendations completed by this firm that are in accordance with the Structural Pest Control Board's Rules and Regulations:  
 2A, 2B

Recommendations completed by this firm that are considered secondary and substandard measures under Section 1992 of the Structural Pest Control Board's Rules and Regulations including person requesting secondary measure:  
 2E(Secondary)

Cost of work completed:

Cost: \$	2,690.00
Inspection Fee: \$	0.00
Other: \$	0.00
Total: \$	2,690.00

Recommendations not completed by this firm:

Estimated Cost: \$ \_\_\_\_\_

Remarks:  
 This is to certify that the above property is now free of evidence of active infestations and infections in the visible and accessible areas and is in compliance with the Structural Pest Control Act.

Inspected By: Yusuke Sakuma State License No. FR:46005 Signature:

You are entitled to obtain copies of all reports and completion notices on this property reported to the Board during the preceding two years upon payment of a search fee to: Structural Pest Control Board, 2005 Evergreen Street, Suite 1500, Sacramento, California, 95815.  
 NOTE: Questions or problems concerning the above report should be directed to the manager of this company. Unresolved questions or problems with services performed may be directed to the Structural Pest Control Board at (916) 561-8708, (800) 737-8188 or www.pestboard.ca.gov. 43M-44 (Rev.10/01)

# **CERTIFICATION NOTICE**

**This is to certify that the property located at:**

**2525 Highcliff Dr Torrance**

**Was fumigated 11/21/2022 – 11/23/2022**

**For the extermination of: Drywood Termites**

**Confirmation Order: 73954**

**Licensee – Adrian Valtierra  
License No. FR 53047**

**Quality Pest Services  
261 E 157th St  
Gardena, CA 90248  
(424)266-9421**

OK

# QPS Job Card

Conf # 73954

Address: 2525 Highcliff Dr Torrance UP: Mon 11/21/22

Structure: House + attached Garage VENT: Tue 11/22/22

Prime Contractor: Y's Pest Control DOWN/CERT: Wed 11/23/22

Size: 27,000 # of Bldgs: 1 # of Units: 1 MAP PAGE:

Key and Paperwork: Lockbox: 0725 N) attached

Roof Type: Comp Roof Release  Tile Insurance  Occupied  Raised

Plants Cleared 6"-8"  Plant Release  Neighbor Release  Electricity  Water  Slab

Owner: steve (424)375-1273 Target Pest: Drywood Termites

Tenant: Fumigant: Sulfuryl Fluoride: Vikane

Agent: Seal: Full Tarp

Emergency Phone: Other Phone: Re Do

Prime's QPS Measure  
Instructions

Vent 1/10

**Must Do Prior:** all plants, hedges, & vines close to structure must be trimmed back & removed prior to fume/ vine plants at block wall & arbor at neighbors side must be trimmed back & peeled away prior to fume or will be covered & damaged- 2521 neighbor release & neighbor plant release needed/

**\*\*Notes:** per prime pergola and wooden deck attached to the neighbors fence were removed

Special Instructions



Licensee Put Up: [Signature]  
Signatures Take Down: \_\_\_\_\_  
Certification: [Signature]

**Tile Count** Before NIA  
After \_\_\_\_\_

Notes: \_\_\_\_\_

Key returned to: LB Tag Posted in: Attic One Hour Aeration Started: \_\_\_\_\_

# STANDARD STRUCTURAL FUMIGATION LOG

ADDRESS OF PROPERTY <b>2525 Highcliff Dr</b>		CITY Torrance 90505-	DATE OF FUMIGATION 11/21/2022 11/22/2022 11/23/2022	
BRANCH CO. AND ADDRESS (SUBCONTRACTOR) Quality Pest Services, Inc. 2545 W. Via Palma Anahelm, CA 92801-		PRIME CONTRACTOR NAME AND ADDRESS Y's Pest Control PO BOX 150 Harbor City, CA 90710-		CO. REG. # 7983
OWNER/AGENT NAME AND ADDRESS Owner: steve (424)375-1273 Phone:		Agent: Tenant:	FIRE DEPT. NOTIFIED (DATE/HOUR) <b>FAXED NOV 18 2022</b> T.F.D. 11:31am	
PROPERTY DESCRIPTION House + attached Garage		Roof Type: Comp	Foundation: Slab <input checked="" type="checkbox"/>	Raised <input checked="" type="checkbox"/>
C.A.C. NOTIFIED (METHOD/DATE/HOUR) <b>FAXED NOV 18 2022</b> L.A.C.A.D. 11:26am				
NOTES OR COMMENTS per prime pergola and wooden deck attached to the neighbors fence were removed				
SECTION 1	TARGET PEST	WARNING AGENT	CUBIC FEET	OUNCES USED
FUMIGANT RELEASED	Drywood Termites	Chloropicrin	27,000	125
FUMIGANT / E.P.A. REGISTRATION NO. Sulfuryl Fluoride: Vikane® 1015-78		SEALING METHOD Full Tarp	DATE/TIME GAS INTRODUCED 11/21/22	3:10pm
WIND M.P.H. 4	AIR TEMP 75	CYLINDER SERIAL NO. 704464	WT. BEFORE INTRO. 147	POUNDS APPLIED 18
POLICE DEPT. NOTIFIED (DATE & HOUR)		CYLINDER SERIAL NO.	WT. BEFORE INTRO.	POUNDS APPLIED
EXTRAORDINARY PRECAUTIONS D.S.K.S.L			TOTAL POUNDS	18
<input type="checkbox"/> FUMIGUIDE B <input type="checkbox"/> FUMIGUIDE Y <input checked="" type="checkbox"/> VIKANE CALCULATOR <input type="checkbox"/> FUMICALC CALCULATOR <input type="checkbox"/> OTHER				
DOSAGE FACTOR <u>IX</u>		UNDER SEAL <u>CLA</u>		
TARP CONDITION <u>Good</u>		TEMPERATURE <u>70</u>		
SEAL CONDITION <u>Good</u>		HOURS EXPOSURE <u>18</u>		
WIND (MPH) <u>4</u>		MONITOR JOB (YES/NO) <u>(NO)</u>		
VOLUME <u>27,000</u>				
CREW MEMBERS NAMES				
Manuel Cruz      Manuel Gonzalez				
Alejandro      Mario Gonzalez				
WAS REQUIRED SAFETY EQUIP. PROVIDED? YES <input checked="" type="checkbox"/> NO ( )				
LICENSEE RELEASING FUMIGANT		LICENSE NO.		
SIGNATURE 		FR 53 Oct		
SECTION 2	AERATION COMMENCED:	TARP / SEAL CONDITION		
VENTILATION COMMENCED	DATE <u>11-22-22</u> TIME <u>3:15pm</u>	<u>GOOD</u>		
CREW MEMBERS NAMES				
3 oz				
WAS REQUIRED SAFETY EQUIP. PROVIDED? YES <input checked="" type="checkbox"/> NO ( )				
LICENSEE COMMENCING VENTILATION		LICENSE NO.		
SIGNATURE 		15591		
SECTION 3	TESTING DEVICE USED	PROPERTY CERTIFIED SAFE FOR RE-ENTRY		
RELEASED FOR OCCUPANCY	<u>Clif-Check</u>	DATE <u>11-23-22</u> TIME <u>7:40am</u>		
CREW MEMBERS NAMES				
Manuel Cruz      Manuel Gonzalez				
Marcelino Rodriguez				
Mario Gonzalez				
WAS REQUIRED SAFETY EQUIP. PROVIDED? YES <input checked="" type="checkbox"/> NO ( )				
LICENSEE RELEASING PROPERTY FOR OCCUPANCY		LICENSE NO.		
SIGNATURE 		FR 53 Oct		



# Y's Pest Control

PR:7983  
OPR: 13361

P.O.Box 150 Harbor City CA 90710

## Invoice

Date	Invoice #
2022/11/23	2176

<b>Termite &amp; General Pest Services</b>	Phone #	424-571-0528
	E-mail	yspestcontrol@gmail.com
	Web Site	www.yspestcontrol.com

<b>Bill To</b>
Steve Tanaka 2525 Highcliff Dr, Torrance, CA 90505

P.O. No.	Terms	Project
	Net 30	

Quantity	Description	Rate	Amount
	Fumigation service with wood repair	2,690.00	2,690.00

Thank you for your business!	<b>Total</b>	2,690.00
------------------------------	--------------	----------

# WOOD DESTROYING PESTS AND ORGANISMS INSPECTION REPORT

Building No. 2525	Street Highcliff Dr	City Torrance	ZIP 90505	Date of Inspection 10/19/2022	Number of Pages 7
----------------------	------------------------	------------------	--------------	----------------------------------	----------------------



**Y's Pest Control**  
**P.O.Box 150**  
 Harbor City CA 90710  
 (424) 571-0528 (310) 617-2166  
 ysppestcontrol@gmail.com

Report # : 10143  
 Registration # : PR7983  
 Escrow # :  
 CORRECTED REPORT

Ordered by: Steve Tanaka 2525 Highcliff Dr Torrance CA 90505 United States	Property Owner and/or Party of Interest: Steve Tanaka 2525 Highcliff Dr Torrance CA 90505 United States	Report sent to:
--	---	-----------------

COMPLETE REPORT      
 LIMITED REPORT      
 SUPPLEMENTAL REPORT      
 REINSPECTION REPORT

<b>GENERAL DESCRIPTION:</b> One story, stucco, raised/slab foundation, composition roof with attached garage.	Inspection Tag Posted: Meter Other Tags Posted:
--	---

An inspection has been made of the structure(s) shown on the diagram in accordance with the Structural Pest Control Act. Detached porches, detached steps, detached decks and any other structures not on the diagram were not inspected.

Subterranean Termites      
 Drywood Termites      
 Fungus / Dryrot      
 Other Findings      
 Further Inspection

**If any of the above boxes are checked, it indicates that there were visible problems in accessible areas. Read the report for details on checked items.**

**Diagram Not To Scale**

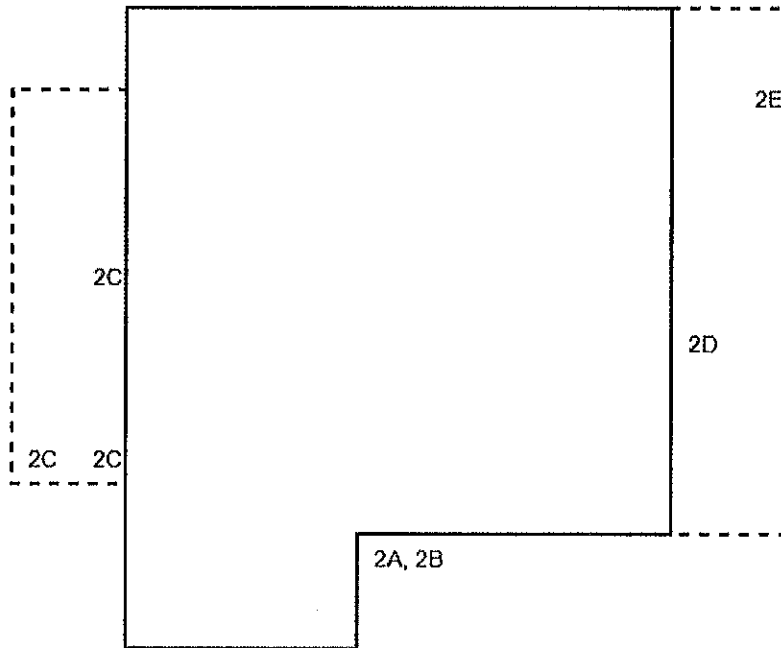

2D

Inspected By: Yusuke Sakuma     
 State License No. FR:46005     
 Signature:

You are entitled to obtain copies of all reports and completion notices on this property reported to the Structural Pest Control Board during the preceding two years. To obtain copies contact: Structural Pest Control Board, 2005 Evergreen Street, Suite 1500, Sacramento, California, 95815-3831.

NOTE: Questions or problems concerning the above report should be directed to the manager of the company. Unresolved questions or problems with services performed may be directed to the Structural Pest Control Board at (916) 561-8708, (800) 737-8188 or www.pestboard.ca.gov.

# Y'S PEST CONTROL

Page 2 of 7 Inspection report

2525	Highcliff Dr	Torrance	CA	90505
Address of Property Inspected		City	State	ZIP
10/19/2022	10143			
Date of Inspection	Corresponding Report No.	Escrow No.		

**WHAT IS A WOOD DESTROYING PEST & ORGANISM INSPECTION REPORT? READ THIS DOCUMENT. IT EXPLAINS THE SCOPE AND LIMITATIONS OF A STRUCTURAL PEST CONTROL INSPECTION AND A WOOD DESTROYING PEST & ORGANISM INSPECTION REPORT.**

A Wood Destroying Pest & Organism Inspection Report contains findings as to the presence or absence of evidence of wood destroying pests and organisms in visible and accessible areas and contains recommendations for correcting any infestations or infections found. The contents of Wood Destroying Pest & Organism Inspection Reports are governed by the Structural Pest Control Act and regulations.

Some structures do not comply with building code requirements or may have structural, plumbing, electrical, mechanical, heating, air conditioning or other defects that do not pertain to wood destroying organisms. A Wood Destroying Pest & Organism Inspection Report does not contain information on such defects, if any, as they are not within the scope of the licenses of either this company, or it's employees.

The Structural Pest Control Act requires inspection of only those areas which are visible and accessible at the time of inspection. Some areas of the structure are not accessible to inspection, such as the interior of hollow walls, spaces between floors, areas concealed by carpeting, appliances, furniture or cabinets. Infestations or infections may be active in these areas without visible and accessible evidence. If you desire information about areas that were not inspected, a further inspection may be performed at an additional cost. Carpets, furniture or appliances are not moved and windows are not opened during a routine inspection.

**The exterior Surface of the roof was not inspected. If you want the water tightness of the roof determined, you should contact a roofing contractor who is licensed by the Contractor's State License Board.**

This company does not certify or guarantee against any leakage, such as (but not limited to) plumbing, appliances, walls, doors, windows, any type of seepage, roof or deck coverings. This company renders no guarantee, whatsoever, against any infection, infestation or any other adverse condition which may exist in such areas or may become visibly evident in such area after this date. Upon request, further inspection of these areas would be performed at an additional charge.

In the event damage or infestation described herein is later found to extend further than anticipated, our bid will not include such repairs. OWNER SHOULD BE AWARE OF THIS CLOSED BID WHEN CONTRACTING WITH OTHERS OR UNDERTAKING THE WORK HIMSELF/HERSELF.

If requested by the person ordering this report, a re-inspection of the structure will be performed. Such requests must be within four (4) months of the date of this inspection. Every re-inspection fee amount shall not exceed the original inspection fee.

Wall paper, stain, or interior painting are excluded from our contract. New wood exposed to the weather will be prime painted, only upon request at an additional expense.

This company will reinspect repairs done by others within four months of the original inspection. A charge, if any, can be no greater than the original inspection fee for each reinspection. The reinspection must be done within ten (10) working days of request. The reinspection is a visual inspection and if inspection of concealed areas is desired, inspection of work in progress will be necessary. Any guarantees must be received from parties performing repairs.

NOTICE: Reports on this structure prepared by various registered companies should list the same findings (i.e. termite infestations, termite damage, fungus damage, etc.). However, recommendations to correct these findings may vary from company to company. You have a right to seek a second opinion from another company.

This Wood Destroying Pest & Organisms Report DOES NOT INCLUDE MOLD or any mold like conditions. No reference will be made to mold or mold-like conditions. Mold is not a Wood Destroying Organism and is outside the scope of this report as defined by the Structural Pest Control Act. If you wish your property to be inspected for mold or mold like conditions, please contact the appropriate mold professional.

# Y'S PEST CONTROL

Page 3 of 7 inspection report

2525	Highcliff Dr	Torrance	CA	90505
Address of Property Inspected		City	State	ZIP
10/19/2022	10143			
Date of Inspection	Corresponding Report No.			Escrow No.

A. Certain areas are recognized by the industry as inaccessible and/or for other reasons not inspected. These include but are not limited to : inaccessible and /or insulated attics or portions thereof, attics with less than 18" clear crawl space, the interior of hollow walls; spaces between a floor or porch deck and the ceiling below; area where there is no access without defacing or tearing out lumber, masonry or finished work; area behind stoves, refrigerators or beneath floor coverings, furnishings; areas where encumbrances and storage, conditions or locks make inspection impractical, portions of the sub area concealed by heavy vegetation. Areas or timbers around eaves were visually inspected from ground level only. Although we make visual examinations, we do not inspect fences, sheds, doghouses, detached patios, detached wood decks, wood retaining walls or wood walkways. We assume no responsibility for work done by anyone else, for damage to structure or contents during our inspection, or for infestation, infection, adverse conditions or damage undetected due to inaccessibility or non-disclosure by owner/agent,tenant.

B. Slab floor construction has become more prevalent in recent years. Floor covering may conceal cracks in the slab that will allow infestation to enter. Infestations in the walls may be concealed by plaster so that a diligent inspection may not disclose the true condition. There areas are not practical to inspect because of health hazards, damage to the structure or inconvenience. These areas are not practical to inspect because of health hazards, damage to the structure or inconvenience, they were not inspected unless described in this report. We recommend further inspection if there is any question about the above noted areas. Ref; Structural Pest Control Act, Article 6, Section 8516(b), paragraph 1990(i). Amended effective March 1, 1974. Inspection is limited to disclosure of wood destroying pests or organisms as set forth in the Structural Pest Control Act, Article 6, Section 8516(b), and Paragraph 1990-1991.

C. If CERTIFICATION is required; a re-inspection will be performed, if requested within four (4) months from date of original inspection, on any corrective work that we are regularly in the business of performing. Work performed by others must be CERTIFIED by the individuals who performed the work. There is a re-inspection fee.

D. This company is not responsible for work completed by others, recommended or not, including by Owner. Contractor bills should be submitted to Escrow as certification of work completed by others.

E. This report includes findings related to the presence/non-presence of wood destroying organisms and/or visible signs of leaks in the accessible portions of the roof. The inspector did not go onto the roof surface due to possible physical damage to the roof, or personal injury. No opinion is rendered nor guarantees implied concerning the watertight integrity of the roof or the condition of the roof and footing materials. If interested parties desire further information on the condition of the roof, we recommend that they engage the services of a licensed roofing contractor.

F. Second story stall showers are inspected but not water tested unless there is evidence of leaks in ceiling below. Ref: Structural Pest Control Rules and Regulations, Sec.8516G. Sunken or below grade showers or tubs are not water tested due to their construction.

G. During the course of/after opening walls or any previously concealed areas, should any further damage or infestation be found, a supplementary report will be issued. Any work completed in these areas would be at Owner's direction and additional expense.

H. During the process of treatment or replacement it may be necessary to drill holes through ceramic tiles or other floor coverings; these holes will then be sealed with concrete, We will exercise due care but assume no responsibility for cracks, chipping or other damage to floor coverings. We do not re-lay carpeting.

I. We assume no responsibility for damage to any Plumbing, Gas or Electrical lines, etc., in process of pressure treatment of concrete slabs or replacement of concrete or structural timbers.

J. When a fumigation is recommended we will exercise all due care but assume no responsibility for damage to Shrubbery, Trees, Plants, TV Antennas or Roofs. A FUMIGATION NOTICE will be left with, or mailed to the Owner of this property, or his designated Agent. Occupant must comply with instructions contained in Fumigation Notice. Therefore, we recommend that you take any steps that you feel necessary to prevent any damage to your property. We also recommend that you contact your



# Y'S PEST CONTROL

Page 4 of 7 inspection report

2525	Highcliff Dr	Torrance	CA	90505
Address of Property Inspected		City	State	ZIP
10/19/2022	10143			
Date of Inspection	Corresponding Report No.		Escrow No.	

insurance agent and verify that you have insurance coverage to protect against any loss, damage or vandalism to your property. The company does not provide any onsite security except as required by state or local ordinance and does not assume any responsibility for care and custody of the property in case of vandalism, breaking or entering.

K. Your termite report and clearance will cover EXISTING infestation or infection, which is outlined in this report. If Owner of property desires coverage of any new infestation it would be advisable to obtain a Control Service Policy, which would cover any new infestation for the coming year.

L. If you should have any questions regarding this report, please call our office any weekday between 8:00 a.m and 5:00 p.m. We also provide information about additional services for the control of Household Pests such as Ants and Fleas, etc.

M. I agree to pay reasonable attorney's fees if suit is required by this COMPANY to enforce any terms of this contract, together with the costs of such action, whether or not suit proceeds to judgment.

N. The total amount of this contract is due and payable upon completion of work unless otherwise specified. A finance charge computed at a Monthly rate of 1.5% pf the unpaid balance (annual percentage rate of 18%) will be added to all accounts past due.

O. If this report is used for escrow purposes then it is agreed that this inspection report and Completion, if any, is part of the ESCROW TRANSACTION. However, if you received written or verbal instructions from any interested parties involved in this escrow (agents, principals, etc.) to not pay our invoice at close of escrow, you are instructed by us not to use these documents to satisfy any conditions or terms of your escrow for purposes of address you have on file for the property owner.

P. Owner/agent/tenant acknowledges and agrees that inspection of the premises will not include any type of inspection for the presence or non-presence of asbestos and that this report will not include any findings or opinions regarding the presence or non-presence of asbestos in, upon or about the premises, we recommend that presence of asbestos during our inspection of the premises or should our inspection of the premises cause a release of asbestos dust or particles, owner/agent/tenant shall be solely responsible for the cleanup removal and disposal of the asbestos and the cost thereof. Owner/agent/tenant hereby agrees to waive any and all claims against this Company with are in any way related to the presence of asbestos on the premises and further agrees to indemnify and hod this company harmless from any and all claims of any nature asserted by any third party, including this Company's employees, which is in any way related to the presence of asbestos on the premises.

Q. Work completed (Labor and Chemicals) by Y's Pest Control shall be guaranteed for a period of one year from completion. Toilets and plumbing (parts supplied by this firm), Showers, floors or any measures for control of moisture are guaranteed for 30 days only. Chemical treatments are guaranteed for one year. Only the areas treated are guaranteed unless otherwise noted.

R. Any additional damage found while work is being performed will be supplemented by a report as to additional findings and cost.

S. If at the time of repairs to decks, the damage is found to be more extensive, findings and recommendations will be issued in a Supplemental Report and bid.

T. Our inspectors are not equipped with 20 ft. extension ladders; therefore all two-story buildings will bot be inspected at the eaves unless requested.

U. Our estimate is good for 30 days from the bid date and is subject to review at that time.

V. Please allow 7 to 10 days advance notice for scheduling of work.

# Y'S PEST CONTROL

Page 5 of 7 Inspection report

2525	Highcliff Dr	Torrance	CA	90505
Address of Property Inspected		City	State	ZIP
10/19/2022	10143			
Date of Inspection	Corresponding Report No.			Escrow No.

**This is a limited report requested by owner. Inspected area is front door and exterior of the house. Recommend to have a complete inspection report.**

## 2. DRYWOOD TERMITES:

### 2A - Section I

**FINDING:** Evidence of drywood termites was noted at front door frame and bottom rail, as indicated on the diagram. Evidence indicates infestation extends into inaccessible areas.

**RECOMMENDATION:** Fumigate the entire structure with a California approved fumigant for the control of Drywood termites. Where accessible, Drywood termite droppings shall be removed, covered or masked over after treatment.

"NOTICE" The charge for the service that this company subcontracts to another registered company may include the company's charges for arranging and administering such services that are in addition to the direct costs associated with another registered company licensed to perform the work.

If you choose to contract directly with another registered company, Y's Pest Control will not in any way be responsible for any act or omission in the performance of work that you directly contract with another to perform.

**Note: Fumigations for Drywood termites are guaranteed by Y's Pest Control for a period of three years from the date of completion.**

### 2A - Secondary Recommendation

As a secondary substandard measure and at owner's request, local treat Drywood termite infestations with a California approved chemical for the control of Drywood termites.

Note: "Local treatment is not intended to be an entire structure treatment method. If infestations of wood destroying pests extend or exist beyond the area(s) of local treatment, they may not be exterminated."

Note: The drill holes will be patched with stucco, wood filler or spackle as needed. Touch-up painting will be done at no extra charge if the paint is furnished by the owner at the time of work. This bid does not include general painting of walls or other areas of treatment.

**Note: Substandard, secondary measure recommendations are warranted for a period of one year from the date of completion, and come with two call backs.**

### 2B - Other

**FINDING:** Damage of drywood termites was noted at bottom rail of the front door as indicated on the diagram.

**Recommendation:** Remove the damaged wood and replace it with the new material. The new material could be wood of known natural resistance to decay or the wood could be painted and/or sealed, etc. to protect it from uncontrollable external weather conditions.

Note: All repairs completed by others must be reinspected by Y's Pest Control before a certification will be issued. The reinspection will only certify the presence or absence of infestations or infections in the visible accessible areas. We do not guarantee work completed by others; nor does this firm make any statements concerning workmanship of those repairs. Workmanship can only be determined by those paying for or receiving the services. A reinspection of specific items on the report or of any other conditions pertaining to this structure can be done at an additional charge per inspection; the cost may not exceed the original inspection fee and must be done within four months of the original inspection.

### 2C - Section I

**FINDING:** Evidence of drywood termites was noted at fascia and beams of the pergola, as indicated on the diagram. Evidence indicates infestation extends into inaccessible areas.

**RECOMMENDATION:** Fumigate the entire structure with a California approved fumigant for the control of Drywood termites.

# Y'S PEST CONTROL

Page 6 of 7 Inspection report

2525	Highcliff Dr	Torrance	CA	90505
Address of Property Inspected		City	State	ZIP
10/19/2022	10143			
Date of Inspection	Corresponding Report No.			Escrow No.

Where accessible, Drywood termite droppings shall be removed, covered or masked over after treatment.

"NOTICE" The charge for the service that this company subcontracts to another registered company may include the company's charges for arranging and administering such services that are in addition to the direct costs associated with another registered company licensed to perform the work.

If you choose to contract directly with another registered company, Y's Pest Control will not in any way be responsible for any act or omission in the performance of work that you directly contract with another to perform.

**Note: Fumigations for Drywood termites are guaranteed by Y's Pest Control for a period of three years from the date of completion.**

## 2C - Secondary Recommendation

As a secondary substandard measure and at owner's request, local treat Drywood termite infestations with a California approved chemical for the control of Drywood termites.

Note: "Local treatment is not intended to be an entire structure treatment method. If infestations of wood destroying pests extend or exist beyond the area(s) of local treatment, they may not be exterminated."

Note: The drill holes will be patched with stucco, wood filler or spackle as needed. Touch-up painting will be done at no extra charge if the paint is furnished by the owner at the time of work. This bid does not include general painting of walls or other areas of treatment.

**Note: Substandard, secondary measure recommendations are warranted for a period of one year from the date of completion, and come with two call backs.**

## 2D - Section I

**FINDING:** Evidence of drywood termites was noted at floor board of the deck, as indicated on the diagram. Evidence indicates infestation extends into inaccessible areas.

**RECOMMENDATION:** Fumigate the entire structure with a California approved fumigant for the control of Drywood termites.

Where accessible, Drywood termite droppings shall be removed, covered or masked over after treatment.

"NOTICE" The charge for the service that this company subcontracts to another registered company may include the company's charges for arranging and administering such services that are in addition to the direct costs associated with another registered company licensed to perform the work.

If you choose to contract directly with another registered company, Y's Pest Control will not in any way be responsible for any act or omission in the performance of work that you directly contract with another to perform.

**Note: Fumigations for Drywood termites are guaranteed by Y's Pest Control for a period of three years from the date of completion.**

## 2D - Secondary Recommendation

As a secondary substandard measure and at owner's request, local treat Drywood termite infestations with a California approved chemical for the control of Drywood termites.

Note: "Local treatment is not intended to be an entire structure treatment method. If infestations of wood destroying pests extend or exist beyond the area(s) of local treatment, they may not be exterminated."

Note: The drill holes will be patched with stucco, wood filler or spackle as needed. Touch-up painting will be done at no extra charge if the paint is furnished by the owner at the time of work. This bid does not include general painting of walls or other areas of treatment.

**Note: Substandard, secondary measure recommendations are warranted for a period of one year from the date of completion, and come with two call backs.**

## 2E - Section I

**FINDING:** Evidence of drywood termites was noted at wood members of the fence, as indicated on the diagram. Evidence indicates infestation extends into inaccessible areas.

**RECOMMENDATION:** Fumigate the entire structure with a California approved fumigant for the control of Drywood termites.

Where accessible, Drywood termite droppings shall be removed, covered or masked over after treatment.

"NOTICE" The charge for the service that this company subcontracts to another registered company may include the company's charges for arranging and administering such services that are in addition to the direct costs associated with another registered

# Y'S PEST CONTROL

Page 7 of 7 inspection report

2525	Highcliff Dr	Torrance	CA	90505
Address of Property Inspected		City	State	ZIP
10/19/2022	10143			
Date of Inspection	Corresponding Report No.			Escrow No.

company licensed to perform the work.

If you choose to contract directly with another registered company, Y's Pest Control will not in any way be responsible for any act or omission in the performance of work that you directly contract with another to perform.

**Note: Fumigations for Drywood termites are guaranteed by Y's Pest Control for a period of three years from the date of completion.**

## 2E - Secondary Recommendation

As a secondary substandard measure and at owner's request, local treat Drywood termite infestations with a California approved chemical for the control of Drywood termites.

Note: "Local treatment is not intended to be an entire structure treatment method. If infestations of wood destroying pests extend or exist beyond the area(s) of local treatment, they may not be exterminated."

Note: The drill holes will be patched with stucco, wood filler or spackle as needed. Touch-up painting will be done at no extra charge if the paint is furnished by the owner at the time of work. This bid does not include general painting of walls or other areas of treatment.

**Note: Substandard, secondary measure recommendations are warranted for a period of one year from the date of completion, and come with two call backs.**

Thank you for selecting us to perform a structural pest control inspection on your property. Should you have any questions regarding this report, please call us directly by the contact information provided on the first page of the inspection report.

Our inspectors have determined that your property will benefit from a safe application of chemicals commonly used for structural pest control. In accordance with the laws and regulations of the State of California, we are required to provide you and your occupants with the following information prior to any application of chemicals to such property.

Please take a few moments to read and become familiar with the content. State law requires that you be given the following information:

**CAUTION - PESTICIDES ARE TOXIC CHEMICALS.** Structural pest control companies are registered and regulated by the Structural Pest Control Board, and apply pesticides which are registered and approved for use by the California Department of Pesticide Regulation and the United States Environmental Protection Agency. Registration is granted when the state finds that based on scientific evidence, there are no appreciable risks weighted by the benefits. The degree of risk depends on the degree of exposure, so exposure should be minimized.

If within 24 hours following application, you experience symptoms similar to common seasonal illness comparable to the flu, contact your physician or poison control center and your pest control operator immediately.

For further information, contact any of the following agencies in your area:

Poison Control Center	(800) 222-1222
Agricultural Department	(626) 575-5471
Health Department	(213) 989-7140
Structural Pest Control Board	(916) 561-8700

2005 Evergreen Street, Ste. 1500. Sacramento, CA 95815



**Y's Pest Control**  
 P.O.Box 150  
 Harbor City CA 90710  
 (424) 571-0528 (310) 617-2166  
 yspestcontrol@gmail.com

**WORK AUTHORIZATION**

**Report #: 10143**

**No work will be performed until a signed copy of this agreement has been received.**

Address of Property : 2525 Highcliff Dr  
 City: Torrance  
 State/ZIP: CA 90505

The inspection report of the company dated, 10/19/2022 is incorporated herein by reference as though fully set forth. The company is authorized to proceed with the work outlined in the items circled below from the Termite Inspection Report for the property inspected, for a total sum of \$ \_\_\_\_\_. This total amount is due and payable within 30 days from completion repair work and/or chemical application.

**THE COMPANY AGREES**

To guarantee all repair completed by this company for one year from date of completion except for caulking, grouting, or plumbing, which is guaranteed for a period of **ninety (90) days**. We assume no responsibility for work performed by others, to be bound to perform this work for the price quoted in our cost breakdown for a period not to exceed 30 days, to use reasonable care in the performance of our work but to assume no responsibility for damage to any hidden pipes, wiring, or other facilities or to any shrubs, plants, or roof.

**THE OWNER OR OWNER'S AGENT AGREES**

To pay for services rendered in any additional services requested upon completion of work to pay a service charge of one and one-half percent (1 1/2%) interest per month, or portion of any month, annual interest rate of eighteen percent (18%) on accounts exceeding the ten (10) day full payment schedule. The Owner grants to The Company a security interest in the property to secure payment sum for work and inspection fee completed. In case of non-payment by The owner, reasonable attorney fees and costs of collection shall be paid by owner, whether suit be filed or not.

**ALL PARTIES AGREE**

If any additional work is deemed necessary by the local building inspector, said work will not be performed without additional authorization from owner or owner's agent. This contract price does not include the charge of any Inspection Report fees. Circle the items you wish performed by The Company, below and enter total amount above:

**NOTICE TO OWNER**

Under the California Mechanics Lien Law, any structural pest control company which contracts to do work for you, any contractor, subcontractor, laborer, supplier or other person who helps to improve your property, but is not paid for his or her work or supplies, has a right to enforce a claim against your property. This means that after a court hearing, your property could be sold by a court officer and the proceeds of the sale used to satisfy the indebtedness. This can happen even if you have paid your structural pest control company in full if the subcontractor, laborers or suppliers remain unpaid.

To preserve their right to file a claim or lien against your property, certain claimants such as subcontractors or material suppliers are required to provide you with a document entitled "Preliminary Notice." Prime contractors and laborers for wages do not have to provide this notice. A Preliminary Notice is not a lien against your property. Its purpose is to notify you of persons who may have a right to file a lien against your property if they are not paid.

<b>ITEMS</b>					
Prefix	Section I	Section II	Further Inspection	Other	
2A (Primary)	2,595.00	0.00	0.00	0.00	
2A (Secondary)	255.00	0.00	0.00	0.00	
2B	0.00	0.00	0.00	95.00	
2C (Primary)	N/A	0.00	0.00	0.00	
2C (Secondary)	385.00	0.00	0.00	0.00	
2D (Primary)	N/A	0.00	0.00	0.00	
2D (Secondary)	195.00	0.00	0.00	0.00	
2E (Primary)	N/A	0.00	0.00	0.00	
2E (Secondary)	225.00	0.00	0.00	0.00	
<b>Section Subtotals</b>					
Using Primary Rec	2,595.00	0.00	0.00	95.00	
Using Secondary Rec	1,060.00	0.00	0.00	95.00	

Property Owner: \_\_\_\_\_ Date: \_\_\_\_\_ *Inspected By: Yusuke Skye Sakuma* Date: 10/27/2022  
 Owner's Agent: \_\_\_\_\_ Date: \_\_\_\_\_



**Y's Pest Control**  
**P.O.Box 150**  
 Harbor City CA 90710  
 (424) 571-0528 (310) 617-2166  
 yspestcontrol@gmail.com

**WORK AUTHORIZATION**

**Report #: 10143**

**PLEASE INITIAL YOUR SELECTION BELOW**

**Primary Total:**      \$2,690.00      \_\_\_\_\_

**OR**

**Secondary Total:**    \$1,155.00      \_\_\_\_\_

**--- FUMIGATION/TENTING DISCLAIMER ---**

I \_\_\_\_\_ the owner, has decided to not fumigate/tent the structure for the eradication/control of drywood termites. I understand that California State Law requires all Termite Companies to recommend fumigation/tenting as the primary method for the eradication of drywood termites. Today on the date of \_\_\_\_ / \_\_\_\_ / 2022, I have agreed to move forward with alternative method to control drywood termites.

Property Owner:	Date:	<i>Inspected By: Yusuke Skye Sakuma</i>	Date: 10/27/ 2022
Owner's Agent:	Date:		