

Building Sketch

| | | | | | |
|------------------|------------------|----------|--------|-------|----|
| Borrower | N/A | | | | |
| Property Address | 3841 Cedron St | | | | |
| City | Irvine | County | Orange | State | CA |
| Client | Holden Bowersock | Zip Code | 92606 | | |

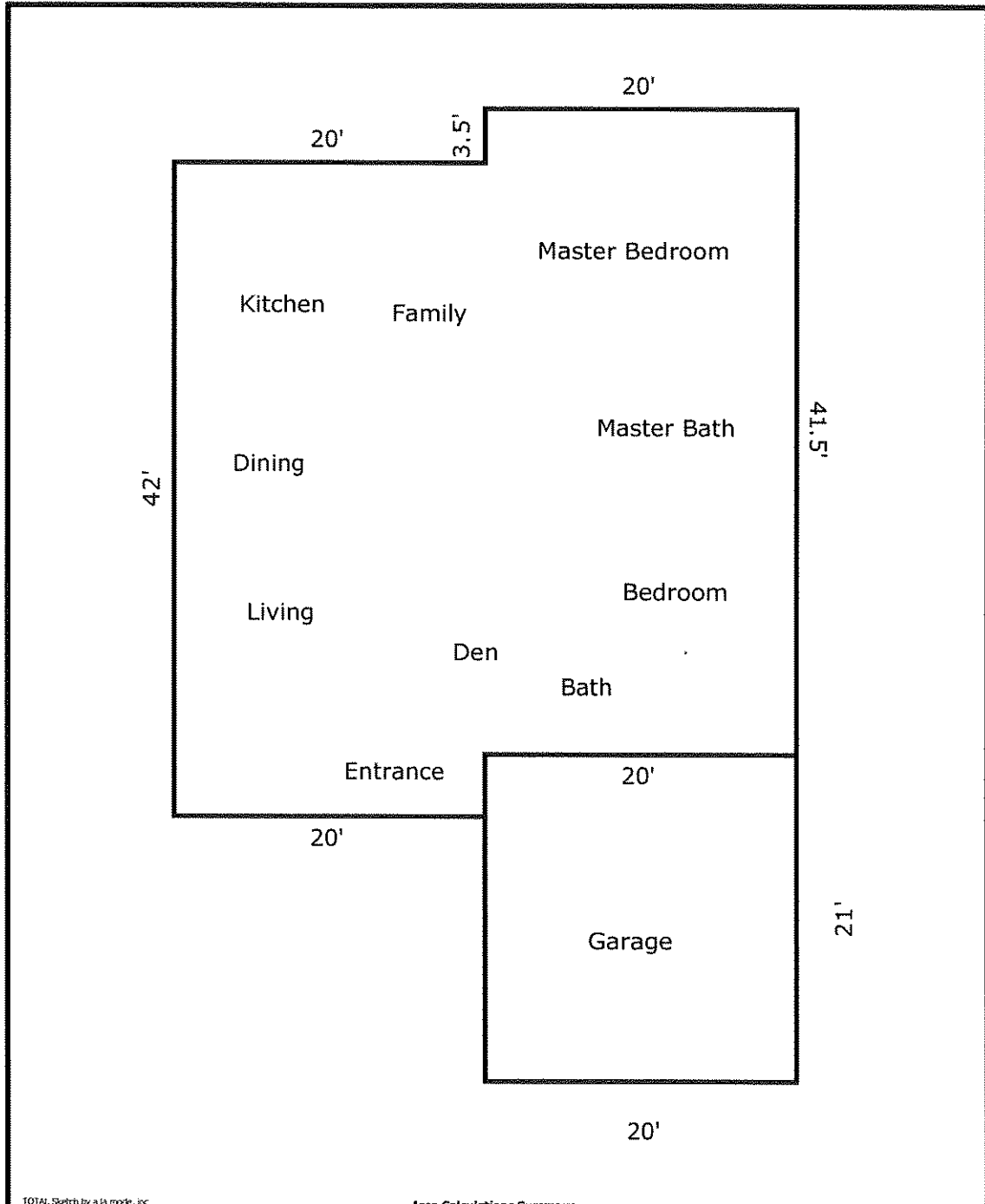

TOTAL Sketch by a la mode, inc.

Area Calculations Summary

| Living Area | Area | Calculation Details |
|-------------------------------------|-------------------|--|
| First Floor | 1670 Sq ft | $41.5 \times 20 = 830$ $42 \times 20 = 840$ |
| Total Living Area (Rounded): | 1670 Sq ft | |
| Non-living Area | 420 Sq ft | $20 \times 21 = 420$ |
| 2 Car Attached | | |