

# STANDARD NOTICE OF WORK COMPLETED AND NOT COMPLETED

NOTICE - All recommendations may not have been completed - See below - Recommendations not completed.  
This form is prescribed by the Structural Pest Control Board.

Building No.	Street	City	Zip	Date of Completion
27705	Solrio	Mission Viejo	92692-3296	11/22/21
<b>Pacific Coast Termite Inc.</b> <b>1211 N Batavia St.</b> <b>Orange, CA 92867</b> <b>Tel 714-450-1250 Fax 714-538-5085</b> <b>Registration #: PR5294</b>			A LICENSED PEST CONTROL OPERATOR IS AN EXPERT IN HIS/HER FIELD. ANY QUESTIONS RELATIVE TO THIS REPORT SHOULD BE REFERRED TO HIM/HER. <b>Report #: 261483</b>	
Ordered by: Jill Clements 27705 Solrio Mission Viejo, CA 92692-3296 949-348-9257		Property Owner and/or Party of Interest: Jill Clements 27705 Solrio Mission Viejo, CA 92692-3296 949-348-9257		Completion sent to: Jill Clements 27705 Solrio Mission Viejo, CA 92692-3296 949-348-9257

The following recommendations on the above designated property, as outlined in the Wood Destroying Pests and Organisms Inspection Report dated 10/21/21 have been and/or have not been completed.

Recommendations completed by this firm that are in accordance with the Structural Pest Control Board's Rules and Regulations:

2A, 2B, 2C.

Recommendations completed by this firm that are considered secondary and substandard measures under Section 1992 of the Structural Pest Control Board's Rules and Regulations including person requesting secondary measure:

Cost of work completed:

Cost: \$	<u>2,800.00</u>
Inspection Fee: \$	<u>0.00</u>
Other: \$	<u>0.00</u>
Total: \$	<u>2,800.00</u>

Recommendations not completed by this firm:

5A.

Estimated Cost: \$ 0.00

Remarks:

Signature 

You are entitled to obtain copies of all reports and completion notices on this property reported to the Structural Pest Control Board during the preceding two years. To obtain copies contact: Structural Pest Control Board, 2005 Evergreen Street, Suite 1500, Sacramento, CA, 95815-3831  
NOTE: Questions or problems concerning the above report should be directed to the manager of the company. Unresolved questions or problems with services performed may be directed to the Structural Pest Control Board at (916) 561-8708, (800) 737-8188 or [www.pestboard.ca.gov](http://www.pestboard.ca.gov). 43M-41 (REV. 10/01)

1211 N. Batavia St.  
Orange, CA 92867  
(714) 450-1250  
(800) 722-4342  
FAX (714) 538-5085



40487 Encyclopedia Circle  
Fremont, CA 94538  
(510) 252-0801  
(888) 772-0779  
FAX (510) 252-0826  
Branch 5139

## SERVICE INVOICE

<input checked="" type="checkbox"/> Termite	<input type="checkbox"/> Wood Repair	<input type="checkbox"/> T.A.P. Attic Insulation	<input type="checkbox"/> Rodent Exclusion	<input checked="" type="checkbox"/> Treatment
OWNER NAME Jill E. Clements		PHONE # 714-450-1250	LOCATION # 11-22-21	
PROPERTY ADDRESS 3776 S. Brea Blvd. Brea, CA 92621				
TECHNICIAN Jesse R. / Guy		INSPECTOR NAME		INSPECTION DATE
NOTES / ITEMS COMPLETED *Everything Completed Per. Blake's Report!  *2 Year Warranty!  Thank you!  Completed walkthrough of all items: Yes <input checked="" type="checkbox"/> Declined <input type="checkbox"/>				XT2000 Plus (d-Limonene 95%) Gal PREMISE 75 WP (Imidacloprid 75%) oz BORA-CARE (Disodium Octaborate 40%) Gal TERMIDOR SC (Fipronil 9.1%) oz ALTRISSET (Chlorantraniliprole 18.4%) oz PRO FOAM 8 oz OPTIGARD FLEX (Thiamethoxam 21.6%) oz

START TIME 8:00 am	FINISH TIME 11:45 am	DATE COMPLETED 11-22-21
-----------------------	-------------------------	----------------------------

TOTAL PRICE OF JOB \$ 2520	OWNER TO PAY BALANCE OF JOB BY: (check one) <input checked="" type="checkbox"/> VISA <input type="checkbox"/> MC <input type="checkbox"/> DIS <input type="checkbox"/> AMX <input type="checkbox"/> CASH <input type="checkbox"/> CHECK
DEPOSIT PAID \$ 0	CREDIT CARD NUMBER 4100 3904 9635 2506
BALANCE DUE UPON COMPLETION \$ 0	EXPIRATION DATE 10/25
AMOUNT COLLECTED \$ 2520	CVC 336
NEW BALANCE \$ 0	CHECK #
CARDHOLDER SIGNATURE x Jill E. Clements	

TECHNICIAN SIGNATURE Jesse R. / Guy	LICENSE # R461716	DATE 11-22-21
OWNER/AGENT SIGNATURE x Jill E. Clements		DATE 11-22-21



PACIFIC COAST TERMITE, INC.  
Registration No. PR5294  
STRUCTURAL PEST CONTROL AGREEMENT

1211 N. Batavia St.  
Orange, CA 92867  
(714) 450-1250  
(800) 722-4342  
FAX (714) 538-5085  
40487 Encyclopedia Circle  
Fremont, CA 94538  
(510) 252-0801  
(888) 772-0779  
FAX (510) 252-0826  
Branch 5139

PCT Location No.  
261433

Pest Control Company: <b>PACIFIC COAST TERMITE, INC.</b>	Registration No. <b>PR5294 - Branch 2 and 3</b>
This agreement is between: <b>Jill Clements</b>	Owner(s) of that certain real property located at: <b>27705 Solrice</b>
referred to as "Owner," and Pacific Coast Termite, Inc. referred to as "Company."	<b>Mission Viejo, CA 92692</b>

**Description of Pest Control Services.** Company agrees to furnish all work, labor, materials and equipment required to complete the following described pest control services, related repairs, and other work recommended in the Wood Destroying Pest and Organism Report performed by Company (or PCT), dated 10-20-21 (Inspection Report), which is incorporated herein by this reference, for the Contract Price.

**Description of the Pest Control Services and related Work to be furnished:**

- ☐ All work recommended in the Inspection Report will be completed.
- ☒ Not all work recommended in the Inspection Report will be completed.

(a) The following portion of the recommended work will be completed:

**2A, 2B, 2C**

(b) The following recommended work will not be completed:

**5A**

Any changes to the above scope of work shall be made in writing, and signed by both Company and Owner.

Scheduled Start Date: 11-22-21. The work will not start earlier than 3 business days after this Agreement is executed.

**Contract Price.** Owner will pay Company Contract Price of \$ 2200.00, for the entire cost of the services and related work described above, excluding any finance charges, which may apply. The Contract Price does not include the costs of required permits, licenses, and rights of way, which may be necessary to complete the project, or the cost of payment and performance bonds, which may be required by the Owner.

This contract is valid for 2 year(s) / 0 month(s) from date of treatment. If you choose to extend your warranty for an additional year or years, it will be at \$2200.00 per additional year.

The Owner will pay a Down payment of \$ 2200.00 to the Company upon execution of this agreement. The Down payment is refundable if the Owner exercises his or her right to cancel this agreement as provided below. Otherwise the Down payment will be applied toward the Contract Price prior to commencement of the work. The balance of \$ 0.00 shall be due and payable on completion of the work. Company shall be entitled to receive payment within 5 days after Company's invoices are submitted. Payments not received within that period shall be considered delinquent. Interest shall accrue on all delinquent payments at the legal rate (1-1/2% per month).

( ) Check No.	( ) Credit Card: (VISA/MC/AMEX)	EXP.	Security Code No.	Cash
Acct. No.:				

**Notice of Three Day Right to Cancel Contract**  
Civil Code Section 1689.7

You, the Owner(s), may cancel this transaction at any time prior to midnight of the third business day after the date of this transaction. See the attached Notice of Cancellation form for an explanation of this right.

A "Notice of Cancellation" may be mailed to PACIFIC COAST TERMITE, INC. at the following address: 1211 N Batavia St., Orange, CA 92867

**NOTICE TO OWNER:** You are entitled to a completely filled in copy of this agreement, signed by both you and the Company, before any work may be started. Owner acknowledges receipt of a completely filled in and executed copy of this Agreement, and 2 copies of the Notice of Cancellation form, on the date first indicated above. Owner authorizes Pacific Coast Termite, Inc. to charge the Owner's credit card account noted above for the down payment and/or balance of all charges due, or to become due, under this Agreement.

Date agreement signed by Owner <u>11-22-21</u>	Owner: <b>Jill Clements</b>
Pacific Coast Termite, Inc., a California corporation.	
By: <b>Blake Wilson</b> State License No. <b>FR49974</b>	Owner:

# WOOD DESTROYING PESTS AND ORGANISMS INSPECTION REPORT

Building No.	Street	City	Zip	Date of Inspection	Number of Pages
27705	Solrio	Mission Viejo	92692-3296	10/20/2021	1 of 7

<b>Pacific Coast Termite Inc.</b> <b>1211 N Batavia St.</b> <b>Orange, CA 92867</b> Tel 714-450-1250 Fax 714-538-5085 Registration #: PR5294	A LICENSED PEST CONTROL OPERATOR IS AN EXPERT IN HIS/HER FIELD. QUESTIONS RELATIVE TO THIS REPORT SHOULD BE REFERRED TO HIM/HER.  <b>Report #: 261483</b>
--	---

Ordered by: Jill Clements 27705 Solrio Mission Viejo, CA 92692-3296 949-348-9257	Property Owner and/or Party of Interest: Jill Clements 27705 Solrio Mission Viejo, CA 92692-3296 949-348-9257	Report sent to: Jill Clements 27705 Solrio Mission Viejo, CA 92692-3296 949-348-9257
--	---	--

COMPLETE REPORT <input type="checkbox"/>	LIMITED REPORT <input checked="" type="checkbox"/>	SUPPLEMENTAL REPORT <input type="checkbox"/>	REINSPECTION REPORT <input type="checkbox"/>
--	--	--	--

General Description: TWO STORY, TOWNHOME/CONDO, SLAB FOUNDATION, FUNRISHED AND OCCUPIED. INTERIOR ONLY.	Inspection Tag Posted: ATTIC  Other Tags Posted:
--	---

  

An inspection has been made of the structure(s) shown on the diagram in accordance with the Structural Pest Control Act. Detached porches, detached steps, detached decks and any other structures not on the diagram were not inspected.

Subterranean Termites <input type="checkbox"/>	Drywood Termites <input checked="" type="checkbox"/>	Fungus/Dryrot <input type="checkbox"/>	Other Findings <input type="checkbox"/>	Further Inspection <input checked="" type="checkbox"/>
--	--	--	---	--

Key: 1 = Subterranean Termites    2 = Drywood Termites    3 = Fungus/Dryrot    4 = Other Findings    5 = Unknown Further Inspection

**DIAGRAM NOT TO SCALE**

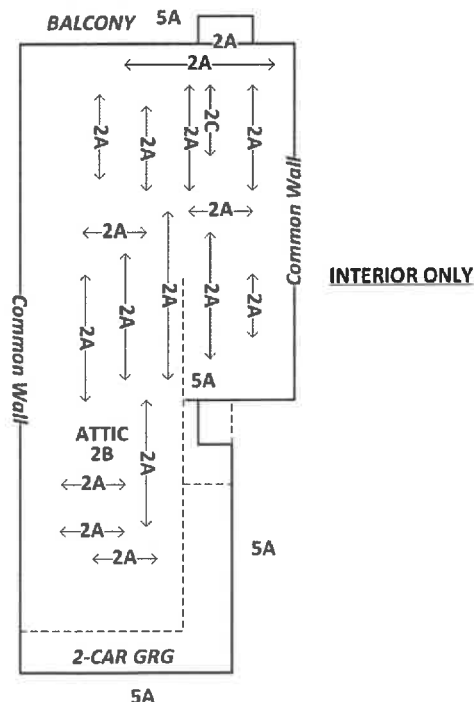

*Blake Wilson*

Inspected By: BLAKE WILSON State License No.: FR 49941 Signature: \_\_\_\_\_

You are entitled to obtain copies of all reports and completion notices on this property reported to the Structural Pest Control Board during the preceding two years. To obtain copies contact: Structural Pest Control Board, 2005 Evergreen Street, Suite 1500, Sacramento, CA 95815

NOTE: Questions or problems concerning the above report should be directed to the manager of the company. Unresolved questions or problems with services performed may be directed to the Structural Pest Control Board at (916) 561-8708, (800) 737-8188 or [www.pestboard.ca.gov](http://www.pestboard.ca.gov).

# WOOD DESTROYING PESTS AND ORGANISMS INSPECTION REPORT

Building No.	Street	City	Zip	Date of Inspection	Number of Pages
27705	Solrio	Mission Viejo	92692-3296	10/20/2021	2 of 7

## General Comments

WHAT IS A WOOD DESTROYING PEST AND ORGANISM INSPECTION REPORT? READ THIS DOCUMENT. IT EXPLAINS THE SCOPE AND LIMITATIONS OF A STRUCTURAL PEST CONTROL INSPECTION AND A WOOD DESTROYING PEST AND ORGANISM INSPECTION REPORT.

A Wood Destroying Pest and Organism Inspection Report contains findings as to the presence or absence of evidence of wood destroying pests and organisms in visible and accessible areas and contains recommendations for correcting any infestations or infections found. The contents of Wood Destroying Pest & Organism. Inspection Reports are governed by the Structural Pest Control Act and regulations.

Some structures do not comply with building code requirements or may have structural, plumbing, electrical, mechanical, heating, air conditioning or other defects that do not pertain to wood destroying organisms. A Wood Destroying Pest & Organism Inspection Report does not contain information on such defect, if any, as they are not within the scope of the licenses of either this company, or it's employees.

The Structural Pest Control Act requires inspection of only those area which are visible and accessible at the time of inspection. Some areas of the structure are not accessible to inspection, such as the interior of hollow walls, spaces between floors, areas concealed by carpeting, appliances, furniture or cabinets. Infestations or infections may be active in these areas without visible and accessible evidence. If you desire information about areas that were not inspected, a further inspection may be performed at an additional cost. Carpets, furniture or appliances are not moved and windows are not opened during a routine inspection.

**INACCESSIBLE AREAS:** Certain areas are recognized by the industry as inaccessible and or for other reasons not inspected, as indicated in Section 1990, Paragraph (d) of the California Structural Pest Control Act. These include, but are not limited to: furnished interiors; inaccessible attics or portions thereof; the interior of hollow walls; spaces between a floor or porch deck and the ceiling or soffit below; stall showers over finished ceilings; such structural segments as Porte cocheres, enclosed bay windows, buttresses, and similar areas to which there is no access without defacing or tearing out lumber, masonry or finished work; built-in cabinet work; floors beneath coverings, areas where storage conditions or locks make inspection impracticable.

**NOTE:** "THE EXTERIOR SURFACE OF THE ROOF WAS NOT INSPECTED. IF YOU WANT THE WATER TIGHTNESS OF THE ROOF DETERMINED, YOU SHOULD CONTACT A ROOFING CONTRACTOR WHO IS LICENSED BY THE CONTRACTOR'S STATE LICENSE BOARD". This company does not certify or guarantee against any leakage, such as (but not limited to ) plumbing, appliances, walls, doors, windows, any type of seepage, roof or deck coverings. This company renders no guarantee, whatsoever, against any infection, infestation or any other adverse condition which may exist in such areas or may become visibly evident in such area after this date, Upon request, further inspection of these areas would be performed at an additional charge.

In the event damage or infestation described herein is later found to extend further than anticipated, our bid will not include such repairs. **OWNER SHOULD BE AWARE OF THIS CLOSED BID WHEN CONTRACTING WITH OTHERS OR UNDERTAKING THE WORK HIMSELF/HERSELF.**

Having termite treatment including preventative work done on your home is not a substitute for regular home maintenance.

This Wood Destroying Pest & Organisms Report DOES NOT INCLUDE MOLD or any mold like conditions. No reference will be made to mold or mold-like conditions. Mold is not a Wood Destroying Organism and is outside the scope of this report as defined by the Structural Pest Control Act. If you wish your property to be inspected for mold or mold like conditions, please contact the appropriate mold professional.

This company will reinspect repairs done by others within four months of the original inspection. A charge, if any, can be no greater than the original inspection fee for each reinspection. The reinspection must be done within ten (10) working days of request. The reinspection is a visual inspection and if inspection of concealed areas is desired, inspection of work in progress will be necessary. Any guarantees must be received from parties performing repairs.

Wall paper, stain, or interior painting are excluded from our contract. New wood exposed to the weather will be prime painted, only upon request at an additional expense.

All pesticides and fungicides must be applied by a state certified applicator (sec. 8555 Business and Professions Code Division 3) and in accordance with the manufacturer's label requirements.

**"NOTICE: REPORTS ON THIS STRUCTURE PREPARED BY VARIOUS REGISTERED COMPANIES SHOULD LIST THE SAME FINDINGS (I.E. TERMITE INFESTATIONS, TERMITE DAMAGE, FUNGUS DAMAGE, ETC.) HOWEVER, RECOMMENDATIONS TO CORRECT THESE FINDINGS MAY VARY FROM COMPANY TO COMPANY. YOU HAVE THE RIGHT TO SEEK A SECOND OPINION FROM ANOTHER COMPANY."**

Please note: drywood termite droppings may be observed for a period of up to 6 months following treatment. Should activity continue please call the offices of Pacific Coast Termite. Should you see any live activity (Swarmers), please call to schedule a service call right away.

\_\_\_\_\_ initials

# WOOD DESTROYING PESTS AND ORGANISMS INSPECTION REPORT

Building No.	Street	City	Zip	Date of Inspection	Number of Pages
27705	Solrio	Mission Viejo	92692-3296	10/20/2021	3 of 7

## DRYWOOD TERMITES

### Description of Findings

- Finding: 2A      Evidence of drywood termites noted at ATTIC FRAMING.  
Recommendation:      The following areas will be treated for the control of drywood termites in the prescribed manner, a foam or liquid solution of 95% D-Limonene Orange Oil (XT-2000 Orange Oil Plus) or Altriset will be injected into the channels of drywood termites where active infestation was noted. This could include inserting a borescope into wall void to visually look for infestation as well. A foam solution of Bora-Care may also be injected into wall and or other voids adjacent to infested areas as situation permits, or deemed necessary. Remove or cover all accessible pellets or frass of wood-destroying pests.  
Price: \$2,800.00
- Finding: 2B      Preventative treatment for the control of drywood termites at the accessible attic wood framing members.  
Recommendation:      A foam solution of Bora-Care will be applied on all accessible exposed wood framing for the control of drywood termite infestation.  
Price: Price included in 2A
- Finding: 2C      Evidence of drywood termites noted at INTERIOR CEILING, COMING FROM ATTIC JOIST.  
Recommendation:      The following areas will be treated for the control of drywood termites in the prescribed manner, a foam or liquid solution of 95% D-Limonene Orange Oil (XT-2000 Orange Oil Plus) or Altriset will be injected into the channels of drywood termites where active infestation was noted. This could include inserting a borescope into wall void to visually look for infestation as well. A foam solution of Bora-Care may also be injected into wall and or other voids adjacent to infested areas as situation permits, or deemed necessary. Remove or cover all accessible pellets or frass of wood-destroying pests.  
Price: Price included in 2A

## FURTHER INSPECTIONS

- Finding: 5A      EXTERIOR WAS NOT INSPECTED PER OWNERS REQUEST. HOA RESPONSIBILITY.  
Recommendation:      Complete inspection, report and treatment of findings. If any damage is found during the course of this inspection, a Supplemental Report will be issued with our additional findings and cost. This limited inspection report includes a recommendation for further inspection of the entire structure and that all accessible evidence of wood-destroying pests be removed or covered.  
Price: Owner to complete

---

**Grand Total:      \$2,800.00**



# WOOD DESTROYING PESTS AND ORGANISMS INSPECTION REPORT

Building No.	Street	City	Zip	Date of Inspection	Number of Pages
27705	Solrio	Mission Viejo	92692-3296	10/20/2021	4 of 7

## Disclaimer

Limited Warranty, Disclaimer and Limitation of Claims. Company guarantees that the work will be performed in a good workmanlike manner within generally accepted pest control practices. The warranty covers all work performed by Company in accordance with the recommendations noted in the Inspection Report, and if termite infestation is found in any of those areas in which work was performed within two (2) years of the completion of Company's work, further treatments will be performed at no additional charge to remediate such infestation in accordance with any recommendations made in a subsequent inspection report identifying such infestation. The warranty covers all structural repair work performed against defects in workmanship and materials for a period of one (1) year from the date of its completion, and is limited to the performing the repairs necessary to correct any such defects in workmanship. This warranty does not cover damage or defects that are the result of characteristics common to the materials used, or conditions resulting from consideration, expansion, or contraction of such materials. Further, Company makes no warranties or representations concerning any pesticides or other materials installed by Company. Warranty work will be completed within sixty (60) days from the date of receipt of written request from Owner. Company's sole obligation shall be to repair, or replace, such work, or portion thereof, that has been promptly reported as defective by Owner within the warranty period and which has been determined by Company to have been defective. "Local treatment is not intended to be an entire structure treatment method. If infestations of wood destroying pests extend or exist beyond the area(s) of local treatment, they may not be exterminated."

This report is not to be used for escrow purposes, unless specified and separated.

If you decide to sell your home while it is under warranty and the buyer demands that your home be fumigated, Pacific Coast Termite is not responsible for the cost of fumigation or any expenses incurred during the process.

THE ABOVE LIMITED WARRANTY IS THE ONLY WARRANTY MADE BY COMPANY. COMPANY DISCLAIMS ALL OTHER EXPRESS AND IMPLIED WARRANTY, INCLUDING ALL WARRANTIES OF MERCHANT ABILITY AND FITNESS FOR A PARTICULAR PURPOSE. COMPANY SHALL HAVE NO LIABILITY FOR ANY INDIRECT, CONSEQUENTIAL, OR SPECIAL DAMAGES TO OWNER WITH RESPECT TO COMPANY'S OBLIGATIONS HEREUNDER, INCLUDING, BUT NOT LIMITED TO, LOSS OF USE, LOSS OF PRODUCTION, LOSS OF PROFITS, LOSS OF BUSINESS OPPORTUNITIES, EMOTIONAL DISTRESS, AGGRAVATION, OR ANY OTHER SIMILAR DAMAGES EVEN IF COMPANY HAS BEEN ADVISED OF THE POSSIBILITY OF SUCH DAMAGES.

Force Majeur-Delay-Extension of Time. Company shall not be liable for any delay or nonperformance caused by an act of God, acts of the Owner, the Owner's architect, engineer, contractor, or the building department, stormy weather, strikes or other labor troubles not the fault of Company, extra work ordered by the Owner, Owner's architect, engineer, contractor, or the building department, unavailability of materials, failure of the Owner to make progress payments when due that substantially interferes with the Company's ability to continue performance of the work, or any other contingency beyond the Company's reasonable control.

## NOTICE TO OWNER:

Under the California Mechanics Lien Law any structural pest control company which contracts to do work for you, any contractor, subcontractor, laborer, supplier or other person who helps to improve your property, but is not paid for his or her work or supplies, has a right to enforce a claim against your property. This means that after a court hearing, your property could be sold by a court officer and the proceeds of the sale used to satisfy the indebtedness. This can happen even if you have paid your structural pest control company in full if the subcontractor, laborers or suppliers remain unpaid. To preserve their right to file a claim or lien against your property, certain claimants such as subcontractors or material suppliers are required to provide you with a document entitled "Preliminary Notice." Prime contractors and laborers for wages do not have to provide this notice. A Preliminary Notice is not a lien against your property. Its purpose is to notify you of persons who may have a right to file a lien against your property if they are not paid.

## \*\*\*NOTICE TO OCCUPANT\*\*\*

In accordance with the laws and regulations of the State of California, we are required to provide you the following information prior to application of pesticides to your property.

State law requires that you be given the following information: CAUTION, PESTICIDES ARE TOXIC CHEMICALS. Structural Pest Control companies are licensed and regulated by the Structural Pest Control Board, and apply pesticides

# WOOD DESTROYING PESTS AND ORGANISMS INSPECTION REPORT

Building No.	Street	City	Zip	Date of Inspection	Number of Pages
27705	Solrio	Mission Viejo	92692-3296	10/20/2021	5 of 7

which are registered and approved for use by the California Dept. of Pesticide Regulation and the United States Environmental Protection Agency. Registration is granted when the State finds that, based on existing scientific evidence there are no appreciable risks if proper use conditions are followed or that the risks are outweighed by the benefits. The degree of risk depends upon the degree of exposure, so exposure should be minimized.

If within 24 hours following application, you experience symptoms similar to common illness comparable to the flu, contact your physician or poison control center (800)876-4766 and your pest control company immediately. Effects of over exposure to these materials can include tremors, lethargy, CNS stimulation and tonic and colonic convulsions.

For further information contact any of the following:

Pacific Coast Termite, Inc. (800) 669-1900

Poison Control Center (800) 876-4766

For Health Questions: County/ City Health Departments

Alameda (510) 267-3250 Amador (209) 223-6407 Berkley City (510) 981-5300  
Calaveras (209) 754-6460 Contra Costa (925) 313-6767 El Dorado (530) 621-6100  
Fresno (559) 445-3550 Kern (661) 321-3000 Kings (559) 584-1401  
Lake (707) 994-9433 Long Beach (562) 570-7468 Los Angeles (213) 351-7800  
Marin (415) 473-6007 Mariposa (209) 966-3689 Mendocino (707) 472-2600  
Merced (209) 381-1023 Monterey (831) 755-4683 Napa (707) 253-4270  
Orange (800) 564-8448 Pasadena (626) 744-6012 Placer (530) 889-7141  
Riverside (951) 358-5107 Sacramento (916) 875-7468 San Benito (831) 637-5367  
San Bernardino (909) 387-6521 San Diego (866) 358-2966 San Francisco (415) 554-2830  
San Joaquin (209) 468-3481 San Luis Obispo (805) 781-5500 San Mateo (650) 573-2877  
Santa Barbara (805) 346-8420 Santa Clara (408) 792-5040 Santa Cruz (831) 454-4343  
Solano (707) 553-5402 Sonoma (707) 565-4567 Stanislaus (209) 558-8872  
Tulare (800) 834-7121 Tuolumne (209) 533-7401 Ventura (805) 981-5211  
Yolo (530) 666-8645

For Application Information: County Agricultural commissioners offices:

Alameda (510) 670-5232 Amador (209) 223-6487 Calaveras (209) 754-6504  
Contra Costa (925) 646-5250 El Dorado (530) 621-5520 Fresno (559) 600-7510  
Kern (661)868-6300 Kings (559) 582-3211 Los Angeles (626) 575-5471  
Lake (707) 263-0217 Marin (415) 473-6700 Mariposa (209) 966-2075  
Mendocino (707) 463-4208 Merced (209) 385-7431 Monterey (831) 759-7325  
Napa (707) 253-4357 Orange (714) 955-0100 Placer (530) 889-7372  
Riverside (951) 995-3000 Sacramento (916) 875-6603 San Benito (831) 637-5344  
San Bernardino (909) 387-2115 San Diego (858) 694-2741 San Francisco (415) 252-3830  
San Joaquin (209) 953-6000 San Luis Obispo (805) 781-5910 San Mateo (650) 363-4700  
Santa Barbara (805) 681-5600 Santa Clara (408) 918-4600 Santa Cruz (831) 763-8080  
Solano (707) 784-1310 Sonoma (707) 565-2371 Stanislaus (209) 525-4730  
Tulare (559) 684-3350 Tuolumne (209) 533-5691 Ventura (805) 477-1620  
Yolo (530) 666-8140

For regulatory information: Structural Pest Control Board (916) 561-8704  
2005 Evergreen Street, Suite 1500, Sacramento, Ca 95815

TERMITE AND FUNGUS CONTROL CHEMICALS

XT-2000 Orange Oil Plus (EPA Reg No. 71986-2)



# WOOD DESTROYING PESTS AND ORGANISMS INSPECTION REPORT

Building No.	Street	City	Zip	Date of Inspection	Number of Pages
27705	Solrio	Mission Viejo	92692-3296	10/20/2021	6 of 7

Active Ingredients: d-Limonene.....95%

Bora-Care (EPA Reg No. 64405-1)

Active Ingredients: Disodium Octaborate

Tetrahydrate.....98%

Premise 75 WP (EPA Reg No. 432-1332)

Active Ingredients: Imidacloprid,

1-[(6-Chloro-3-pyridinyl)methyl]-N-nitro-2-imidazolidinimine.....75%

Premise Foam (EPA Reg No. 432-1391)

Active Ingredients: Imidacloprid; 1-[(6-chloro-3-pyridinyl)methyl]-N

nitro-2-imidazolidinimine.....0.05%

Altriset (EPA Reg No. 352-829)

Active ingredients:Chlorantraniliprole,

3-Bromo-N-[4-chloro-2-methyl-6-[(methylamino)carbonyl]phenyl]-1-(3-chloro-2-pyridinyl)

-1H-pyrazole-5-carboxamide.....18.4%

Termidor SC (EPA Reg No. 7969-210)

Active Ingredients: fipronil: 5-amino-1-(2,6dichloro-4-(trifluoromethyl)

phenyl)-4-((1,R,S-trifluoromethyl)sulfinyl)-1-H-pyrazole-3-carbonitrile.....9.1%

Termidor HE (EPA Reg No. 7969-329)

Active Ingredients: fipronil: 5-amino-1-(2,6dichloro-4-(trifluoromethyl)

phenyl)-4-((1,R,S-trifluoromethyl)sulfinyl)-1-H-pyrazole-3-carbonitrile.....8.73%

Alpine Termite Foam (EPA reg. no. 499-526)

Active Ingredient: Dinotefuran,

N-methyl-N'-nitro-N-[(tetrahydro-3-furanyl)methyl]guanidine.....0.025%

Tim-Bor Professional (EPA Reg. No. 64405-8)

Active Ingredients: Disodium Octaborate

Tetrahydrate.....98%

Advanced 375A (EPA Reg. No. 499-370)

Active Ingredients: Abamectin\*B1.....0.011%

THANK YOU FOR CHOOSING PACIFIC COAST TERMITE, INC., to perform a structural pest control inspection on your property. Our inspection has determined that your property will benefit from the safe application of a chemical commonly used for structural pest control.

By signing below I authorize the following recommendations to be performed as stated in this report and for the price as set forth in the above report.

\_\_\_\_\_  
Authorized Signature/Date

\_\_\_\_\_  
Pacific Coast Termite, Inc. Rep/Date

## WOOD DESTROYING PESTS AND ORGANISMS INSPECTION REPORT

Building No.	Street	City	Zip	Date of Inspection	Number of Pages
27705	Solrio	Mission Viejo	92692-3296	10/20/2021	7 of 7