

WOOD DESTROYING PESTS AND ORGANISMS INSPECTION REPORT

BUILDING NO. 29404	STREET, CITY, STATE, ZIP Alpine Drive, Cold Springs CA 95335	Date of Inspection 8/12/2024	No. of Pages 6
		P.O. Box 3731 Sonora, CA 95370 Tel: (209) 536-4615 www.bestpestsierra.com Email: bestpestsierra@gmail.com	
Firm Registration No. PR 8652	Report No. 27321	Escrow No.	
Ordered By: Berkshire Hathaway 133 Old Wards Ferry Rd Ste E Sonora, CA 95370 Attn: Rachel Brannon	Property Owner/Party of Interest	Report Sent To: Manuel Palazuelos 29404 Alpine Drive Cold Springs, CA 95335	
COMPLETE REPORT <input checked="" type="checkbox"/>	LIMITED REPORT <input type="checkbox"/>	SUPPLEMENTAL REPORT <input type="checkbox"/>	REINSPECTION REPORT <input type="checkbox"/>
General Description: ONE STORY SINGLE FAMILY RESIDENCE FURNISHED		Inspection Tag Posted: SUBSTRUCTURE AREA	
		Other Tags Posted: None	
An inspection has been made to the structure(s) shown on the diagram in accordance with the Structural Pest Control Act. Detached porches, detached steps, detached decks and any other structures not on the diagram were not inspected.			
Subterranean Termites <input type="checkbox"/> Drywood Termites <input type="checkbox"/> Fungus/Dryrot <input checked="" type="checkbox"/> Other Findings <input checked="" type="checkbox"/> Further Inspection <input type="checkbox"/>			
If any of above boxes are checked, it indicates that there were visible problems in accessible areas. Read the report for details on checked items.			

Diagram not to scale. Items in approximate location.

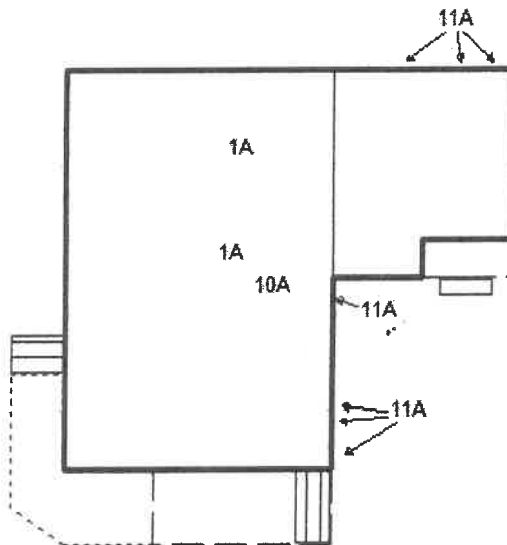

Inspected by Bobby Aubrey

State License No. FR61368

Signature



You are entitled to obtain copies of all reports and completion notices on this property reported to the Structural Pest Control Board during the preceding two years. To obtain copies contact: Structural Pest Control Board, 2005 Evergreen Street, Suite 1500, Sacramento, California 95815.

NOTE: Questions or problems concerning the above report should be directed to the manager of the company. Unresolved questions or problems with services performed may be directed to the Structural Pest Control board at (916) 561-8708, or (800) 737-8188 or www.pestboard.ca.gov.

29404

Alpine Drive, Cold Springs CA 95335

8/12/2024

27321

BUILDING NO.

STREET, CITY, STATE, ZIP

INSPECTION DATE

REPORT NO.

THIS IS A SEPARATED REPORT WHICH IS DEFINED AS SECTION 1/SECTION 2 CONDITIONS EVIDENT ON THE DATE OF INSPECTION.

SECTION 1 CONTAINS ITEMS WHERE THERE IS VISIBLE EVIDENCE OF ACTIVE WOOD DESTROYING PESTS OR ORGANISMS OR CONDITIONS THAT HAVE RESULTED IN OR FROM WOOD DESTROYING PEST OR ORGANISMS.

SECTION 2 ITEMS ARE CONDITIONS DEEMED LIKELY TO LEAD TO WOOD DESTROYING PESTS OR ORGANISMS, BUT WHERE NO VISIBLE EVIDENCE OF SUCH WAS FOUND.

FURTHER INSPECTION ITEMS ARE DEFINED AS RECOMMENDATIONS TO INSPECT AREA(S) WHICH DURING THE COMPLETE INSPECTION, DID NOT ALLOW THE INSPECTOR ACCESS TO COMPLETE THE INSPECTION AND CANNOT BE DEFINED AS SECTION 1 OR SECTION 2.

A Wood Destroying Pest and Organism Inspection Report contains findings as to the presence or absence of evidence of wood destroying insects or organisms (fungi/rot) in visible and accessible areas on the date of inspection. It contains our recommendations for correction any infestations, infections or conditions found. The contents of the Wood Destroying Pest and Organism Inspection Report are governed by the Structural Pest Control Act and the rules and regulations of the Structural Pest Control Board. Some structures may not comply with building code requirements or may have structural, plumbing, electrical, heating and air conditioning, or other defects that do not pertain to wood destroying organisms. A Wood Destroying Pest and Organism Inspection Report does not contain information about such defects as they are not within the scope of the license of the inspector or the company issuing this report. Nor does a Wood Destroying Pest and Organism Inspection Report contain information about asbestos or any other environmental or safety hazard. Best Pest Sierra does not inspect for code compliance. However, if repairs are contracted through Best Pest Sierra, we may be required to repair/rebuild according to current codes.

NOTE: WORK DONE BY BEST PEST SIERRA: IF ANY FINDINGS IN THIS REPORT ARE CONTRACTED TO BE REPAIRED BY BEST PEST SIERRA, THE DAMAGED AREAS WILL BE REPLACED WITH SAME OR LIKE MATERIAL. IF THE EXISTING MATERIAL IS NOT AVAILABLE, A SIMILAR MATERIAL WILL BE USED. IF THE DAMAGED AREA WAS PAINTED, NEW MATERIAL WILL BE PAINT MATCHED AS CLOSE AS POSSIBLE TO THE EXISTING MATERIAL. BEST PEST SIERRA IS NOT A LICENSED PAINTING CONTRACTOR AND CANNOT GUARANTEE EXACT PAINT MATCH. A COAT OF MATCHED PAINT WILL BE APPLIED TO THE NEW MATERIAL AND ANY REMAINING COATS OF PAINT WILL BE OWNERS RESPONSIBILITY. A SUPPLEMENTAL REPORT WILL BE GIVEN IF ANY ADDITIONAL DAMAGE IS EXPOSED. ESTIMATES GIVEN IN THIS REPORT ARE GOOD FOR 3 MONTHS FROM INSPECTION DATE. PRICES ARE SUBJECT TO CHANGE UPON CHANGES IN MATERIAL, SPECIAL ORDERS/SHIPPING, CHANGES TO CURRENT SIZE/FOOTPRINT OF THE AREA NEEDING REPAIR. ESTIMATES ARE SUBJECT TO CHANGE IF AN ENGINEER/PLANS ARE REQUIRED FOR REPAIRS.

NOTE THE FACIA BOARD WAS NOTED TO BE WEATHERED AND/OR WARPED. ANY FINDINGS TO VISIBLE AREAS ARE LISTED IN REPORT.

29404

Alpine Drive, Cold Springs CA 95335

8/12/2024

27321

BUILDING NO.

STREET, CITY, STATE, ZIP

INSPECTION DATE

REPORT NO.

NOTE THERE IS A NORMAL AMOUNT OF STORAGE IN THE HOME. SOME AREAS WERE NOT VISIBLE FOR INSPECTION. ANY FINDINGS TO VISIBLE/ACCESSIBLE AREAS ARE LISTED IN REPORT. BEST PEST SIERRA IS NOT RESPONSIBLE FOR ANY LATER FINDINGS AFTER THESE AREAS ARE MADE ACCESSIBLE. A SUPPLEMENTAL REPORT CAN BE GIVEN IF REQUESTED.

NOTE SOME OF THE SINK CABINETS AND HOME CLOSETS WERE INACCESSIBLE DUE TO EXCESSIVE STORAGE AND A GOOD VISUAL INSPECTION WAS NOT GIVEN.

NOTE THE SUB FLOORING WAS FOUND TO BE INACCESSIBLE FOR PHYSICAL INSPECTION DUE TO INSULATION. IT IS IMPRACTICAL TO REMOVE THE INSULATION AT THIS TIME SINCE NO VISIBLE SIGNS OF INFESTATION OR INFECTION ARE VISIBLE. IF INTERESTED PARTIES ARE CONCERNED AN INSPECTION WOULD BE MADE UPON REMOVAL OF THE INSULATION.

NOTE: AREAS OF THE UNDERSIDE OF THE DECK STRUCTURE WERE NOT VISIBLE FOR INSPECTION DUE TO STORED FIREWOOD.

NOTE: THE GARAGE IS NOT INCLUDED IN THIS INSPECTION AS REQUESTED BY THE OWNER.

Substructure Areas:

ITEM 1A Cardboard covers were noted around some piers in the subarea.

RECOMMENDATION Remove the cardboard covers from the piers and dispose of them.

***** This is a Section 2 Item *****

Other - Interiors:

ITEM 10A The toilet was found to be loose in the bathroom.

RECOMMENDATION Re tighten the toilet as necessary. A supplemental report will be given if it is found that the bolts/flange need to be replaced.

***** This is a Section 2 Item *****

Other - Exteriors:

ITEM 11A Fungus damage/wood rot was noted at the T1-11 siding under/around the window, minor rot at the right side corner and at the rear right lower siding.

RECOMMENDATION Remove the damaged siding around the window for further inspection. If no further damage is exposed, replace with new material with z bar. Repair the damaged siding in the corner and trim off the damaged siding at the bottom of the rear right siding. Paint match new/repared material as necessary.

NOTE: A supplemental report will be given if any additional damage is exposed.

***** This is a Section 1 Item *****

29404

Alpine Drive, Cold Springs CA 95335

8/12/2024

27321

BUILDING NO.

STREET, CITY, STATE, ZIP

INSPECTION DATE

REPORT NO.

THE EXTERIOR SURFACE OF THE ROOF WILL NOT BE INSPECTED. IF YOU WANT THE WATER TIGHTNESS OF THE ROOF DETERMINED, YOU SHOULD CONTACT A ROOFING CONTRACTOR WHO IS LICENSED BY THE CONTRACTORS STATE LICENSING BOARD.

NOTICE: The charge for service that this company subcontracts to another registered company may include the company's charges for arranging and administering such services that are in addition to the direct costs associated with paying the subcontractor. You may accept BEST PEST SIERRA bid or you may contract directly with another registered company licensed to perform the work. If you choose to contract directly with another registered company, BEST PEST SIERRA will not in any way be responsible for any act or omission in the performance of work that you directly contract with another to perform.

"NOTICE: REPORTS ON THIS STRUCTURE PREPARED BY VARIOUS REGISTERED COMPANIES SHOULD LIST THE SAME FINDINGS (i.e. TERMITE INFESTATIONS, TERMITE DAMAGE, FUNGUS DAMAGE etc.) HOWEVER, RECOMMENDATIONS TO CORRECT THESE FINDINGS MAY VARY FROM COMPANY TO COMPANY. YOU HAVE A RIGHT TO SEEK A SECOND OPINION FROM ANOTHER COMPANY"

This company will reinspect repairs done by others within four months of the original inspection. A charge, in any, can be no greater than the original inspection fee for each reinspection report. The reinspection must be done within ten (10) working days of request. The reinspection is a visual inspection and if inspection of concealed areas is desired, inspection of work in progress will be necessary. Any guarantees must be received from parties performing repairs. This company does not guarantee work performed by other.

IN THE EVENT LOCALIZED TREATMENT IS RECOMMENDED IN THIS REPORT: Local treatment is not intended to be an entire structure treatment method. If infestations of wood destroying pests extend or exist beyond the area(s) of local treatment, they may not be exterminated.

ASBESTOS - **IMPORTANT NOTE FOR ALL PARTIES REGARDING THIS PROPERTY**

Notice to customer and buyers having repairs done - Some residential structures are constructed with material that may contain material manufactured with asbestos. Our company is not qualified or certified to identify these materials. If the owner or interested parties are aware of, interested in, or concerned about this condition, they should contact the appropriate agencies that are qualified or certified in this field.

29404

Alpine Drive, Cold Springs CA 95335

8/12/2024

27321

BUILDING NO.

STREET, CITY, STATE, ZIP

INSPECTION DATE

REPORT NO.

Prices quoted are for this company to complete all items in this report. If all items are not requested to be completed by this company the bids are subject to change. Our bid for linoleum and tile are for a standard grade FHA material. Any upgrade in material which may be desired by owner will have additional charges. This company's minimum charge to perform work at any property is \$895.00

During the process of treatment or replacement it may be necessary to drill holes through ceramic tiles or other floor coverings; These holes will then be sealed with concrete. We will exercise due care but assume no responsibility for cracks, chipping or other damage to floor coverings. We do not re-lay carpeting pulled back for treatment or repairs.

We assume no responsibility for damage to any Plumbing, Gas, or Electric lines, etc., that may become damaged in the process of pressure treatment of concrete slabs or replacement of concrete or structural wood members.

Work performed by our company will be guaranteed for a period of one year from date of completion. Fumigations for the control of drywood termites will be guaranteed for a period of three years. Plumbing and maintenance repairs are guaranteed for 30 days.

ALL REPAIRS COMPLETED BY OTHERS MUST BE REINSPECTED BY BEST PEST SIERRA BEFORE A CERTIFICATION WILL BE ISSUED. THE RE INSPECTION WILL ONLY CERTIFY THE ABSENCE OF INFESTATION OR INFECTION IN THE ACCESSIBLE AND VISIBLE AREAS. WE DO NOT GUARANTEE WORK COMPLETED BY OTHERS, NOR DOES THIS FIRM MAKE ANY STATEMENTS CONCERNING WORKMANSHIP OF THOSE REPAIRS. WORKMANSHIP IS ONLY DETERMINABLE BY THOSE PAYING FOR OR RECEIVING THOSE SERVICES. A RE INSPECTION OF SPECIFIC ITEMS ON THE REPORT OR OF ANY OTHER CONDITION PERTAINING TO THIS STRUCTURE CAN BE DONE AT AN ADDITIONAL COST PER REQUEST. THIS RE INSPECTION MUST BE DONE WITHIN 4 MONTHS OF THE ORIGINAL.

This property was not inspected for the presence or absence of health related molds or fungi. By California law, we are neither qualified, authorized, nor licensed to inspect for health related molds or fungi.

The Structural Pest Control board Mold Policy Statement is as follows:

"Molds, sometimes called mildew, are not wood-destroying organisms. Branch 3 licensees do not have a duty under the Structural Pest Control Act and related regulations to classify molds as harmful to human health or not harmful to human health. This does not modify the Structural Pest Control Act or related regulations."

STATE LAW REQUIRES THAT YOU BE GIVEN THE FOLLOWING INFORMATION CAUTION PESTICIDES ARE TOXIC CHEMICALS. STRUCTURAL PEST CONTROL OPERATORS ARE LICENSED AND REGULATED BY THE STRUCTURAL PEST CONTROL BOARD, AND APPLY PESTICIDES WHICH ARE REGISTERED AND APPROVED FOR USE BY CALIFORNIA DEPARTMENT OF FOOD AND AGRICULTURE AND THE UNITED STATES ENVIRONMENTAL PROTECTION AGENCY. REGISTRATION IS GRANTED WHEN THE STATE FINDS THAT BASED ON EXISTING SCIENTIFIC EVIDENCE THERE ARE NO APPRECIABLE RISKS IF PROPER USE CONDITIONS ARE FOLLOWED OR THAT THE RISKS ARE OUTWEIGHED BY THE BENEFITS. THE DEGREE OF RISK DEPENDS UPON THE DEGREE OF EXPOSURE, SO EXPOSURE SHOULD BE MINIMIZED.

29404

Alpine Drive, Cold Springs CA 95335

8/12/2024

27321

BUILDING NO.

STREET, CITY, STATE, ZIP

INSPECTION DATE

REPORT NO.

IF WITHIN 24 HOURS FOLLOWING APPLICATION YOU EXPERIENCE SYMPTOMS SIMILAR TO COMMON SEASONAL ILLNESS COMPARABLE TO THE FLU, CONTACT YOUR PHYSICIAN OR POISON CONTROL CENTER AND YOUR PEST CONTROL OPERATOR IMMEDIATELY.

FOR FURTHER INFORMATION CONTACT ANY OR THE FOLLOWING:

BEST PEST SIERRA - (209) 536-4615

POISON CONTROL CENTER - (800) 876-4766

COUNTY HEALTH DEPARTMENT

TUOLUMNE COUNTY HEALTH OFFICE - (209) 533-7401

SAN JOAQUIN COUNTY HEALTH OFFICE - (209) 468-3411

STANISLAUS COUNTY HEALTH OFFICE - (209) 558-8804

MERCED COUNTY HEALTH OFFICE - (209) 381-1100

COUNTY AGRICULTURE COMMISSIONER

TUOLUMNE COUNTY - (209) 533-5691

SAN JOAQUIN COUNTY - (209) 468-3300

STANISLAUS COUNTY - (209) 525-4730

MERCED COUNTY - (209) 385-7411

STRUCTURAL PEST CONTROL BOARD - (800) 737-8188

One or more of the following chemicals may be applied to your property: AggresZor 75 (Imidacloprid) Premise 75 Insecticide (Imidacloprid) - Tim-Bor (Disodium Octaborate Tetrahydrate) Termidor (Fipronil) - Vikane (Sulfuryl Fluoride) - I-MaxxPro (Imidacloprid) Termidor HE (Fipronil) Termidor SC (Fipronil) Premise Foam (Imidi



BEST PEST
SIERRA

P.O. Box 3731
Sonora, CA 95370
Tel: (209) 536-4615
www.bestpestsierra.com
Email: bestpestsierra@gmail.com

WORK AUTHORIZATION CONTRACT

Address of Property: 29404 Alpine Drive, Cold Springs CA 95335
Inspection Date: 8/12/2024
Report #: 27321
Title Co. & Escrow #:

SECTION 1
11A \$ 3695.00

SECTION 2
1A \$ 195.00
10A \$ 95.00

FURTHER INSPECTION

We Authorized the Following
Section 1 Items to be Performed.

11A

We Authorized the Following
Section 2 Items to be Performed.

1A, 10A

We Authorized the Following
Items for Further Inspection.

Proposed Cost Section 1: \$3,695.00

Proposed Cost Section 2: \$290.00
Total: \$3,985.00

Proposed Cost Fur.Insp.: \$0.00

If all items above are not being requested to be completed by Best Pest Sierra, indicate below the items you are requesting to have completed. **As a reminder, our job minimum requirement is \$895. If the below total cost does not meet our job minimum, we are not able to schedule the repairs.**

Items: _____

Total Cost: _____

Printed Name: _____ Signature: _____

Phone Number: _____ Email Address: _____

I have read this work authorization contract and WDO inspection report it refers to.
SIGNED WORK AUTHORIZATION CONTRACT MUST BE RECEIVED BEFORE WORK WILL BE SCHEDULED.
I have read and understand the terms of this work authorization contract and hereby agree to all

Manuel Palayudo
APPROVED AND READ BY:

8/17/2024
DATE

ACCEPTED FOR:
BEST PEST SIERRA

DATE

INVOICE



P.O. Box 3731
Sonora, CA 95370
Tel: (209) 536-4615
www.bestpestsierra.com
Email: bestpestsierra@gmail.com

DATE REPORT # ESCROW #
09/04/2024 27321

PROPERTY LOCATION
29404 Alpine Drive, Cold Springs CA 95335

TO: Manuel Palazuelos
29404 Alpine Drive
Cold Springs, CA 95335

08/12/2024	Inspection	\$120.00
08/13/2024	Payment	-\$120.00
09/04/2024	Payment	-\$3,985.00
09/04/2024	Completion	\$3,985.00

Balance Due: \$0.00

RETURN THIS COPY WITH REMITTANCE

**THIS IS AN INVOICE FOR A TERMITE INSPECTION PERFORMED BY BEST PEST SIERRA
DUE AND PAYABLE WITHIN 10 DAYS**

1.5% per month charged on all past due accounts. This is an annual percentage rate of 18%
NOTICE: "Under the Mechanics'Lien law, any contractor, subcontractor, laborer, supplier or other person who helps to improve your property but is not paid for his work or supplies, has the right to enforce a claim against your property. This means that after a court hearing, your property could be sold by a court officer and the proceeds of the sale used to satisfy the indebtedness. This can happen even if you have paid your own contractor in full, if the subcontractor, laborer, or supplier remains unpaid."

THANK YOU FOR YOUR BUSINESS