



# PROPERTY PROFILE

Date: 07/21/2024  
Property: CA  
APN: 341-280-10-00-7  
County: KERN

## Subject Property Location

Property Address

City, State &amp; Zip

, CA

County

KERN COUNTY

Mailing Address

Census Tract

Thomas Bros Pg-Grid

Report Date: 07/21/2024

Order ID: R154755803

Property Use

Residential - Vacant Land

Parcel Number

341-280-10-00-7

Latitude

35.577166

Longitude

-117.858346

Legal Description Details Lot Number: 1 Brief Description: PARCEL MAP 2864, LOT 1 Recorder's Map Ref: PM 2864

## Current Ownership Information \*Source of Ownership data: Recorder Information

Primary Owner Name(s)	MAO DEVELOPERS LLC,	Sale Price	\$1,250
		Sale Date	
		Recording Date	04/13/2023
Vesting		Recorder Doc #	223043785
		Book/Page	

## Latest Full Sale Information

Primary Owner Name(s)	CROMBIE, DEAN	Sale Price	\$4,000
		Sale Date	12/30/2002
		Recording Date	01/06/2003
Vesting		Recorder Doc #	0203002024
		Book/Page	



## Financing Details at Time of Purchase

No financing details available

## Property Characteristics

	Bedrooms		Year Built		Living Area (SF)	0
	Bathrooms/Partial		Garage/No. of Cars		Price (\$/SF)	
	Total Rooms		Stories/Floors		Lot Size (SF/AC)	116,305/2.67
	Construction Type		No. of Units		Fireplace	
	Exterior Walls		No. of Buildings		Pool	
	Roof Material/Type		Basement Type/Area		Heat Type	
	Foundation Type		Style		A/C	
	Property Type	Vacant Land	View		Elevator	
	Land Use	Residential - Vacant Land			Zoning	

## Assessment & Taxes

	Assessment Year	2023	Tax Year	2023	Tax Exemption	
	Total Assessed Value	\$5,556	Tax Amount	\$60.36	Tax Rate Area	111-009
	Land Value	\$5,556	Tax Account ID			
	Improvement Value		Tax Status	Delinquent		
	Improvement Ratio		Delinquent Tax Year	2023		
	Total Value			Market Improvement Value		
	Market Land Value			Market Value Year		

## Lien History

Trans. ID	Recording Date	Lender	Amount	Purchase Money
No details available				



Subject Property Location

Property Address

City, State & Zip , CA

Report Date: 07/21/2024

Order ID: R154755804

County: KERN

## Comparable Sales

No comparable sales found for subject property with selected filter criteria.

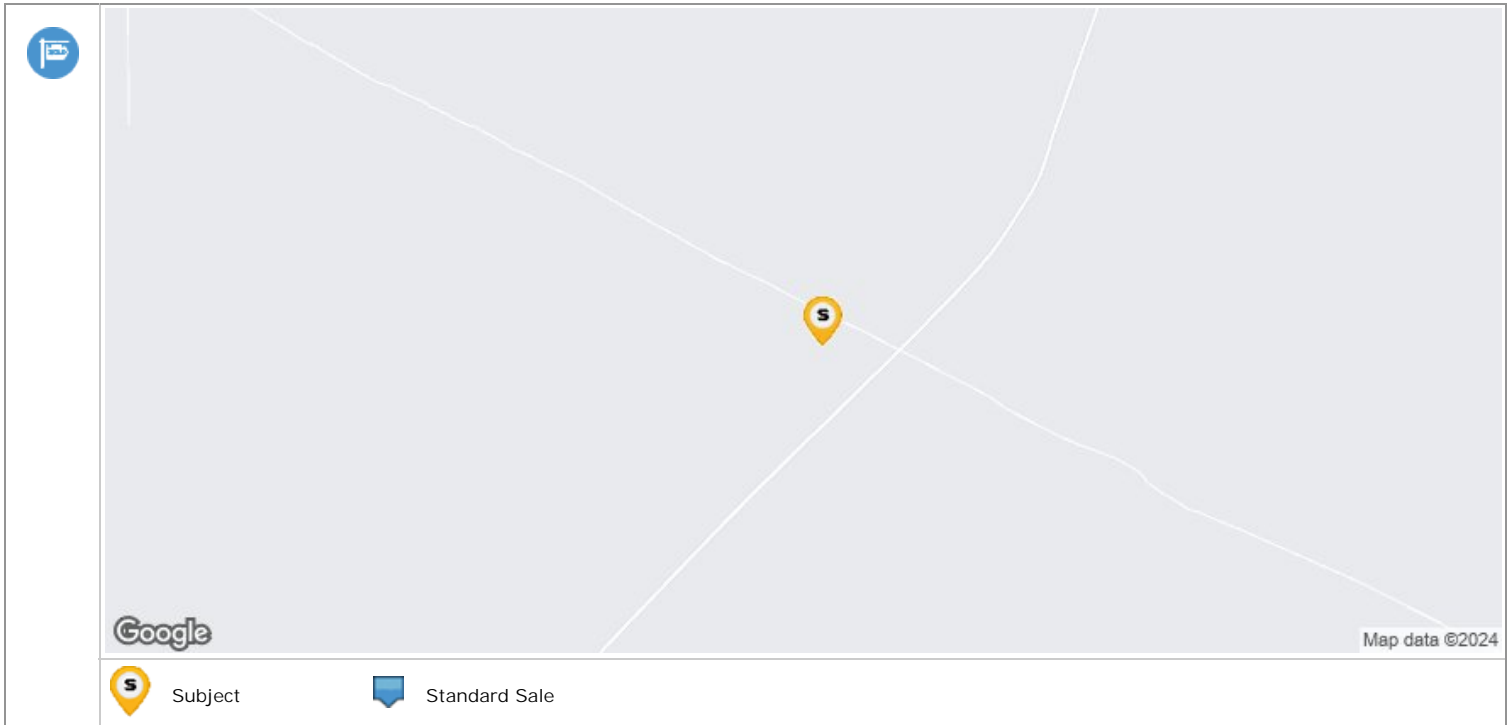

## Subject Property Location

Property Address

City, State &amp; Zip

, CA

County

KERN COUNTY

Mailing Address

Report Date: 07/21/2024

Order ID: R154755805

Property Use

Residential - Vacant Land





Parcel Number

341-280-10-00-7



## Transaction Summary

Trans ID	Recording Date	Document Type	Document Description	Sale Price / Loan Amount	Document Number	Buyer / Borrower	Seller
1	04/13/2023	Deed	Public Action or Sold for Taxes	\$1,250	223043785	MAQ DEVELOPERS LLC	DEAN, CROMBIE
2	01/06/2003	Deed	Grant Deed	\$4,000	0203002024	CROMBIE, DEAN	MERIT LAND INVESTMENT CO LLC
3	02/05/2001	Deed	Public Action or Sold for Taxes	\$550	0201015372	MERIT LAND INVESTMENT CO LLC	HAUSEUR, ROBERT W
4		Deed					

## Transaction History Legend

	Transfer		Mortgage		Mortgage Assignment
	Foreclosure Activity		Mortgage Release		

## Transaction Details

Transfer						
	Transaction ID	1	Recorder Doc Number	223043785	Partial Interest Transferred	
	Sale Date	04/11/2023	Document Type	Deed	Type of Transaction	Forced Sale
	Sale Price	\$1,250	Document Description	Public Action or Sold for Taxes	Multiple APNs on Deed	
	Recorder Book/Page		Recording Date	04/13/2023	Property Use	
	Buyer 1	MAQ DEVELOPERS LLC	Buyer 1 Entity	Limited Liability Company	Buyer Vesting	
	Buyer 2		Buyer 2 Entity		Buyer Mailing Address	
	Seller 1	DEAN, CROMBIE	Seller 1 Entity	Trustor or Debtor	Seller Mailing Address	
	Seller 2		Seller 2 Entity		Legal City/ Muni/ Township	UNINCORPORATED
	Legal Recorder's Map Ref	MB 13 PG 45	Legal Subdivision	PARCEL MAP 2864	Legal Section/ Twn/ Rng/ Mer	
	Legal Brief Description/ Unit/ Phase/ Tract					Title Company Name
Transfer						
	Transaction ID	2	Recorder Doc Number	0203002024	Partial Interest Transferred	
	Sale Date	12/30/2002	Document Type	Deed	Type of Transaction	Arms-Length Transfer
	Sale Price	\$4,000	Document Description	Grant Deed	Multiple APNs on Deed	
	Recorder Book/Page		Recording Date	01/06/2003	Property Use	
	Buyer 1	CROMBIE, DEAN	Buyer 1 Entity	Individual	Buyer Vesting	
	Buyer 2		Buyer 2 Entity		Buyer Mailing Address	2225 COUNTRY VILLA CT, AUBURN, CA 95603-9002

	Seller 1	MERIT LAND INVESTMENT CO LLC	Seller 1 Entity	Company or Corporation	Seller Mailing Address	
	Seller 2		Seller 2 Entity		Legal City/ Muni/ Township	UNINCORPORATED
	Legal Recorder's Map Ref	PM2864	Legal Subdivision		Legal Section/ Twn/ Rng/ Mer	
	Legal Brief Description/ Unit/ Phase/ Tract				Title Company Name	
Transfer						
	Transaction ID	3	Recorder Doc Number	0201015372	Partial Interest Transferred	
	Transfer Date	01/25/2001	Document Type	Deed	Type of Transaction	Non Arms-Length Transfer
	Sale Price	\$550	Document Description	Public Action or Sold for Taxes	Multiple APNs on Deed	
	Recorder Book/Page		Recording Date	02/05/2001	Property Use	
	Buyer 1	MERIT LAND INVESTMENT CO LLC	Buyer 1 Entity	Beneficiary or Creditor	Buyer Vesting	
	Buyer 2		Buyer 2 Entity		Buyer Mailing Address	PO BOX 6367, ALTADENA, CA 91003-6367
	Seller 1	HAUSEUR, ROBERT W	Seller 1 Entity	Trustor or Debtor	Seller Mailing Address	
	Seller 2		Seller 2 Entity		Legal City/ Muni/ Township	
	Legal Recorder's Map Ref	PM2864	Legal Subdivision		Legal Section/ Twn/ Rng/ Mer	
	Legal Brief Description/ Unit/ Phase/ Tract				Title Company Name	
Transfer						
	Transaction ID	4	Recorder Doc Number		Partial Interest Transferred	
	Transfer Date		Document Type	Deed	Type of Transaction	Per Assessor
	Sale Price		Document Description		Multiple APNs on Deed	
	Recorder Book/Page		Recording Date		Property Use	Residential - Vacant Land
	Buyer 1		Buyer 1 Entity		Buyer Vesting	
	Buyer 2		Buyer 2 Entity		Buyer Mailing Address	
	Seller 1		Seller 1 Entity		Seller Mailing Address	
	Seller 2		Seller 2 Entity		Legal City/ Muni/ Township	
	Legal Recorder's Map Ref		Legal Subdivision		Legal Section/ Twn/ Rng/ Mer	
	Legal Brief Description/ Unit/ Phase/ Tract		PARCEL MAP 2864, LOT 1/ / /		Title Company Name	



Subject Property Location

Report Date: 07/21/2024  
Order ID: R154755806

Property Address  
City, State & Zip                   , CA  
County                               KERN COUNTY  
Mailing Address  
Owner Name                       MAQ DEVELOPERS LLC,

Property Use                       Residential - Vacant Land  
Parcel Number                   341-280-10-00-7

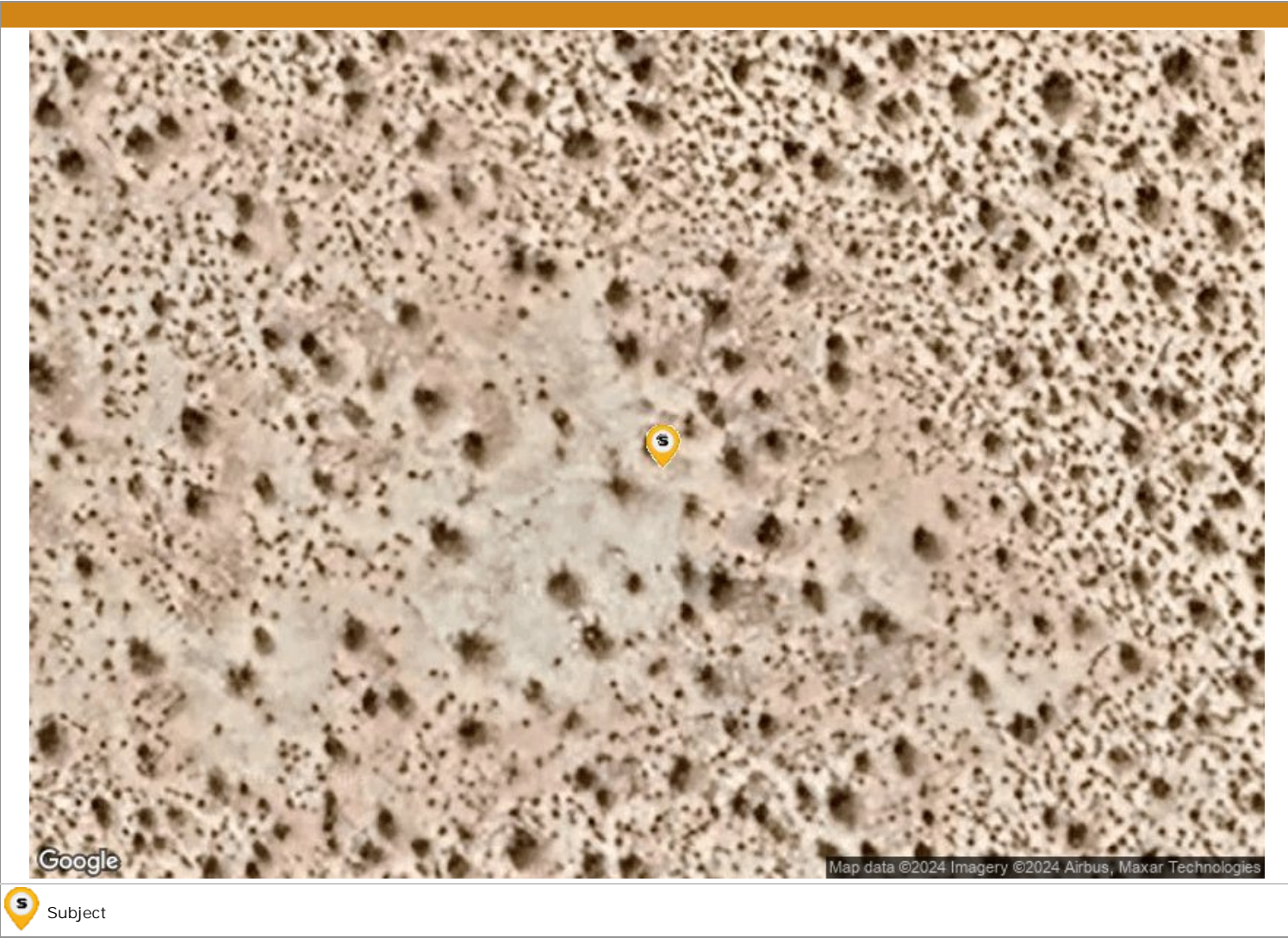

## Subject Property Location

Report Date: 07/21/2024

Property Address

Order ID: R154755807

City, State &amp; Zip

, CA

County

KERN COUNTY

Property Use

Residential - Vacant Land

Mailing Address

Parcel Number

341-280-10-00-7

## Nearby Neighbors

No Nearby Neighbors Found.



Subject Property Location

Property Address

City, State & Zip

County

, CA

KERN COUNTY

Report Date: 07/21/2024

Order ID: R154755808

Parcel Number

341-280-10-00-7

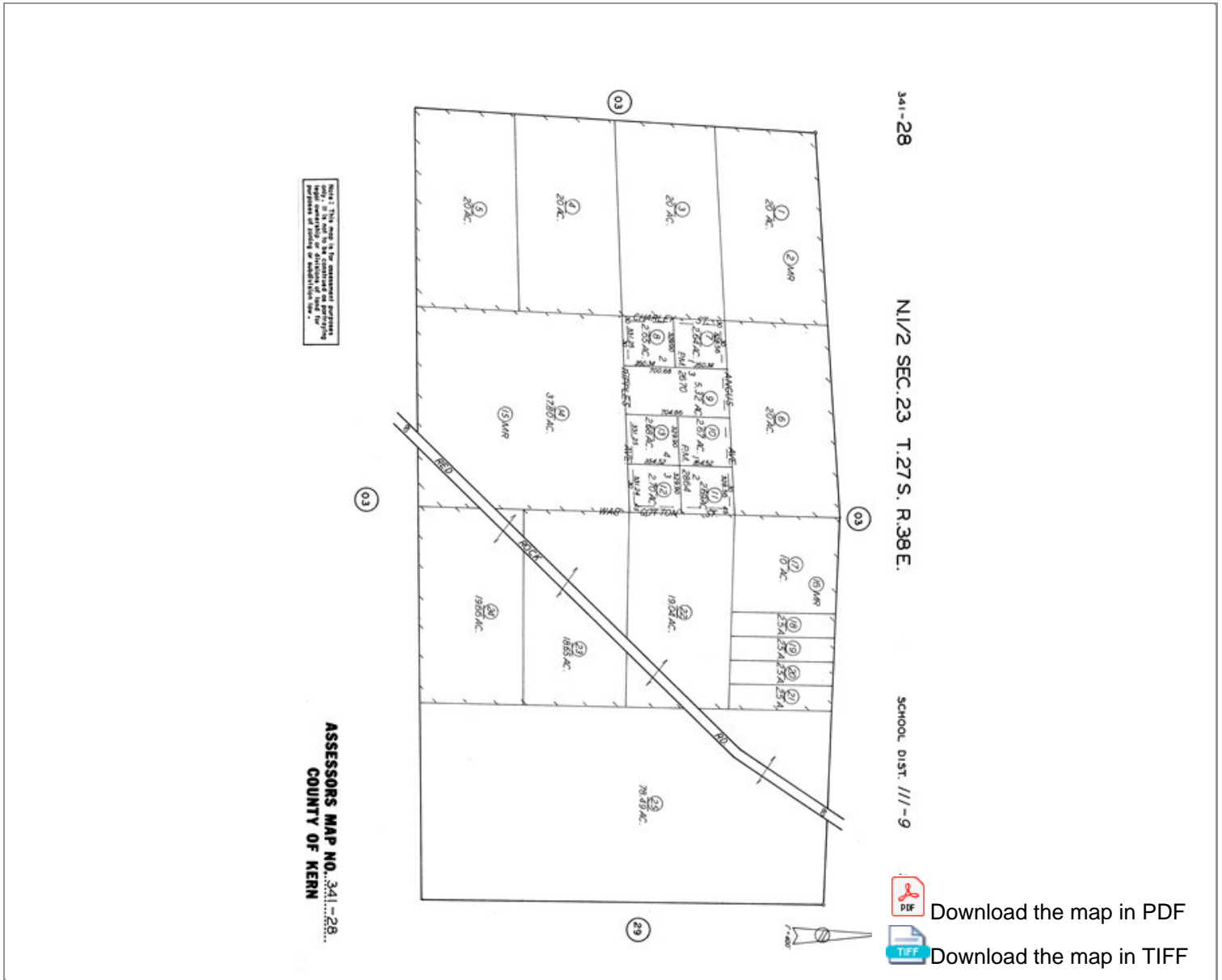

**Disclaimer**

THIS REPORT IS INTENDED FOR USE BY YOU AS AN END USER SOLELY FOR YOUR INTERNAL BUSINESS PURPOSES. YOU SHALL NOT RESELL, RELICENSE OR REDISTRIBUTE THIS REPORT, IN WHOLE OR IN PART. THE USE OF THIS REPORT BY ANY PARTY OTHER THAN YOURSELF FOR ANY PURPOSE IS STRICTLY PROHIBITED. THIS REPORT IS PROVIDED AS-IS WITHOUT WARRANTY OF ANY KIND, EITHER EXPRESS OR IMPLIED, INCLUDING WITHOUT LIMITATION, ANY WARRANTIES OF MERCHANTABILITY, NON-INFRINGEMENT, OR FITNESS FOR A PARTICULAR PURPOSE. INTERCONTINENTAL EXCHANGE, INC. (ICE) SHALL HAVE NO LIABILITY IN CONTRACT, TORT, OR OTHERWISE ARISING OUT OF OR IN CONNECTION WITH THIS REPORT. ICE DOES NOT REPRESENT OR WARRANT THAT THE REPORT IS COMPLETE OR FREE FROM ERROR. YOU UNDERSTAND AND ACKNOWLEDGE THAT THE AVAILABILITY, COMPLETENESS AND FORMAT OF THE DATA ELEMENTS MAY VARY SUBSTANTIALLY FROM AREA-TO-AREA. THE INFORMATION CONTAINED IN THIS REPORT IS DERIVED FROM PUBLICLY AVAILABLE SOURCES FOR THE SUBJECT PROPERTY OR COMPARABLE PROPERTIES LISTED ABOVE AND HAS NOT BEEN INDEPENDENTLY VERIFIED BY ICE THROUGH ANY FORM OF INSPECTION OR REVIEW. THIS REPORT DOES NOT CONSTITUTE AN APPRAISAL OF ANY KIND AND SHOULD NOT BE USED IN LIEU OF AN INSPECTION OF A SUBJECT PROPERTY BY A LICENSED OR CERTIFIED APPRAISER. THIS REPORT CONTAINS NO REPRESENTATIONS, OPINIONS OR WARRANTIES REGARDING THE SUBJECT PROPERTY'S ACTUAL MARKETABILITY, CONDITION (STRUCTURAL OR OTHERWISE), ENVIRONMENTAL, HAZARD OR FLOOD ZONE STATUS, AND ANY REFERENCE TO ENVIRONMENTAL, HAZARD OR FLOOD ZONE STATUS IS FOR INFORMATIONAL PURPOSES ONLY AND SHALL BE INDEPENDENTLY VERIFIED BY THE END USER. THE INFORMATION CONTAINED HEREIN SHALL NOT BE UTILIZED: (A) TO REVIEW OR ESTABLISH A CONSUMER'S CREDIT AND/OR INSURANCE ELIGIBILITY OR FOR ANY OTHER PURPOSE THAT WOULD CAUSE THE REPORT TO CONSTITUTE A "CONSUMER REPORT" UNDER THE FAIR CREDIT REPORTING ACT, 15 U.S.C. § 1681 ET SEQ.; OR (B) IN CONNECTION WITH CERTIFICATION OR AUTHENTICATION OF REAL ESTATE OWNERSHIP AND/OR REAL ESTATE TRANSACTIONS. ADDITIONAL TERMS AND CONDITIONS SHALL APPLY PURSUANT TO THE APPLICABLE AGREEMENT.

