

- LEGEND
- FILL SLOPE (2:1 MAX.)
  - CUT SLOPE (2:1 MAX.)
  - RETAINING WALL (6' MAX.)
  - LEACH FIELD
  - CATCH BASIN W/ FILTER INSERT FOR SUSMP
  - CATCH BASIN
  - STORM DRAIN
  - RIP RAP
  - FIRE HYDRANT
  - WATER LINE
  - BUILDING ENVELOPE

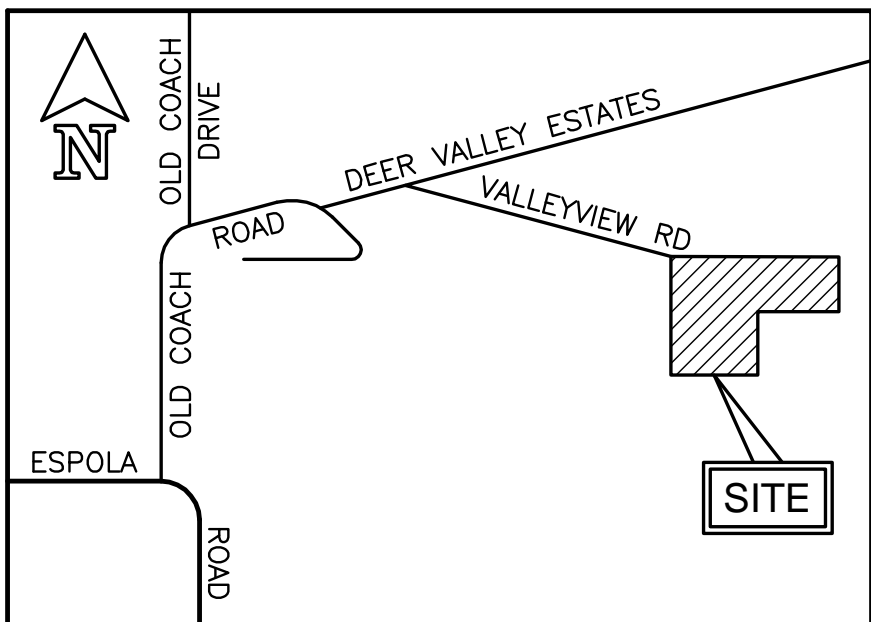

## CITY OF POWAY TENTATIVE MAP NO. 02-02

### LEGAL DESCRIPTION

THE NORTHWEST QUARTER OF THE NORTHEAST QUARTER AND THE EAST HALF OF THE NORTHWEST QUARTER OF SECTION 20, TOWNSHIP 13 SOUTH, RANGE 1 WEST, SAN BERNARDINO BASE AND MERIDIAN, IN THE COUNTY OF SAN DIEGO, STATE OF CALIFORNIA, ACCORDING TO OFFICIAL PLAT THEREOF.

### GENERAL NOTES

GROSS AREA: 122+ ACRES  
EXISTING ZONING: RR-A  
PROPOSED ZONING: RR-A  
POWAY COMMUNITY PLAN DESIGNATION: RURAL RESIDENTIAL A  
TOTAL NO. OF PARCELS: 10 RESIDENTIAL  
THERE ARE NO SPECIAL ASSESSMENT ACT PROCEEDINGS PROPOSED.  
IMPROVEMENT, EASEMENTS, EROSION CONTROL, AND DEDICATION AS REQUIRED BY THE CITY ENGINEER.  
LAND USE SHALL CONFORM TO RR-A ZONING.  
MINIMUM PARCEL SIZE IS 4.00 ACRES  
FINISH GRADES AND DIMENSIONS SHOWN HEREON ARE NOT EXACT AND ARE SUBJECT TO MODIFICATION IN THE FINAL DESIGN.  
THIS IS A SOLAR SUBDIVISION AS REQUIRED BY SECTION 81.40 (N) SUBDIVISION ORDINANCE. ALL PARCELS HAVE AT LEAST 100 SQ. FT. OF UNDISTURBED ACCESS TO SUNLIGHT ON THE BUILDABLE PORTION OF THE PARCEL.  
UTILITIES: SEWER: PRIVATE SEPTIC SYSTEM  
WATER: CITY OF POWAY  
GAS & ELECTRIC: SAN DIEGO GAS & ELECTRIC  
TELEPHONE: SBC (FORMERLY "PACIFIC BELL")  
FIRE PROTECTION: CITY OF POWAY  
SCHOOLS: POWAY UNIFIED SCHOOL DISTRICT  
ASSESSOR'S PARCEL NUMBER: 277-080-09  
THIS IS A LOT AVERAGED SUBDIVISION AND NONE OF THE LOTS CAN BE FURTHER SUBDIVIDED

### TOPOGRAPHY INFORMATION

AERIAL TOPOGRAPHY BY ASAN-LO AERIAL SURVEYS. DATE FLOWN: 1-25-2001  
BENCH MARK  
CITY OF POWAY BENCHMARK #A-57. 2" DIA BRASS DISK STAMPED "POWAY A-57" IN TOP OF CURB APPROXIMATELY 3.0 FT. WESTERLY OF WEST POINT OF CURVE OF SOUTHWEST CURB RETURN OF ESPOLA ROAD AND BRIDLEWOOD ROAD. ELEV: 664.731 FEET

### SUSMP NOTES

CATCH BASINS WITH DRAINAGE INSERT ARE PROPOSED FOR STRUCTURAL BMP TO COMPLY WITH THE CITY'S SUSMP REGULATIONS. SEE LEGEND AND TENTATIVE MAP FOR LOCATIONS OF CATCH BASINS WITH DRAINAGE INSERT.

THE DRAINAGE INSERT SHALL BE DESIGNED TO TREAT RUNOFF ACCORDING TO CITY'S FLOW-BASED BMP STANDARDS. THE DRAINAGE INSERTS SHALL BE OR EQUIVALENT TO "FLOW-GARD PLUS" BY KRISTAR ENTERPRISES, INC.

LOT INFORMATION (ACRES)					
NO.	SIZE (AC)	AVG. SLOPE (%)	QUANTITY OF GRADING PERMITTED	AMOUNT OF GRADING PROPOSED	AMOUNT OF HABITAT DISTURBED
1	4.72	21.6	0.93	0.91	2.00
2	4.51	21.0	0.86	0.85	2.00
3	5.45	24.7	1.03	0.96	2.00
4	4.60	24.4	0.82	0.76	2.00
5	4.28	24.2	0.84	0.82	2.00
6	8.95	23.3	1.66	1.40	2.00
7	5.18	20.2	0.97	0.97	2.00
8	4.57	23.5	0.79	0.79	2.00
9	4.43	24.4	0.82	0.82	2.00
10	5.43	21.3	0.91	0.91	2.00
TOTAL	52.11	N/A	9.63	9.19	20.00

PREPARED FOR:  
BBA PARTNERS, LLC  
C/O GARY SABIN, ERIC OTTESEN, JOHN MCINN  
18525 Deer Valley Estates  
Poway, CA 92064  
(858) 487-3664

PREPARED BY:  
BILL YEN & ASSOCIATES, INC.  
CIVIL ENGINEERING SURVEYING SITE PLANNING  
13071 POWAY ROAD, POWAY, CA 92064-4519  
(858) 679-8010 FAX (858) 679-8015



WILLIAM YEN, RCE 33730 DATE