



PROPERTY PROFILE

Date: 07/21/2024
Property: CA 93505
APN: 302-243-10-00-1
County: KERN

Subject Property Location

Property Address

City, State & Zip , CA 93505

County KERN COUNTY

Mailing Address

Census Tract

Thomas Bros Pg-Grid

Report Date: 07/21/2024

Order ID: R154742929

Property Use

Residential - Vacant Land

Parcel Number

302-243-10-00-1

Latitude

35.088029

Longitude

-118.057496

Legal Description Details Sec/Twn/Rng/Mer: SEC 33 TWN 12 RNG 11 Brief Description: SECTION 33, TOWNSHIP 12, RANGE 11, QUARTER

Current Ownership Information *Source of Ownership data: Recorder Information

Primary Owner Name(s)	MAO DEVELOPERS LLC,	Sale Price	\$2,400
		Sale Date	
		Recording Date	04/13/2023
Vesting		Recorder Doc #	223043680
		Book/Page	

Latest Full Sale Information

Details beyond coverage limitations



Financing Details at Time of Purchase

No financing details available

Property Characteristics

	Bedrooms		Year Built		Living Area (SF)	0
	Bathrooms/Partial		Garage/No. of Cars		Price (\$/SF)	
	Total Rooms		Stories/Floors		Lot Size (SF/AC)	264,409/6.07
	Construction Type		No. of Units		Fireplace	
	Exterior Walls		No. of Buildings		Pool	
	Roof Material/Type		Basement Type/Area		Heat Type	
	Foundation Type		Style		A/C	
	Property Type	Vacant Land	View		Elevator	
	Land Use	Residential - Vacant Land			Zoning	O/RA

Assessment & Taxes

	Assessment Year	2023	Tax Year	2023	Tax Exemption	
	Total Assessed Value	\$1,600	Tax Amount	\$164.01	Tax Rate Area	11-039
	Land Value	\$1,600	Tax Account ID			
	Improvement Value		Tax Status	Delinquent		
	Improvement Ratio		Delinquent Tax Year	2023		
	Total Value			Market Improvement Value		
	Market Land Value			Market Value Year		

Lien History

Trans. ID	Recording Date	Lender	Amount	Purchase Money
No details available				

Loan Officer Insights

No details available

Subject Property Location

Property Address

City, State & Zip , CA 93505

Report Date: 07/21/2024

Order ID: R154742930

County: KERN

Comparable Sales

No comparable sales found for subject property with selected filter criteria.

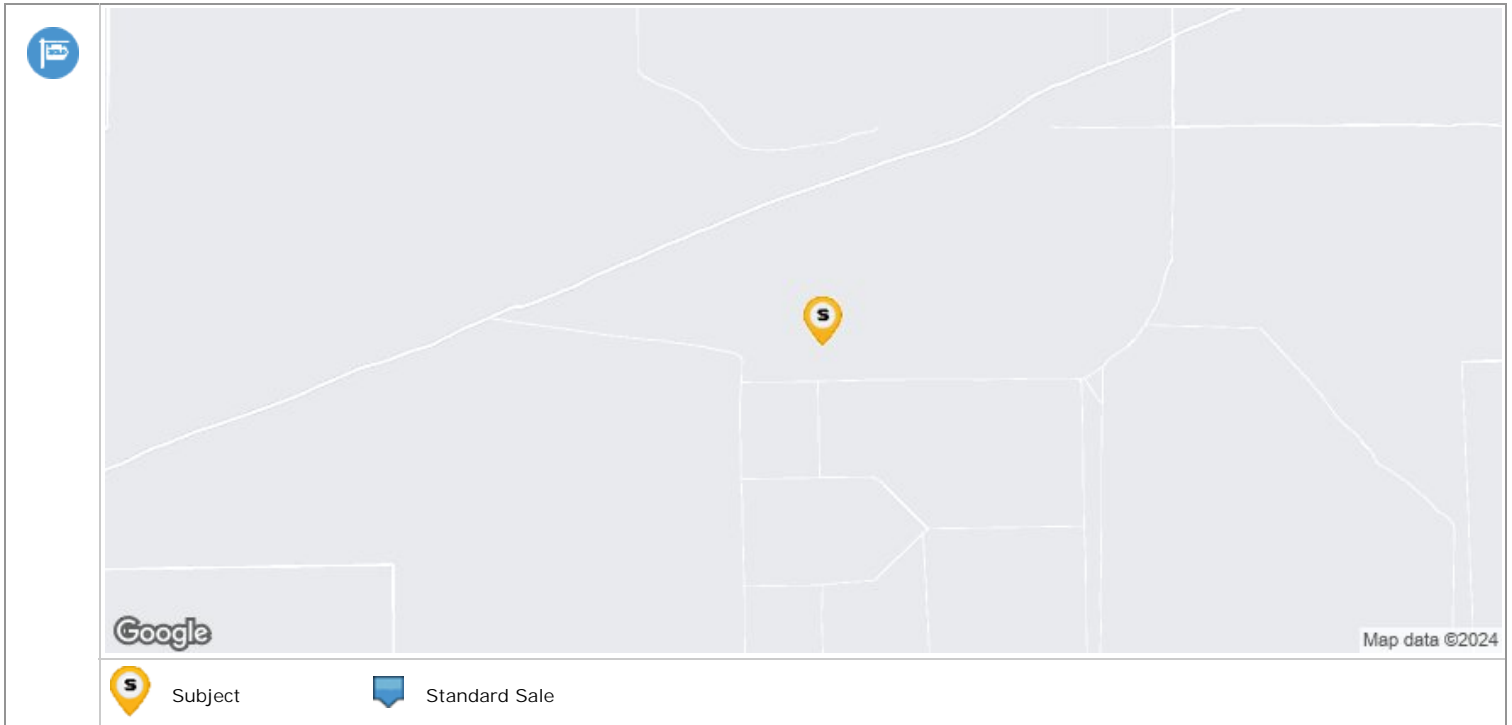

Subject Property Location

Property Address

City, State & Zip

County

Mailing Address

, CA 93505

KERN COUNTY

Report Date: 07/21/2024

Order ID: R154742931

Property Use

Parcel Number





Residential - Vacant Land

302-243-10-00-1



Transaction Summary



Trans ID	Recording Date	Document Type	Document Description	Sale Price / Loan Amount	Document Number	Buyer / Borrower	Seller
1	04/13/2023	Deed	Public Action or Sold for Taxes	\$2,400	223043680	MAQ DEVELOPERS LLC	HELMAND, ROBERT B
2	12/30/2009	Deed	Intra-family Transfer or Dissolution		0209190610	HELMAND, ROBERT B	HELMAND, ROBERT B; PACIFIC LAND MONEY PURCHASE PENSION PLAN; PACIFIC LAND EXCHANGE PENSION TRUST; HELMAND, BASHER
3	03/23/2005	Deed	Quit Claim Deed (non-arm's length)		0205070940	HELMAND, ROBERT B; PACIFIC LAND EXCHANGE PENSION TRUST; AHMAD, BASHER	PALISADES LUTHERAN CHURCH
4	12/30/2002	Deed	Grant Deed		0202220698	PALISADES LUTHERAN CHURCH	HELMAND, ROBERT B; AHMAD, BASHER

Transaction History Legend

	Transfer		Mortgage		Mortgage Assignment
	Foreclosure Activity		Mortgage Release		

Transaction Details

Transfer						
	Transaction ID	1	Recorder Doc Number	223043680	Partial Interest Transferred	
	Sale Date	04/11/2023	Document Type	Deed	Type of Transaction	Forced Sale
	Sale Price	\$2,400	Document Description	Public Action or Sold for Taxes	Multiple APNs on Deed	
	Recorder Book/Page		Recording Date	04/13/2023	Property Use	
	Buyer 1	MAQ DEVELOPERS LLC	Buyer 1 Entity	Limited Liability Company	Buyer Vesting	
	Buyer 2		Buyer 2 Entity		Buyer Mailing Address	
	Seller 1	HELMAND, ROBERT B	Seller 1 Entity	Trustor or Debtor	Seller Mailing Address	
	Seller 2		Seller 2 Entity		Legal City/ Muni/ Township	UNINCORPORATED
	Legal Recorder's Map Ref		Legal Subdivision		Legal Section/ Twn/ Rng/ Mer	W2E2SW4SW4 S33T12NR11W SBBM
	Legal Brief Description/ Unit/ Phase/ Tract				Title Company Name	NONE AVAILABLE
Transfer						
	Transaction ID	2	Recorder Doc Number	0209190610	Partial Interest Transferred	
	Transfer Date	12/14/2009	Document Type	Deed	Type of Transaction	Non Arms-Length Transfer
	Sale Price		Document Description	Intra-family Transfer or Dissolution	Multiple APNs on Deed	5

	Recorder Book/Page		Recording Date	12/30/2009	Property Use	
	Buyer 1	HELMAND, ROBERT B	Buyer 1 Entity	Single man	Buyer Vesting	
	Buyer 2		Buyer 2 Entity		Buyer Mailing Address	170 S MAIN ST STE 750, SALT LAKE CITY, UT 84101-1635
	Seller 1	HELMAND, ROBERT B	Seller 1 Entity	Trustee or Conservator	Seller Mailing Address	170 S MAIN ST # 750, SALT LAKE CITY, UT 84101-1635
	Seller 2	PACIFIC LAND MONEY PURCHASE PENSION PLAN	Seller 2 Entity	Minor, Ward or Client (Represented by Trustee)	Legal City/ Muni/ Township	
	Legal Recorder's Map Ref		Legal Subdivision		Legal Section/ Twn/ Rng/ Mer	W2E2SW4SW4 S33T12NR11W SBBM
	Legal Brief Description/ Unit/ Phase/ Tract				Title Company Name	NONE AVAILABLE
Transfer						
	Transaction ID	3	Recorder Doc Number	0205070940	Partial Interest Transferred	
	Transfer Date	02/10/2005	Document Type	Deed	Type of Transaction	Non Arms-Length Transfer
	Sale Price		Document Description	Quit Claim Deed (non-arm's length)	Multiple APNs on Deed	4
	Recorder Book/Page		Recording Date	03/23/2005	Property Use	
	Buyer 1	HELMAND, ROBERT B	Buyer 1 Entity	Trustee or Conservator	Buyer Vesting	Trust
	Buyer 2	PACIFIC LAND EXCHANGE PENSION TRUST	Buyer 2 Entity	Company or Corporation	Buyer Mailing Address	170 S MAIN ST STE 575, SALT LAKE CITY, UT 84101-1670
	Seller 1	PALISADES LUTHERAN CHURCH	Seller 1 Entity	Company or Corporation	Seller Mailing Address	
	Seller 2		Seller 2 Entity		Legal City/ Muni/ Township	UNINCORPORATED
	Legal Recorder's Map Ref		Legal Subdivision		Legal Section/ Twn/ Rng/ Mer	W2E2SW4SW4 S33T12NR11W SBBM
	Legal Brief Description/ Unit/ Phase/ Tract		EXCEPTING THEREFROM S2 S05 AC/ / /		Title Company Name	
Transfer						
	Transaction ID	4	Recorder Doc Number	0202220698	Partial Interest Transferred	
	Transfer Date	12/17/2002	Document Type	Deed	Type of Transaction	Non Arms-Length Transfer
	Sale Price		Document Description	Grant Deed	Multiple APNs on Deed	9
	Recorder Book/Page		Recording Date	12/30/2002	Property Use	
	Buyer 1	PALISADES LUTHERAN CHURCH	Buyer 1 Entity	Company or Corporation	Buyer Vesting	
	Buyer 2		Buyer 2 Entity		Buyer Mailing Address	15905 W SUNSET BLVD, PACIFIC PALISADES, CA 90272-3407
	Seller 1	HELMAND, ROBERT B	Seller 1 Entity	Single man	Seller Mailing Address	
	Seller 2	AHMAD, BASHER	Seller 2 Entity	f/k/a (formerly known as)	Legal City/ Muni/ Township	UNINCORPORATED
	Legal Recorder's Map Ref		Legal Subdivision		Legal Section/ Twn/ Rng/ Mer	W2E2SW4SW4 S33T12NR11W SBBM
	Legal Brief Description/ Unit/ Phase/ Tract				Title Company Name	

Subject Property Location

Report Date: 07/21/2024
Order ID: R154742932

Property Address
City, State & Zip, CA 93505
CountyKERN COUNTY
Mailing Address
Owner NameMAQ DEVELOPERS LLC,

Property UseResidential - Vacant Land
Parcel Number302-243-10-00-1

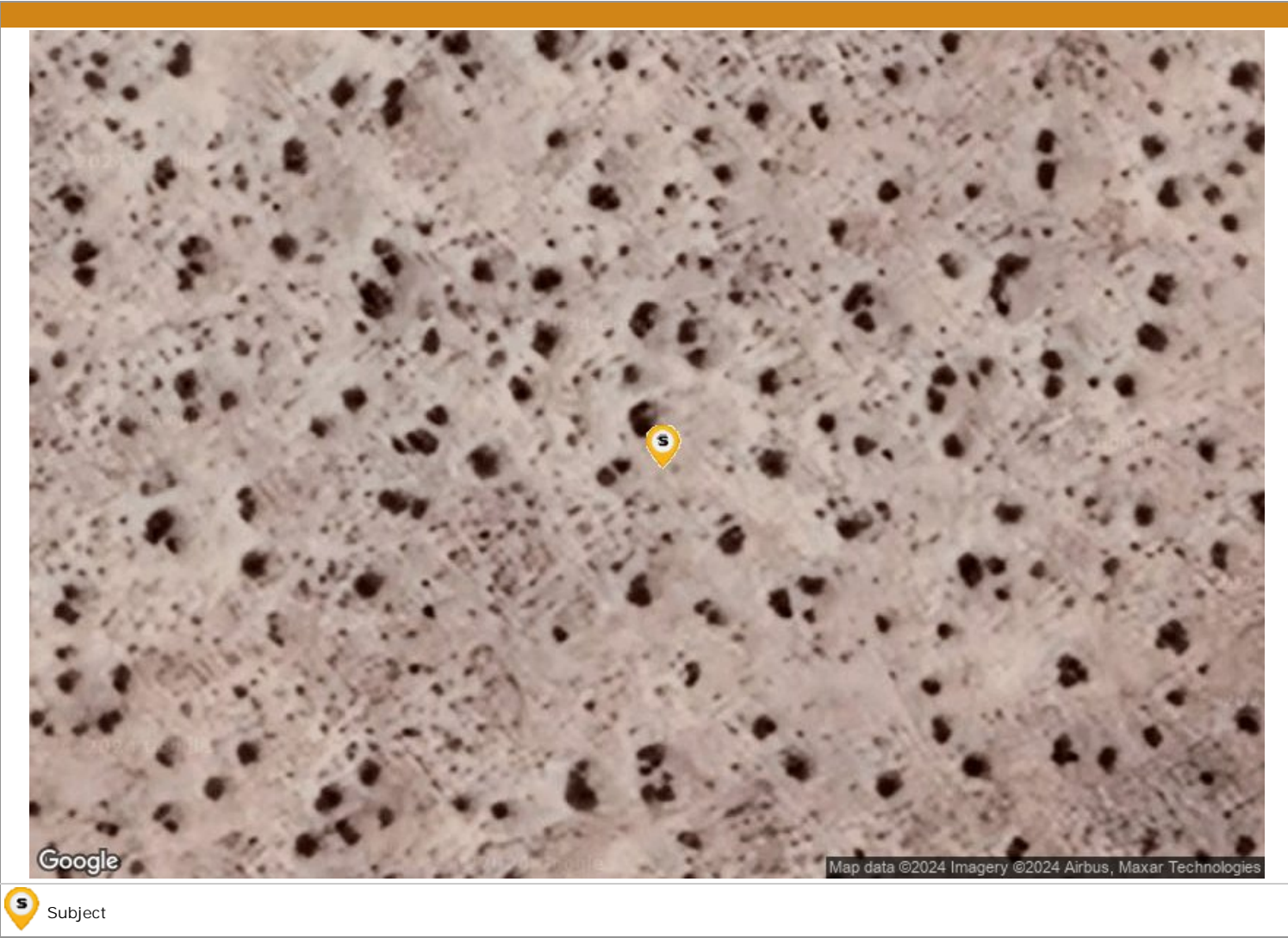

Subject Property Location

Property Address

City, State & Zip , CA 93505

County KERN COUNTY

Mailing Address

Report Date: 07/21/2024

Order ID: R154742933

Property Use

Residential - Vacant Land

Parcel Number

302-243-10-00-1

Nearby Neighbors

No Nearby Neighbors Found.

Subject Property Location

Property Address

City, State & Zip

County

, CA 93505

KERN COUNTY

Report Date: 07/21/2024

Order ID: R154742934

Parcel Number

302-243-10-00-1

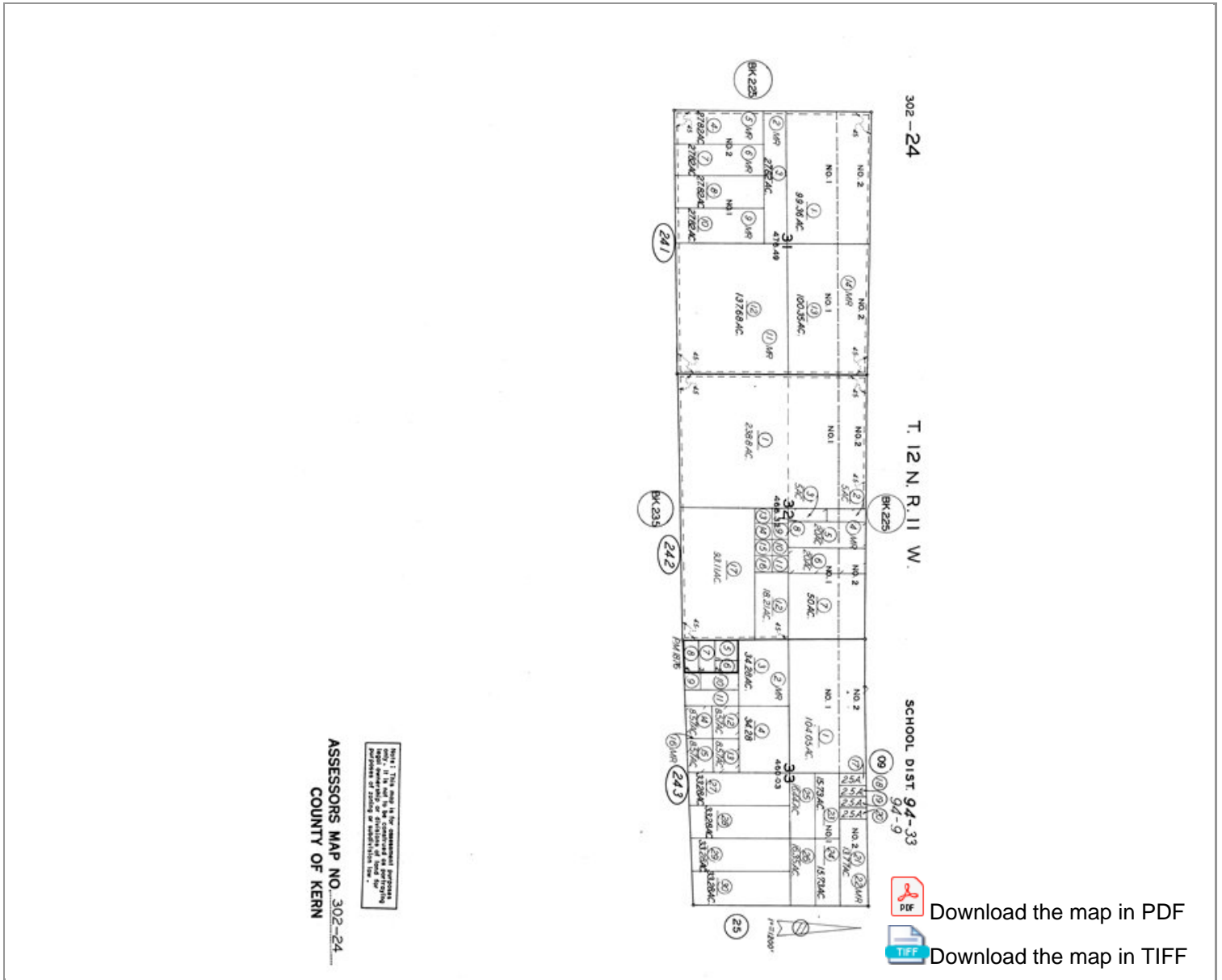

Disclaimer

THIS REPORT IS INTENDED FOR USE BY YOU AS AN END USER SOLELY FOR YOUR INTERNAL BUSINESS PURPOSES. YOU SHALL NOT RESELL, RELICENSE OR REDISTRIBUTE THIS REPORT, IN WHOLE OR IN PART. THE USE OF THIS REPORT BY ANY PARTY OTHER THAN YOURSELF FOR ANY PURPOSE IS STRICTLY PROHIBITED. THIS REPORT IS PROVIDED AS-IS WITHOUT WARRANTY OF ANY KIND, EITHER EXPRESS OR IMPLIED, INCLUDING WITHOUT LIMITATION, ANY WARRANTIES OF MERCHANTABILITY, NON-INFRINGEMENT, OR FITNESS FOR A PARTICULAR PURPOSE. INTERCONTINENTAL EXCHANGE, INC. (ICE) SHALL HAVE NO LIABILITY IN CONTRACT, TORT, OR OTHERWISE ARISING OUT OF OR IN CONNECTION WITH THIS REPORT. ICE DOES NOT REPRESENT OR WARRANT THAT THE REPORT IS COMPLETE OR FREE FROM ERROR. YOU UNDERSTAND AND ACKNOWLEDGE THAT THE AVAILABILITY, COMPLETENESS AND FORMAT OF THE DATA ELEMENTS MAY VARY SUBSTANTIALLY FROM AREA-TO-AREA. THE INFORMATION CONTAINED IN THIS REPORT IS DERIVED FROM PUBLICLY AVAILABLE SOURCES FOR THE SUBJECT PROPERTY OR COMPARABLE PROPERTIES LISTED ABOVE AND HAS NOT BEEN INDEPENDENTLY VERIFIED BY ICE THROUGH ANY FORM OF INSPECTION OR REVIEW. THIS REPORT DOES NOT CONSTITUTE AN APPRAISAL OF ANY KIND AND SHOULD NOT BE USED IN LIEU OF AN INSPECTION OF A SUBJECT PROPERTY BY A LICENSED OR CERTIFIED APPRAISER. THIS REPORT CONTAINS NO REPRESENTATIONS, OPINIONS OR WARRANTIES REGARDING THE SUBJECT PROPERTY'S ACTUAL MARKETABILITY, CONDITION (STRUCTURAL OR OTHERWISE), ENVIRONMENTAL, HAZARD OR FLOOD ZONE STATUS, AND ANY REFERENCE TO ENVIRONMENTAL, HAZARD OR FLOOD ZONE STATUS IS FOR INFORMATIONAL PURPOSES ONLY AND SHALL BE INDEPENDENTLY VERIFIED BY THE END USER. THE INFORMATION CONTAINED HEREIN SHALL NOT BE UTILIZED: (A) TO REVIEW OR ESTABLISH A CONSUMER'S CREDIT AND/OR INSURANCE ELIGIBILITY OR FOR ANY OTHER PURPOSE THAT WOULD CAUSE THE REPORT TO CONSTITUTE A "CONSUMER REPORT" UNDER THE FAIR CREDIT REPORTING ACT, 15 U.S.C. § 1681 ET SEQ.; OR (B) IN CONNECTION WITH CERTIFICATION OR AUTHENTICATION OF REAL ESTATE OWNERSHIP AND/OR REAL ESTATE TRANSACTIONS. ADDITIONAL TERMS AND CONDITIONS SHALL APPLY PURSUANT TO THE APPLICABLE AGREEMENT.

