



LANIK ENTERPRISES INC.

SEPTIC TANK CERTIFICATIONS
P.O. BOX 891416
TEMECULA, CA 92589-1416

Telephone: 1-800-207-2505

1. Certification of Existing Subsurface-Sewage Disposal system

Date of Inspection: 6/17/2022

35145 Calle Grande, Lake Elsinore, CA

Marie Machalek
(Owner)

2. I examined the Existing Subsurface-Sewage Disposal System at the above location on Date
and determined that the septic tank capacity is 1000 Gallons

6/17/2022
(Date)

3.

A) Construction of septic (Please Select One)

X Concrete Fiberglass
 Steel Plastic

B) External Dimensions of septic tank (approx.) (Length : 8 FT. width 5 Depth 5.5 FT.)

C) Condition of Tank (Please answer Yes Or No For each Question):

	Yes	No
Inlet Tee present ?	<u> X </u>	<u> </u>
Outlet Present	<u> X </u>	<u> </u>
Two Compartments ?	<u> X </u>	<u> </u>
Tank Structure Deteriorated ?	<u> </u>	<u> X </u>
Septic Tank Pumped ?	<u> X </u>	<u> </u>

4.

	Yes	No
A) Was the liquid level in the tank above the outlet tee?	<u> </u>	<u> X </u>
B) Was the area around the lids oxidized?	<u> </u>	<u> X </u>
C) Is the design of system gravity feed?	<u> X </u>	<u> </u>
D) were well (s) observed on this or adjacent property?	<u> </u>	<u> X </u>

If Yes, Indicate the distance of well from: Septic tank- ft
Leachlines- ft
Seepage Pits- ft

E) 30 Minute water test was conducted on the leach system. After 30 Minutes, Was the liquid level in the tank above the outlet tee? Yes NO X

Additional Comments:
Received

^{DS}
mw

5. It is my opinion that the system appears to be in good working order and can be expected to function Properly with proper maintenance. Yes X No

If there are any further questions, please Contact us at the above address

I certify Under penalty of perjury that the Foregoing is true and correct

^{DS}
mw Depth: Risers
Tank GPS Coordinates: 33.610484, -117.358200
Septic Tank location

Carly Ranzzo
Signature

458947
C-42 State License Number

9/30/2023
State License Expiration Date

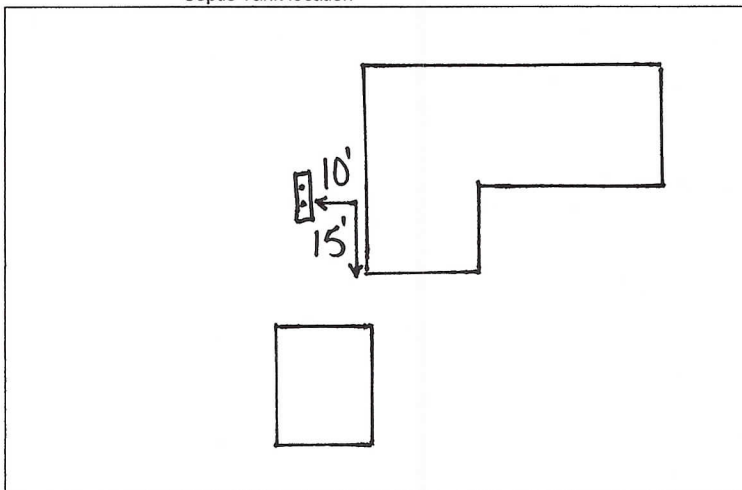

CALLE GRANDE