

13641 W Erwin St



Permit #:

07014 - 70000 - 03776

Plan Check #: B07SL01363

Printed: 05/30/07 10:58 AM

Event Code:

Bldg-Addition
1 or 2 Family Dwelling
Plan Check at Counter
Plan Check

City of Los Angeles - Department of Building and Safety
**APPLICATION FOR BUILDING PERMIT
AND CERTIFICATE OF OCCUPANCY**

Last Status: Ready to Issue
Status Date: 05/30/2007

L TRACT	BLOCK	LOT(s)	ARB	COUNTY MAP REF #	PARCEL ID # (PIN #)	2. ASSESSOR PARCEL #
TR 1000		30	27	M B 19-1 (SHT 1)	177B157 340	2330 - 013 - 018

3. PARCEL INFORMATION
 Area Planning Commission - South Valley Census Tract - 1236.02 Near Source Zone Distance - 7.1
 LADBS Branch Office - VN District Map - 177B157 Thomas Brothers Map Grid - 532-C7
 Council District - 2 Energy Zone - 9
 Certified Neighborhood Council - Greater Valley Glen Earthquake-Induced Liquefaction Area - Yes
 Community Plan Area - Van Nuys - North Sherman Oak Lot Cut Date - 04/20/1937

ZONE(S): R1-1 /

1010660726074066H

4. DOCUMENTS

5. CHECKLIST ITEMS
Combine Elec - Wrk. per 91.107.2.1.1.1

6. PROPERTY OWNER, TENANT, APPLICANT INFORMATION
 Owner(s): Dale, Lucille M 13641 Erwin St VAN NUYS CA 91401
 Tenant: Eric D Porter - (323) 930-1411
 Applicant: (Relationship: Agent for Owner)

7. EXISTING USE	PROPOSED USE
(07) Garage - Private	(07) Garage - Private (23) Patio Cover

8. DESCRIPTION OF WORK
REPAIR FIRE DAMAGED GARAGE & ADD PATIO COVER (7'-9" X 18'-3").

9. # Bldgs on Site & Use:

10. APPLICATION PROCESSING INFORMATION
 BLDG. PC By: Fidencio Madero DAS PC By:
 OK for Cashier: Fidencio Madero Coord. OK:
 Signature: *F Mach* Date: 5-30-07

For information and/or inspection requests originating within LA County,
Call toll-free (888) LA4BUILD (524-2845)
 Outside LA County, call (213) 482-0000 or visit www.ladbs.org

For Cashier's Use Only W/O #: 71403776
 LA Department of Building and Safety
 SL 15 26 109871 05/30/07 11:07AM

11. PROJECT VALUATION & FEE INFORMATION Final Fee Period

Permit Valuation:	\$5,000	PC Valuation:
FINAL TOTAL Bldg-Addition	200.23	
Permit Fee Subtotal Bldg-Addition	143.00	
Energy Surcharge		
Electrical	29.32	
Plan Check Subtotal Bldg-Addition	0.00	
Fire Hydrant Refuse-To-Pay	0.00	
E.O. Instrumentation	0.50	
O.S. Surcharge	3.46	
Sys. Surcharge	10.37	
Planning Surcharge	8.58	
Planning Surcharge Misc Fee	5.00	
School District Residential Level 2	0.00	
Permit Issuing Fee	0.00	
Sewer Cap ID:		Total Bond(s) Due:

BUILDING PERMIT-RES	\$143.00
ELECTRICAL PERMIT RES	\$29.32
EI RESIDENTIAL	\$0.50
ONE STOP SURCH	\$3.46
SYSTEMS DEVT FEE	\$10.37
CITY PLANNING SURCH	\$8.58
MISCELLANEOUS	\$5.00

Total Due: \$200.23
Check: \$200.23

07SL 49055

12. ATTACHMENTS
Plot Plan



* P 0 7 0 1 4 7 0 0 0 0 3 7 7 6 F N *

13. STRUCTURE INVENTORY (Note: Numeric measurement data in the format "number / number" implies "change in numeric value / total resulting numeric value")

07014 - 70000 - 03776

- (P) Floor Area (ZC): 0 Sqft / Sqft
- (P) Height (ZC): 0 Feet / Feet
- (P) Length: +7.75 Feet / 26 Feet
- (P) Stories: 0 Stories / 1 Stories
- (P) Width: 0 Feet / 18.25 Feet
- (P) U1 Occ. Group: +141 Sqft / 141 Sqft
- (P) Parking Req'd for Bldg (Auto+Bicycle): 0 Stalls / Sts
- (P) Type V-N Construction
- (P) Floor Construction - Concrete Slab on Grade
- (P) Foundation - Continuous Footing

14. APPLICATION COMMENTS

In the event that any box (i.e. 1-16) is filled to capacity, it is possible that additional information has been captured electronically and could not be printed due to space restrictions. Nevertheless, the information printed exceeds that required by Section 19825 of the Health and Safety Code of the State of California.

15. Building Relocated From:

16. CONTRACTOR, ARCHITECT, & ENGINEER NAME ADDRESS

(O) , Owner-Builder

CLASS LICENSE# PHONE #
0

PERMIT EXPIRATION/REFUNDS: This permit expires two years after the date of the permit issuance. This permit will also expire if no construction work is performed for a continuous period of 180 days (Sec. 98.0602 LAMC). Claims for refund of fees paid must be filed within one year from the date of expiration for permits granted by LADBS (Sec. 22.12 & 22.13 LAMC). The permittee may be entitled to reimbursement of permit fees if the Department fails to conduct an inspection within 60 days of receiving a request for final inspection (HS 17951).

17. OWNER-BUILDER DECLARATION

I hereby affirm under penalty of perjury that I am exempt from the Contractors' State License Law for the following reason (Section 7031.5, Business and Professions Code: Any city or county which requires a permit to construct, alter, improve, demolish, or repair any structure, prior to its issuance, also requires the applicant for such permit to file a signed statement that he or she is licensed pursuant to the provisions of the Contractors License Law (Chapter 9 (commencing with Section 7000) of Division 3 of the Business and Professions Code) or that he or she is exempt therefrom and the basis for the alleged exemption. Any violation of Section 7031.5 by any applicant for a permit subjects the applicant to a civil penalty of not more than five hundred dollars (\$500).):

I, as the owner of the property, or my employees with wages as their sole compensation, will do the work, and the structure is not intended or offered for sale (Sec. 7044, Business & Professions Code: The Contractors License Law does not apply to an owner of property who builds or improves thereon, and who does such work himself or herself or through his or her own employees, provided that such improvements are not intended or offered for sale. If, however, the building or improvement is sold within one year from completion, the owner-builder will have the burden of proving that he or she did not build or improve for the purpose of sale).

OR

I, as the owner of the property, am exclusively contracting with licensed contractors to construct the project (Sec. 7044, Business & Professions Code: The Contractors License Law does not apply to an owner of property who builds or improves thereon, and who contracts for such projects with a contractor(s) licensed pursuant to the Contractors License Law.)

18. WORKERS' COMPENSATION DECLARATION

I hereby affirm, under penalty of perjury, one of the following declarations:

I have and will maintain a certificate of consent to self insure for workers' compensation, as provided for by Section 3700 of the Labor Code, for the performance of the work for which this permit is issued.

I have and will maintain workers' compensation insurance, as required by Section 3700 of the Labor Code, for the performance of the work for which this permit is issued. My workers' compensation insurance carrier and policy number are:

Carrier: _____ Policy Number: _____

I certify that in the performance of the work for which this permit is issued, I shall not employ any person in any manner so as to become subject to the workers' compensation laws of California, and agree that if I should become subject to the workers' compensation provisions of Section 3700 of the Labor Code, I shall forthwith comply with those provisions.

WARNING: FAILURE TO SECURE WORKERS' COMPENSATION COVERAGE IS UNLAWFUL, AND SHALL SUBJECT AN EMPLOYER TO CRIMINAL PENALTIES AND CIVIL FINES UP TO ONE HUNDRED THOUSAND DOLLARS (\$100,000), IN ADDITION TO THE COST OF COMPENSATION, DAMAGES AS PROVIDED FOR IN SECTION 3706 OF THE LABOR CODE, INTEREST, AND ATTORNEY'S FEES.

19. ASBESTOS REMOVAL DECLARATION / LEAD HAZARD WARNING

I certify that notification of asbestos removal is either not applicable or has been submitted to the AQMD or EPA as per section 19827.5 of the Health and Safety Code. Information is available at (909) 396-2336 and the notification form at www.aqmd.gov. Lead safe construction practices are required when doing repairs that disturb paint in pre-1978 buildings due to the presence of lead per section 6716 and 6717 of the Labor Code. Information is available at Health Services for LA County at (800) 524-5323 or the State of California at (800) 597-5323 or www.dhs.ca.gov/childlead.

20. FINAL DECLARATION

I certify that I have read this application INCLUDING THE ABOVE DECLARATIONS and state that the above information INCLUDING THE ABOVE DECLARATIONS is correct. I agree to comply with all city and county ordinances and state laws relating to building construction, and hereby authorize representatives of this city to enter upon the above-mentioned property for inspection purposes. I realize that this permit is an application for inspection and that it does not approve or authorize the work specified herein, and it does not authorize or permit any violation or failure to comply with any applicable law. Furthermore, neither the City of Los Angeles nor any board, department officer, or employee thereof, make any warranty, nor shall be responsible for the performance or results of any work described herein, nor the condition of the property nor the soil upon which such work is performed. I further affirm under penalty of perjury, that the proposed work will not destroy or unreasonably interfere with any access or utility easement belonging to others and located on my property, but in the event such work does destroy or unreasonably interfere with such easement, a substitute easement(s) satisfactory to the holder(s) of the easement will be provided (Sec. 91.0106.4.3.4 LAMC).

By signing below, I certify that:

- (1) I accept all the declarations above namely the Owner-Builder Declaration, Workers' Compensation Declaration, Asbestos Removal Declaration / Lead Hazard Warning and Final Declaration; and
- (2) This permit is being obtained with the consent of the legal owner of the property.

Print Name: ERIC D. PORTER

Sign: 

Date: MAY 30, 2007 Owner Authorized Agent

Bldg-Addition
1 or 2 Family Dwelling
Plan Check

City of Los Angeles - Department of Building and Safety

Plan Check #: B07SL01363
Initiating Office: SOUTH LA
Printed on: 05/30/07 10:59:05

PLOT PLAN ATTACHMENT

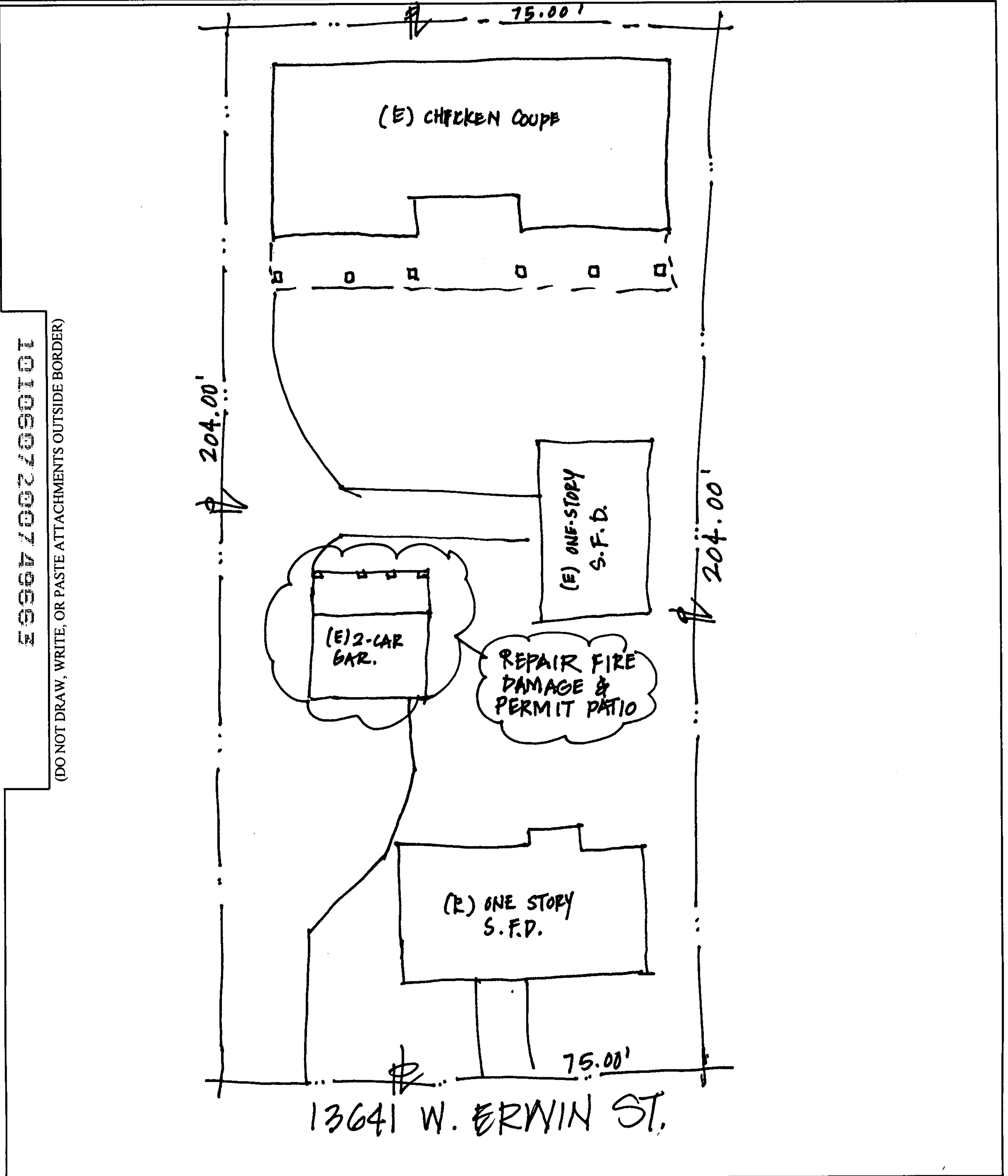

101060720074090101

(DO NOT DRAW, WRITE, OR PASTE ATTACHMENTS OUTSIDE BORDER)

THE UNIVERSITY OF CHICAGO

PHYSICS DEPARTMENT

PHYSICS 435

LECTURE 10

10.1

10.2