

WOOD DESTROYING PESTS AND ORGANISMS INSPECTION REPORT

Building No. 642	Street N. Wendy Drive	City Newbury Park	ZIP 91320	Date of Inspection 05/28/2024	Number of Pages 5
---------------------	--------------------------	----------------------	--------------	----------------------------------	----------------------

	Sherwood Inspections, Inc. PO Box 3701 Thousand Oaks CA 91362 (805) 409-7525 office@sherwoodinspections.com	Report # : 11182 Registration # : PR 8855 Escrow # : <input type="checkbox"/> CORRECTED REPORT
--	--	---

Ordered by: Terri Lynn Holland globlRED 31320 Via Colinas #117 Westlake Village CA 91360 terri@globlred.com	Property Owner and/or Party of Interest: c/o Ernest Yturriaga 642 N. Wendy Drive Newbury Park CA 91320	Report sent to: Ernest Yturriaga GloblRED Ernest@GloblRED.com
--	---	--

COMPLETE REPORT
 LIMITED REPORT
 SUPPLEMENTAL REPORT
 REINSPECTION REPORT

GENERAL DESCRIPTION: Furnished, stucco and frame house on a concrete slab with a composition roof.	Inspection Tag Posted: Garage
	Other Tags Posted:

An inspection has been made of the structure(s) shown on the diagram in accordance with the Structural Pest Control Act. Detached porches, detached steps, detached decks and any other structures not on the diagram were not inspected.

Subterranean Termites
 Drywood Termites
 Fungus / Dryrot
 Other Findings
 Further Inspection

If any of the above boxes are checked, it indicates that there were visible problems in accessible areas. Read the report for details on checked items.

Diagram Not To Scale

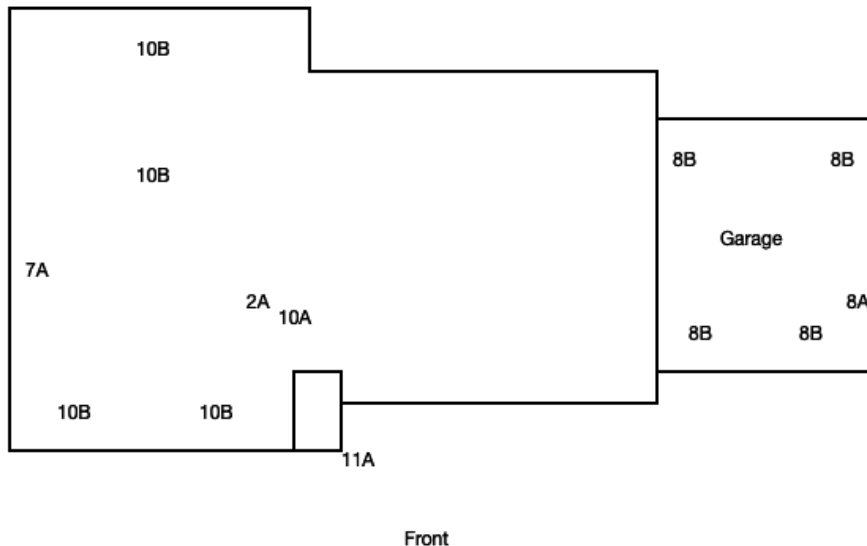

Inspected By: Jeffrey Isaak
 State License No. OPR14098
 Signature: 

You are entitled to obtain copies of all reports and completion notices on this property reported to the Structural Pest Control Board during the preceding two years. To obtain copies contact: Structural Pest Control Board, 2005 Evergreen Street, Suite 1500, Sacramento, California, 95815-3831.
 NOTE: Questions or problems concerning the above report should be directed to the manager of the company. Unresolved questions or problems with services performed may be directed to the Structural Pest Control Board at (916) 561-8708, (800) 737-8188 or www.pestboard.ca.gov.

43M-41 (Rev. 04/2015)

SHERWOOD INSPECTIONS, INC.

Page 2 of 5 inspection report

642	N. Wendy Drive	Newbury Park	CA	91320
Address of Property Inspected		City	State	ZIP
05/28/2024	11182			
Date of Inspection	Corresponding Report No.		Escrow No.	

WHAT IS A WOOD DESTROYING PEST & ORGANISM INSPECTION REPORT? READ THIS DOCUMENT. IT EXPLAINS THE SCOPE AND LIMITATIONS OF A STRUCTURAL PEST CONTROL INSPECTION AND A WOOD DESTROYING PEST & ORGANISM INSPECTION REPORT

All persons relying on this inspection report agree to the following terms and conditions. Contact our office if further information is needed.

Terms and Conditions

A Wood Destroying Pest & Organism Inspection Report contains findings as to the presence or absence of evidence of wood destroying pests and organisms in the **visible and accessible areas at the time of inspection** and contains recommendations for correcting any infestations or infections found. The contents of Wood Destroying Pest & Organism Inspection Reports are governed by the State of California Structural Pest Control Act and rules and regulations.

Some structures do not comply with building code requirements or may have structural, plumbing, electrical, mechanical, heating, air conditioning or other defects that do not pertain to wood destroying organisms. A Wood Destroying Pest & Organism Inspection Report does not contain information on such defects, if any, as they are not within the scope of the license of this company,

Scope of Inspection

The Structural Pest Control Act requires inspection of those areas which are **visible and accessible** at the time of inspection. Some areas of the structure are not accessible to inspection, such as the interior of hollow walls, spaces between floors, areas concealed by floor coverings, carpeting, appliances, furniture or cabinets. Infestations or infections may be active in these areas without visible and accessible evidence. If you desire inspection of areas that were not inspected, a further inspection of these areas can be performed at an additional cost if the areas are made accessible. Carpets, furniture or appliances are not moved and windows are not opened during a routine inspection. Second story eaves and walls are inspected from the ground level.

Roof Information

The exterior surface of the roof was not inspected. If you want the water tightness of the roof determined, you should contact a roofing contractor who is licensed by the Contractor's State License Board.

This company does not certify or guarantee against any leakage, such as (but not limited to) plumbing, appliances, walls, doors, windows, any type of seepage, roof or deck coverings. This company renders no guarantee, whatsoever, against any infection, infestation or any other adverse condition which may exist in such areas or may become visibly evident in such area after this date. Upon request, further inspection of these areas can be performed for an additional charge.

In the event damage or infestation described herein is later found to extend further than anticipated, our bid does not include such repairs. **OWNER SHOULD BE AWARE OF THIS CLOSED BID WHEN CONTRACTING WITH OTHERS OR UNDERTAKING THE WORK HIMSELF/HERSELF.**

This company will reinspect repairs done by others within four months of the original inspection. A charge, if any, can be no greater than the original inspection fee for each reinspection. The reinspection must be completed within ten (10) working days of request. The reinspection is a visual inspection and if inspection of concealed areas is desired, progress inspections will be necessary. **Any guarantees must be received from parties performing repairs.**

Required Notice: Reports on this structure prepared by various registered companies should list the same findings (i.e. termite infestations, termite damage, fungus damage, etc.). However, recommendations to correct these findings may vary from company to company. You have a right to seek a second opinion from another company.

Mold Information

This Wood Destroying Pest & Organisms Report **DOES NOT INCLUDE MOLD** or any mold like conditions. No reference will be made to mold or mold-like conditions. Mold is not a Wood Destroying Organism and is outside the scope of this report as defined by the Structural Pest Control Act. If you wish your property to be inspected for mold or mold like conditions, please contact the appropriate mold professional.

This report pertains to "wood destroying pests and organisms only". Household pests, insects, and vermin are not within the scope of this

SHERWOOD INSPECTIONS, INC.

Page 3 of 5 inspection report

642	N. Wendy Drive	Newbury Park	CA	91320
Address of Property Inspected		City	State	ZIP
05/28/2024	11182			
Date of Inspection	Corresponding Report No.		Escrow No.	

report.

SECTION I CONTAINS ITEMS WHERE THERE IS EVIDENCE OF ACTIVE INFESTATION, INFECTION OR CONDITIONS THAT HAVE RESULTED IN OR FROM INFESTATION OR INFECTION.

SECTION II ITEMS ARE CONDITIONS DEEMED LIKELY TO LEAD TO INFESTATION OR INFECTION BUT WHERE NO VISIBLE EVIDENCE OF SUCH WAS FOUND.

FURTHER INSPECTION ITEMS ARE DEFINED AS RECOMMENDATIONS TO INSPECT AREA(S) WHICH DURING THE ORIGINAL INSPECTION DID NOT ALLOW THE INSPECTOR ACCESS TO COMPLETE HIS INSPECTION AND CANNOT BE DEFINED AS SECTION I OR II.

SHERWOOD INSPECTIONS, INC.

Page 4 of 5 inspection report

642	N. Wendy Drive	Newbury Park	CA	91320
Address of Property Inspected		City	State	ZIP
05/28/2024	11182			
Date of Inspection	Corresponding Report No.		Escrow No.	

2. STALL SHOWER

2A - Section II

Finding: Cracked and/or missing grout noted at the shower area.

Recommendation: Contact a licensed contractor to inspect and make recommendations and corrections as needed.

Quote Price: No Bid

7. ATTIC SPACES

7A - Section I

Finding: Evidence of drywood termites was noted in the attic framing.

Recommendation: Fumigate the structure with an approved fumigant (Vikane) for the eradication of drywood termites. See our Occupants Fumigation Notice and roof/plant notice for more information.

Recommendation: Remove or cover the droppings.

Quote Price: 2,440.00

8. GARAGES

8A - Section I

Finding: Evidence of drywood termites was noted in the garage.

Recommendation: Fumigate the structure with an approved fumigant (Vikane) for the eradication of drywood termites. See our Occupants Fumigation Notice and roof/plant notice for more information.

Recommendation: Remove or cover the droppings.

Quote Price: See 7A

8B - Further Inspection

Finding: The garage was inaccessible for complete inspection due to storage.

Recommendation: Make these areas accessible and contact this company for further inspection.

Quote Price: No Bid

10. OTHER - INTERIOR

10A - Section II

Finding: Water stains noted under kitchen sink.

Recommendation: Contact a licensed contractor to inspect and make recommendations and corrections as needed.

Quote Price: Contractor

10B - Further Inspection

Finding: The bedrooms were was inaccessible due to storage and locks.

Recommendation: Make these areas accessible and contact this company for further inspection.

Quote Price: No Bid

11. OTHER - EXTERIOR

11A - Section I

Finding: Fungus and rot noted to the entry eave barge rafter as marked per diagram.

SHERWOOD INSPECTIONS, INC.

Page 5 of 5 inspection report

642	N. Wendy Drive	Newbury Park	CA	91320
Address of Property Inspected		City	State	ZIP
05/28/2024	11182			
Date of Inspection	Corresponding Report No.		Escrow No.	

Recommendation: Remove the damaged wood and replace with new wood.

Quote Price: 350.00

Thank you for selecting us to perform a structural pest control inspection on your property. Should you have any questions regarding this report, please call us directly @805.409.7525

We have determined that your property will benefit from a safe application of chemicals commonly used for structural pest control. In accordance with the laws and regulations of the State of California, we are required to provide you and your occupants with the following information prior to any application of chemicals to such property.

Please take a few moments to read and become familiar with the content. State law requires that you be given the following information:

CAUTION - PESTICIDES ARE TOXIC CHEMICALS. Structural pest control companies are registered and regulated by the Structural Pest Control Board, and apply pesticides which are registered and approved for use by the California Department of Pesticide Regulation and the United States Environmental Protection Agency. Registration is granted when the state finds that based on scientific evidence, there are no appreciable risks weighted by the benefits. The degree of risk depends on the degree of exposure, so exposure should be minimized.

If within 24 hours following application, you experience symptoms similar to common seasonal illness comparable to the flu, contact your physician or poison control center and your pest control operator immediately.

For further information, contact any of the following agencies in your area:

Poison Control Center	(800) 222-1222
Agricultural Department	(805) 388-4343
Health Department	(805) 981-5101
Structural Pest Control Board	(916) 561-8700

2005 Evergreen Street, Ste. 1500. Sacramento, CA 95815



Sherwood Inspections, Inc.

PO Box 3701
Thousand Oaks CA 91362
(805) 409-7525

office@sherwoodinspections.com

WORK AUTHORIZATION

Report #: 11182

No work will be performed until a signed copy of this agreement has been received.

Address of Property : 642 N. Wendy Drive
City: Newbury Park
State/ZIP: CA 91320

The inspection report of the company dated, **05/28/2024** is incorporated herein by reference as though fully set forth. The company is authorized to proceed with the work outlined in the items circled below from the Termite Inspection Report for the property inspected, for a total sum of \$ _____. This total amount is due and payable within 1 days from completion repair work and/or chemical application.

Sherwood Inspections, Inc, Agrees

To guarantee all repairs completed by this company for one year from date of completion. We assume no responsibility or guarantee on work performed by others. Reasonable care will be taken in the performance of our work, but we assume no responsibility for damage to any hidden pipes, wiring, or other facilities or to any shrubs, plants, or roof system.

THE OWNER OR OWNER'S AGENT AGREES

To pay for services rendered in any additional services requested upon completion of work to pay a service charge of one and one-half percent (1 1/2%) interest per month, or portion of any month, annual interest rate of eighteen percent (18%) on accounts exceeding the ten (10) day full payment schedule. The property Owner grants to The Company a security interest in the property to secure payment sum for work and inspection fee completed. In case of non-payment by the owner, reasonable attorney fees and costs of collection shall be paid by owner, whether suit be filed or not.

ALL PARTIES AGREE

If any additional work is deemed necessary by the local building inspector, said work will not be performed without additional authorization from owner or owner's agent. **This contract price does not include the charge of any Inspection Report fees.** Circle the items you wish performed by The Company, below and enter total amount above:

NOTICE TO OWNER

Under the California Mechanics Lien Law, any structural pest control company which contracts to do work for you, any contractor, subcontractor, laborer, supplier or other person who helps to improve your property, but is not paid for his or her work or supplies, has a right to enforce a claim against your property. This means that after a court hearing, your property could be sold by a court officer and the proceeds of the sale used to satisfy the indebtedness. This can happen even if you have paid your structural pest control company in full if the subcontractor, laborers or suppliers remain unpaid. To preserve their right to file a claim or lien against your property, certain claimants such as subcontractors or material suppliers are required to provide you with a document entitled "Preliminary Notice." Prime contractors and laborers for wages do not have to provide this notice. A Preliminary Notice is not a lien against your property. Its purpose is to notify you of persons who may have a right to file a lien against your property if they are not paid.

Wall paper and floor covering are not included in our quote.

If any work outlined in our report is started by others, this contract is null and void and will need to be renegotiated.

Any hidden damage or infestations that may be exposed during the course of these repairs is not included in our quote.

Guarantees: Fumigations are guaranteed for three years. Local Treatments are guaranteed for one year. Wood repairs are guaranteed for one year.

Note: The materials used will be in todays widths and grades. We cannot guarantee an exact match.

Work will not start until a signed copy of this contact is received by our office by the person responsible for payment.

Electricity must be on for any work to start.

Painting is not included in our quote. All exposed wood will be prime coated.

Payment Terms

Full payment for work completed is expected at the time of completion.

This quote is good for 15 days from the inspection date.

ITEMS					
Prefix	Section I	Section II	Further Inspection	Other	
2A		No Bid			
7A	2,440.00				
8A	See 7A				
8B			No Bid		
10A		Contractor			
10B			No Bid		

Property Owner: _____ Date: _____ Inspected By: Jeffrey Isaak Date: 05/29/2024

Ordered By: _____ Date: _____



Sherwood Inspections, Inc.

PO Box 3701
Thousand Oaks CA 91362
(805) 409-7525

office@sherwoodinspections.com

WORK AUTHORIZATION

Report #: 11182

Prefix	Section I	Section II	Further Inspection	Other
11A	350.00			
Total:	2,790.00	0.00	0.00	0.00
Grand Total:	2,790.00			

Property Owner: _____ Date: _____ Inspected By: Jeffrey Isaak Date: 05/29/2024

Ordered By: _____ Date: _____



**SHERWOOD
INSPECTIONS, INC.**
TERMITE SPECIALISTS

INVOICE / STATEMENT

Sherwood Inspections, Inc.
PO Box 3701
Thousand Oaks CA 91362
(805) 409-7525
office@sherwoodinspections.com

Date: 05/29/2024
Report Number: 11182
Invoice Number: 11182-1
Escrow Number:

Property 642 N. Wendy Drive
Inspected: Newbury Park, CA 91320

Bill To: Ernest Yturriaga
GloblRED

(805) 568-7503
Ernest@GloblRED.com

Inspection: \$	100.00
Invoice Total: \$	100.00
Payments: \$	100.00
Total Due: \$	0.00

Venmo @sherwoodinspections Zelle: (805) 338-0364 Credit card: Request a link
via email

RETAIN THIS COPY FOR YOUR RECORDS
THANK YOU FOR YOUR BUSINESS!

CUT HERE

CUT HERE

CUT HERE



**SHERWOOD
INSPECTIONS, INC.**
TERMITE SPECIALISTS

INVOICE / STATEMENT

Sherwood Inspections, Inc.
PO Box 3701
Thousand Oaks CA 91362
(805) 409-7525
office@sherwoodinspections.com

Date: 05/29/2024
Report Number: 11182
Invoice Number: 11182-1
Escrow Number:

Property 642 N. Wendy Drive
Inspected: Newbury Park, CA 91320

Bill To: Ernest Yturriaga
GloblRED

(805) 568-7503
Ernest@GloblRED.com

Inspection: \$	100.00
Invoice Total: \$	100.00
Payments: \$	100.00
Total Due: \$	0.00

Venmo @sherwoodinspections Zelle: (805) 338-0364 Credit card: Request a link
via email

RETURN THIS COPY WITH REMITTANCE
THANK YOU FOR YOUR BUSINESS!