

**KANCUN POOLS & SPAS INC.**

P.O. BOX 7509  
LA QUINTA, CA 92248  
(760) 397 7699 (442) 202 9244  
CA LICENSE 1078156 C-53

**BRITAIN BRIGHT  
71568 TANGIER RD.  
RANCHO MIRAGE, CA 92222**

2022 CALIFORNIA BUILDING CODE  
2022 CALIFORNIA RESIDENTIAL CODE  
2022 CALIFORNIA MECHANICAL CODE  
2022 CALIFORNIA PLUMBING CODE  
2022 CALIFORNIA ELECTRICAL CODE  
2022 CALIFORNIA EXISTING BUILDING CODE  
2022 CALIFORNIA ENERGY EFFICIENCY STANDARDS  
2022 CALIFORNIA GREEN BUILDING STANDARDS CODE

GOVERNMENT CODE SECTION 4216.2 (A) (1) EXCEPT IN AN EMERGENCY, ANY PERSON PLANNING TO CONDUCT ANY EXCAVATION SHALL CONTACT THE APPROPRIATE REGIONAL NOTIFICATION CENTER, AT LEAST TWO WORKING DAYS, BUT NOT MORE THAN 14 CALENDAR DAYS, PRIOR COMMENCING THAT EXCAVATION, IF THE EXCAVATION WILL BE CONDUCTED IN AND AREA THAT IS KNOWN, OR REASONABLY SHOULD BE KNOWN, TO CONTAIN SUBSURFACE INSTALLATIONS OTHER THAN THE UNDERGROUND FACILITIES OWNED OR OPERATED BY THE EXCAVATOR AND IF PRACTICAL, THE EXCAVATOR SHALL DELINEATE WITH WHITE PAINT OR OTHER SUITABLE MARKING THE AREA TO BE EXCAVATED. CALL 811 DIG ALERT.

1. ALL EQUIPMENT WILL SHALL BE SEISMICALLY ANCHORED.
2. MASONRY EQUIPMENT WALL SHALL BE BUILT PER CITY STANDARD SPECIFICATIONS.
3. ALL GFI OUTLETS WILL BE WEATHER AND TAMPER PROOF. ( EXTRA DUTY )
4. ALL OUTLETS SUPPLIED BY SINGLE-PHASE, 15A AND 20A, 125V OR 240V. BRANCH CIRCUITS FOR SWIMMING POOL PUMP MOTORS ARE REQUIRED TO HAVE GFCI PROTECTION.
5. PROVIDE 36" WORKING CLEARANCE FOR THE POOL EQUIPMENT MOTORS ARE REQUIRED.

-INSTALLATION OF POOL SYSTEMS AND EQUIPMENT WILL COMPLY WITH SECTION 110.4 2022 CALIFORNIA ENERGY CODE - MANDATORY REQUIREMENTS.

-EXIT ALARMS TO BE INSTALLED ON ALL DOORS WITH DIRECT ACCESS TO THE POOL.

-SECONDARY BOUNDARY TO BE POOL GUARD WATER SENSOR ALARM NSF CERTIFY AD ASTM F 2208-08

-POOL HEATER, POOL EQUIPMENT SHALL BE INSTALLED PER MANUFACTURE'S RECOMMENDATIONS AND IN ACCORDANCE WITH LOCAL REGULATIONS.

-INSTALLATION OF POOL SYSTEMS AND EQUIPMENT WILL COMPLY WITH SECTION 114- MANDATORY REQUIREMENTS.

POOL SAFETY BARRIER:

- EXIT ALARMS (UL 2017)
- SELF-CLOSING
- SELF-LATCHING DOORS

EXIT ALARMS TO BE INSTALLED ON ALL DOORS WITH DIRECT ACCESS TO THE POOL.

SPA TO BE EQUIPPED WITH ANTI-ENTRAPMENT DEVICE (SEC. 1404 FEDERAL SWIMMING POOL AND SPA DRAIN COVER STANDARD).

PROVIDE LOCATION OF ANTI-ENTRAPMENT/VORTEX COVERS MEETING CURRENT STANDARDS OF THE AMERICAN SOCIETY FOR TESTING AND MATERIALS (ASTM) OR THE AMERICAN SOCIETY OF MECHANICAL ENGINEERS (ASME). IDENTIFY A MINIMUM 3 FEET SEPARATION BETWEEN ALL DRAINS AND NOTE HYDRAULICALLY BALANCED.

SAFETY FEATURES:

\* ALL ANTI-ENTRAPMENT COVER INSTALLATION MEETING CURRENT STANDARDS OF THE AMERICAN SOCIETY FOR TESTING AND MATERIALS OR THE AMERICAN SOCIETY OF MECHANICAL ENGINEERS (ASME).

ELECTRICAL:

\* EQUIPOTENTIAL BONDING REQUIREMENTS SHALL BE INSTALLED TO ELIMINATE VOLTAGE GRADIENTS IN THE POOL AREA AS PER DEC ART. 680.26(b) (2).

\*\* WE ARE NOT RESPONSIBLE FOR SPRINKLERS DAMAGE.  
\*\* WE ARE NOT RESPONSIBLE FOR PLANTING VEGETATION.

OWNER RESPONSIBILITIES:

- DETERMINE THE APPROPRIATE POOL OR SPA ELEVATION AT THE TIME OF LAY OUT.
- AGREE THAT RANGEL POOL & SPA DESIGNS IS NOT RESPONSIBLE FOR UNDERGROUND CONDITIONS OR OBJECTS, ANY DAMAGE TO CURBS, SIDEWALKS, DRIVEWAYS, LAWNS OR OTHER ITEMS IN THE AREA.
- WET DOWN CONCRETE SHELL AT LEAST ONCE DAILY FOR SEVEN DAYS AFTER IS INSTALLED.
- POOL EQUIPMENT LOCATION SUBJECT TO ACCEPTANCE OF LOCAL BUILDING DEPARTMENT.
- FILL POOL IMMEDIATELY AFTER PEBBLE OR PLASTER (FOLLOW INSTRUCTIONS).
- OWNER APPROVES PLAN, POOL AND EQUIPMENT LOCATION AND HAS READ THE RESPONSIBILITIES AND NOTICES ABOVE.

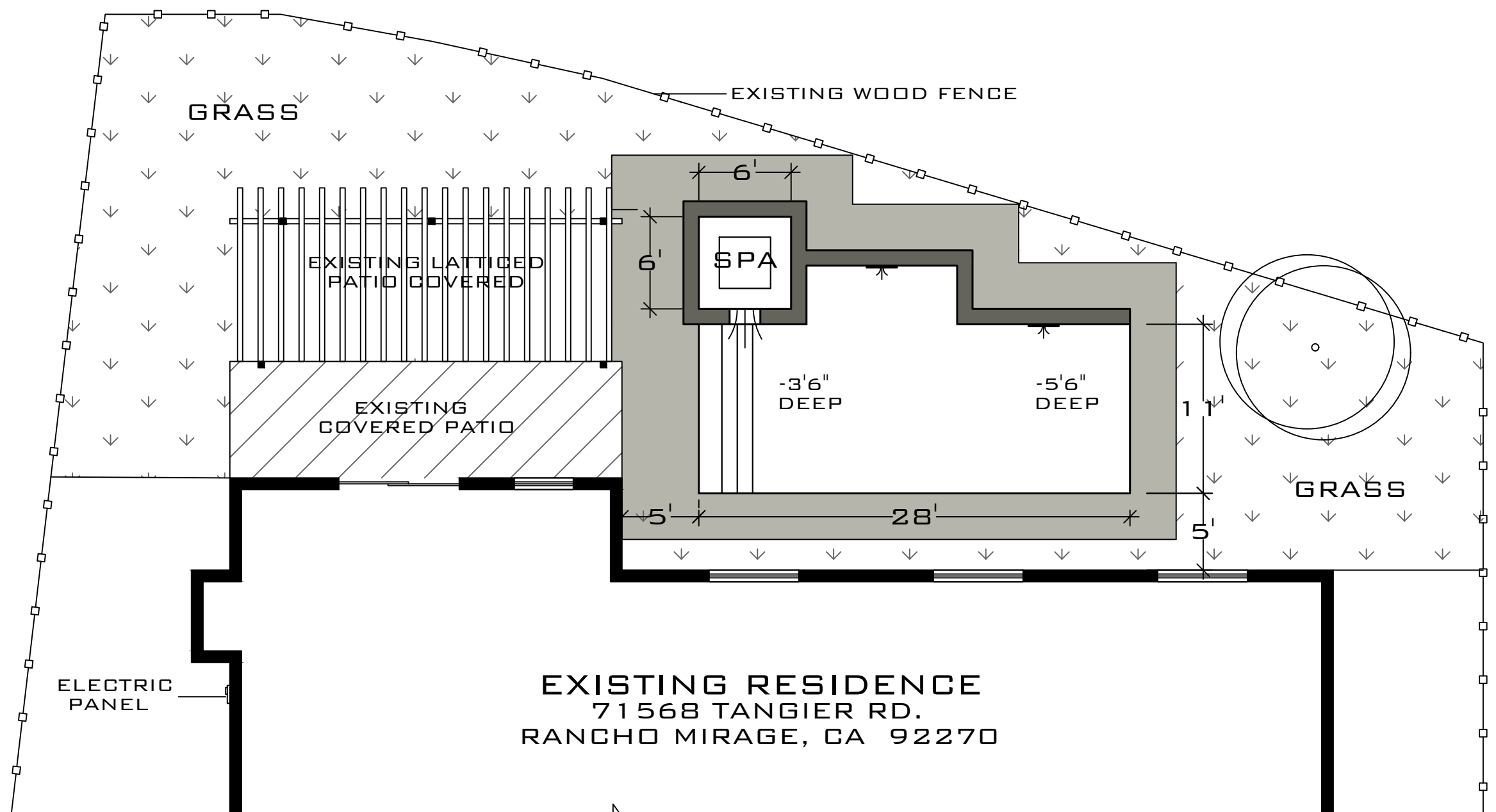

- 28' x 11' SWIMMING POOL/ 3'6" TO 5'6" DEEP
- 6' x 6' SPA/ 18" RAISED
- 18" RAISED BACK WALL WITH 2 / 18" SHEER DESCENDS

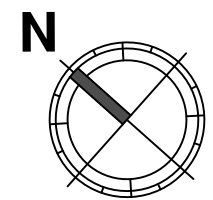

ESC. 1/8":1'-0"