

WOOD DESTROYING PESTS AND ORGANISMS INSPECTION REPORT

Building No. 1347	Street Avenida Pantera	City San Marcos	ZIP 92069	Date of Inspection 12/02/2025	Number of Pages 5
		The Works Termite Inc 1101 Bay Blvd #B Chula Vista CA 91911 (619) 987-2504 theworkstermite@yahoo.com		Report # : 18603 Registration # : PR7066 Escrow # : <input type="checkbox"/> CORRECTED REPORT	
Ordered by: Mylène Merlo Independent Broker 2647 Gateway Road, Suite 105-220 Carlsbad CA 92009 United States HOME: (760) 637-7231 mylene@mylenemerlo.com.		Property Owner and Party of Interest: Mylène Merlo Independent Broker 2647 Gateway Road, Suite 105-220 Carlsbad CA 92009 United States HOME: (760) 637-7231 mylene@mylenemerlo.com.		Report sent to: Mylène Merlo Independent Broker 2647 Gateway Road, Suite 105-220 Carlsbad CA 92009 United States HOME: (760) 637-7231 mylene@mylenemerlo.com.	
COMPLETE REPORT <input checked="" type="checkbox"/> LIMITED REPORT <input type="checkbox"/> SUPPLEMENTAL REPORT <input type="checkbox"/> REINSPECTION REPORT <input type="checkbox"/>					
GENERAL DESCRIPTION: 2 Story single family residence vacant with attached garage.				Inspection Tag Posted: Attic	
				Other Tags Posted: none	
An inspection has been made of the structure(s) shown on the diagram in accordance with the Structural Pest Control Act. Detached porches, detached steps, detached decks and any other structures not on the diagram were not inspected.					
Subterranean Termites <input type="checkbox"/> Drywood Termites <input type="checkbox"/> Fungus / Dryrot <input type="checkbox"/> Other Findings <input checked="" type="checkbox"/> Further Inspection <input type="checkbox"/>					
If any of the above boxes are checked, it indicates that there were visible problems in accessible areas. Read the report for details on checked items.					

Diagram Not To Scale



Inspected By: Guillermo Nunez State License No. OPR10701 Signature: 

You are entitled to obtain copies of all reports and completion notices on this property reported to the Structural Pest Control Board during the preceding two years. To obtain copies contact: Structural Pest Control Board, 2005 Evergreen Street, Suite 1500, Sacramento, California, 95815-3831.

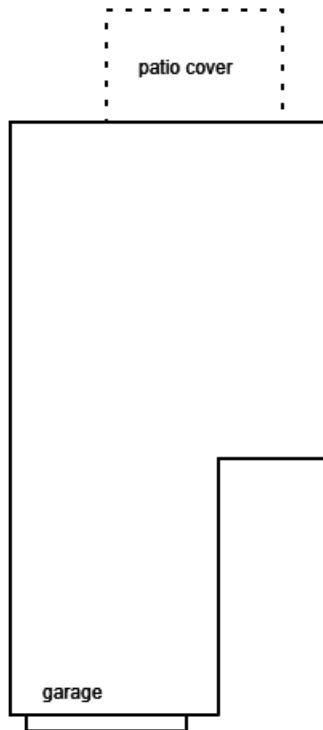
NOTE: Questions or problems concerning the above report should be directed to the manager of the company. Unresolved questions or problems with services performed may be directed to the Structural Pest Control Board at (916) 561-8708, (800) 737-8188 or www.pestboard.ca.gov.

43M-41 (Rev. 04/2015)

THE WORKS TERMITE INC

Page 2 of 5 inspection report

1347	Avenida Pantera	San Marcos	CA	92069
Address of Property Inspected		City	State	ZIP
12/02/2025	18603			
Date of Inspection	Corresponding Report No.		Escrow No.	

WHAT IS A WOOD DESTROYING PEST & ORGANISM INSPECTION REPORT? READ THIS DOCUMENT. IT EXPLAINS THE SCOPE AND LIMITATIONS OF A STRUCTURAL PEST CONTROL INSPECTION AND A WOOD DESTROYING PEST & ORGANISM INSPECTION REPORT.

A Wood Destroying Pest & Organism Inspection Report contains findings as to the presence or absence of evidence of wood destroying pests and organisms in visible and accessible areas and contains recommendations for correcting any infestations or infections found. The contents of Wood Destroying Pest & Organism Inspection Reports are governed by the Structural Pest Control Act and regulations.

Some structures do not comply with building code requirements or may have structural, plumbing, electrical, mechanical, heating, air conditioning or other defects that do not pertain to wood destroying organisms. A Wood Destroying Pest & Organism Inspection Report does not contain information on such defects, if any, as they are not within the scope of the licenses of either this company, or it's employees.

The Structural Pest Control Act requires inspection of only those areas which are visible and accessible at the time of inspection. Some areas of the structure are not accessible to inspection, such as the interior of hollow walls, spaces between floors, areas concealed by carpeting, appliances, furniture or cabinets. Infestations or infections may be active in these areas without visible and accessible evidence. If you desire information about areas that were not inspected, a further inspection may be performed at an additional cost. Carpets, furniture

PORTIONS OF THE ATTIC CONCEALED OR MADE INACCESSIBLE BY INSULATION PORTIONS OF THE ATTIC CONCEALED OR MADE INACCESSIBLE BY DUCTING, PORTIONS OF THE ATTIC OR ROOF CAVITY CONCEALED DUE TO

AN INADEQUATE CRAWL SPACE, THE INTERIORS OF BOXED EAVES, EAVES CONCEALED BY PATIO COVERS OR OTHER ABUTMENTS PORTIONS OF THE SUBAREA CONCEALED OR MADE INACCESSIBLE BY INSULATION, DUCTING OR INSUFFICIENT CLEARANCE, PORTE COCHERES, INCLOSED BAY WINDOWS, AREAS BENEATH WOOD FLOORS OVER CONCRETE, AREAS CONCEALED BY

BUILT-IN CABINET WORK OR BUILT-IN APPLIANCES, AREAS CONCEALED BY FLOOR COVERINGS SUCH AS WALL-TO-WALL CARPETING, LINOLEUM, CERAMIC TILE, AREA RUGS, THROW RUGS, BATH AND KITCHEN MATS ETC. AND AREAS CONCEALED BY BUILT-IN APPLIANCES. WE DO NOT OPEN ANY WINDOWS OR REMOVE WINDOW SCREENS DURING THE COURSE OF OUR

INSPECTIONS, UNLESS OTHERWISE SPECIFIED IN THIS REPORT. ADDITIONALLY, WE DO NOT INSPECT ATTACHED/DETACHED FENCES, GATES, SHEDS, DOG HOUSES, RETAINING WALLS WOOD PLANTERS OR WALKWAYS OR AREAS CONCEALED BY HEAVY VEGETATION AND AREAS WHERE LOCKS PREVENTED ACCESS.

The exterior Surface of the roof was not inspected. If you want the water tightness of the roof determined, you should contact a roofing contractor who is licensed by the Contractor's State License Board.

This company does not certify or guarantee against any leakage, such as (but not limited to) plumbing, appliances, walls, doors, windows, any type of seepage, roof or deck coverings. This company renders no guarantee, whatsoever, against any infection, infestation or any other adverse condition which may exist in such areas or may become visibly evident in such area after this date. Upon request, further inspection of these areas would be performed at an additional charge.

In the event damage or infestation described herein is later found to extend further than anticipated, our bid will not include such repairs. OWNER SHOULD BE AWARE OF THIS CLOSED BID WHEN CONTRACTING WITH OTHERS OR UNDERTAKING THE WORK HIMSELF/HERSELF.

If requested by the person ordering this report, a re-inspection of the structure will be performed. Such requests must be within four (4) months of the date of this inspection. Every re-inspection fee amount shall not exceed the original inspection fee.

Wall paper, stain, or interior painting are excluded from our contract. New wood exposed to the weather will be prime painted, only upon request at an additional expense.

This company will reinspect repairs done by others within four months of the original inspection. A charge, if any, can be no greater than the original inspection fee for each reinspection. The reinspection must be done within ten (10) working days of request. The reinspection is a visual inspection and if inspection of concealed areas is desired, inspection of work in progress will be necessary. Any guarantees must be received from parties performing repairs.

NOTICE: Reports on this structure prepared by various registered companies should list the same findings (i.e. termite infestations, termite damage, fungus damage, etc.). However, recommendations to correct these findings may vary from company to company. You have a right to seek a second opinion from another company.

This Wood Destroying Pest & Organisms Report DOES NOT INCLUDE MOLD or any mold like conditions. No reference will be made to mold or mold-like conditions. Mold is not a Wood Destroying Organism and is outside the scope of this report as defined by the Structural Pest Control Act. If you wish your property to be inspected for mold or mold like conditions, please contact the appropriate mold professional. A limited report is the report on only part of a structure. Such a report shall

THE WORKS TERMITE INC

Page 3 of 5 inspection report

1347	Avenida Pantera	San Marcos	CA	92069
Address of Property Inspected		City	State	ZIP
12/02/2025	18603			
Date of Inspection	Corresponding Report No.	Escrow No.		

have a diagram of the area inspected and shall specifically indicate which portions of the structure were inspected with recommendation for further inspection of the entire structure and the name of the person or agency requesting a limited report.

FUMIGATION INFO

***PLEASE GO TO YOUTUBE: FUMIGATION PREPARATION

***IT IS YOUR RESPONSIBILITY TO CALL SDGE FOR GAS TURN ON SERVICE 1800 411-7343. (WE WILL NEED ELECTRICITY TO STAY ON).

***DO NOT REMOVE THE FUMIGATION TAG ON THE GAS METER, SDGE NEEDS TO SEE THAT TAG FOR GAS TURN ON SERVICE, GAS METER NEEDS TO HAVE 2' ACCESS AROUND GAS METER.

***FUMIGATION NOTICE IS ALSO A CHECK LIST PLEASE READ ENTIRE NOTICE AND ANY QUESTIONS CALL ME: WILLIE 619 458-5148

***FOOD NEEDS TO BE BAGGED UP WITH FUMIGATION BAGS THAT THE WORKS TERMITE INC. WILL PROVIDE.

***WE WILL NEED A LOCKBOX CODE WITH KEY SO AS TO HAVE ACCESS TO THE PROPERTY ON THE DAY OF FUMIGATION OR SOMEONE PRESENT TO GIVE ACCESS.

THE WORKS TERMITE INC

Page 4 of 5 inspection report

1347	Avenida Pantera	San Marcos	CA	92069
Address of Property Inspected		City	State	ZIP
12/02/2025	18603			
Date of Inspection	Corresponding Report No.	Escrow No.		

SECTION I CONTAINS ITEMS WHERE THERE IS EVIDENCE OF ACTIVE INFESTATION, INFECTION OR CONDITIONS THAT HAVE RESULTED IN OR FROM INFESTATION OR INFECTION OF SUBTERRANEAN TERMITE/DRYWOOD TERMITE & FUNGUS/DRYROT SECTION II ITEMS ARE CONDITIONS DEEMED LIKELY TO LEAD TO INFESTATION OR INFECTION BUT WHERE NO VISIBLE EVIDENCE OF SUCH WAS FOUND. FURTHER INSPECTION ITEMS ARE DEFINED AS RECOMMENDATIONS TO INSPECT AREA(S) WHICH DURING THE ORIGINAL INSPECTION DID NOT ALLOW THE INSPECTOR ACCESS TO COMPLETE HIS INSPECTION AND CANNOT BE DEFINED AS SECTION I OR II. WE ARE LICENSED TO INSPECT, SUBTERRANEAN TERMITE/DRYWOOD TERMITE & FUNGUS/DRYROT INFESTATION ONLY. NO OPINION, RECOMENDATION OR IDENTIFICATION ON ANY OTHER PEST INFESTATION. THE WORKS TERMITE CO. TO WARRANTY ALL REPAIRS AND OR TREATMENTS FOR ONE YEAR FROM DATE OF COMPLETION EXCEPT FOR CAULKING,GROUTING OR PLUMBING, WHICH IS GUARANTEED FOR A PERIOD OF NINETY(90) DAYS. WE ASSUME NO RESPONSIBILITY FOR WORK PERFORMED BY OTHERS, TO BE BOUND TO PERFORM THIS WORK FOR THE PRICE QUOTED IN OUR COST BREAKDOWN FOR A PERIOD NOT TO EXCEED 30 DAYS, TO USE REASONABLE CARE IN THE PERFORMANCE OF OUR WORK BUT TO ASSUME NO RESPONSIBILITY FOR DAMAGE TO ANY HIDDEN PIPES, WIRING, OR OTHER FACILITIES OR TO ANY SHRUBS, PLANTS OR ROOF. (THE SECOND/OR MORE STORY EAVE IS CONSIDERED INACCESSIBLE DUE TO HEIGHT)

"This is a separated report which is defined as Section I/Section II conditions evident on the date of the inspection. Section I contains items where there is visible evidence of active infestation, infection or conditions that have resulted in or from infestation of infection. Section II items are conditions deemed likely to lead to infestation or infection but where no visible evidence of such was found. Further inspection items are defined as recommendations to inspect area(s) which during the original inspection did not allow the inspector access to complete the inspection and cannot be defined as Section I or Section II."

4. OTHER FINDINGS:

4A - Section I

An \$85 fee will be charged for the Clerical & Notice Of Completion / Clearance form in which The Works Termite Inc. will honor the warranty as per report Findings and recommendations with a 1 year warranty for local treatment and a 3 year warranty with a fumigation.

The Works Termite Inc. to honor all warranties within the report with the issuance of the Notice Of Completion / Clearance with a 1 year local treatment warranty OR a 3 year fumigation warranty and repairs are warranty for 1 year.

"Thank you for selecting our company to perform a structural SUBTERRANEAN TERMITE/DRYWOOD TERMITE & FUNGUS/DRYROT control inspection on your property. Our inspectors have determined that your property will benefit from the safe application of a chemical commonly used for structural pest control. In accordance with the laws and regulations of the State of California, we are required to provide you and your occupants with the following information prior to any application of chemicals to such property. Please take a few moments to read and become familiar with the content.

*****OCCUPANTS CHEMICAL NOTICE***** The Works Termite Inc. will use pesticide chemical(s) specified below for the control of wood destroying pests or organisms in locations identified in the Structural Pest Control report as indicated above. (1) The pest(s) to be controlled: ____ SUBTERRANEAN TERMITE ____ DRYWOOD TERMITE ____ FUNGUS/DRY ROT . ____ OTHER (2) The pesticide(s) proposed to be used and the active ingredient(s): ____A. TERMIDOR (FIPRONIL 9.1% INERT INGREDIENTS 90.9%) ____B. TIMBOR (DISODIUM OCTABORATE TETRAHYDRATE) ____C. COPPER (NAPTHENATE (COPPER SALTS OF NAPTHENIC ACIDS) ____D. PREMISE (IMIDACLOPRID 0.5% INERT INGREDIENTS 99.5) ____E. VIKANE (SULFURYL FLUORIDE 99.8% INERT INGREDIENTS 0.2%) Persons with respiratory or allergic conditions, or others who may be concerned about their health relative to this chemical treatment, should contact their

THE WORKS TERMITE INC

Page 5 of 5 inspection report

1347	Avenida Pantera	San Marcos	CA	92069
Address of Property Inspected		City	State	ZIP
12/02/2025	18603			
Date of Inspection	Corresponding Report No.	Escrow No.		

physician concerning occupancy during and after chemical treatment prior to signing this NOTICE. NO CHEMICAL APPLICATION WILL BE PERFORMED UNTIL SUCH TIME THAT THIS NOTICE IS RETURNED. HAVING READ THE INSTRUCTIONS, I, THE UNDERSIGNED, WILL ACCEPT RESPONSIBILITY FOR ALL THE AFOREMENTIONED.

____ owner/occupant date
____ owner/occupant date

“STATE law requires that you be given the following information: CAUTION—PESTICIDES ARE TOXIC CHEMICALS. Structural Pest Control Companies are registered and regulated by the Structural Pest Control Board, and apply pesticides which are registered and approved for use by the Department of Pesticide Regulation and the United States Environmental Protection Agency. Registration is granted when the state finds that, based on existing scientific evidence, there are no appreciable risks if proper use conditions are followed or that the risks are outweighed by the benefits. The degree of risk depends upon the degree of exposure, so exposure should be minimized.

“If within 24 hours following application you experience symptoms similar to common seasonal illness comparable to the flu, contact your physician or poison control center (telephone number) and your pest control company immediately.” (This statement shall be modified to include any other symptoms of overexposure which are not typical of influenza.)

“For further information, contact any of the following: Your Pest Control Company (telephone number); for Health Questions—the County Health Department (telephone number); for Application Information—the County Agricultural Commissioner (telephone number), and for Regulatory Information—the Structural Pest Control Board (telephone number and address).

The Works Termite Inc. 619-987-2504 County Health Department 619-338-2222 County Poison Control Center 800-222-1222 County Agricultural Commissioner 858-694-2738 Structural Pest Control Board 916-561-8700 or 800-737-8188 (2005 Structural Pest Control Board: EVERGREEN ST, SUITE 1500, SACRAMENTO, CALIFORNIA 95815.)

Poison Control Center	(800) 222-1222
Agricultural Department	(858) 694-2739
Health Department	(866) 358-2966
Structural Pest Control Board	(916) 561-8700
2005 Evergreen Street, Ste. 1500. Sacramento, CA 95815	