

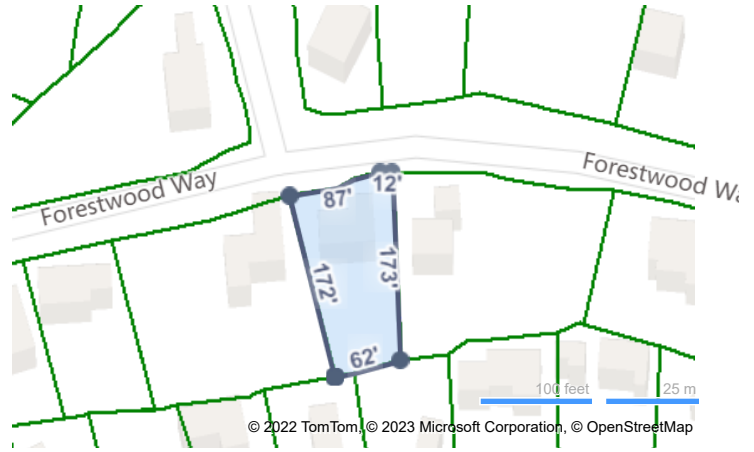

Next



LOCATION

Property Address	20721 Forestwood Way Groveland, CA 95321-9539
Subdivision	
Carrier Route	H005
County	Tuolumne County, CA

GENERAL PARCEL INFORMATION

APN/Tax ID	092-270-033-000
Alt. APN	
Account Number	
Tax Area	54-012
2020 Census Trct/Blk	42.01/2
Assessor Roll Year	2022

PROPERTY SUMMARY

Property Type	Residential
Land Use	Single Family Residential
Improvement Type	Single Family Residential
Square Feet	1280

CURRENT OWNER

Name	Botell Carolyn T
Mailing Address	20721 Forestwood Way Groveland, CA 95321-9539
Owner Occupied	Yes

Owner Right Vesting

SCHOOL INFORMATION

These are the closest schools to the property

Moccasin Community Day School	2.2 mi
Primary Middle: K to 8	Distance
Tioga High School	2.5 mi
High: 9 to 12	Distance

SALES HISTORY THROUGH 12/22/2022

Date	Date Recorded	Amount	Buyer/Owners	Seller	Instrument	No. Parcels	Book/Page Or Document#
4/1/2013	4/8/2013	\$210,000	Botell Carolyn T	Sala Craig C & Dougan Sharon E	Grant Deed		2013005756
4/3/2003	5/27/2003		Sala Craig C & Dougan Sharon E	Sala Craig C	Intrafamily Transfer & Dissolution		2003012533
3/26/2003	4/1/2003		Sala Craig C	Dougan Sharon E	Intrafamily Transfer & Dissolution		2003007648

TAX ASSESSMENT

Tax Assessment	2022	Change (%)	2021	Change (%)	2020
Assessed Land	\$23,203.00	\$454.00 (2.0%)	\$22,749.00	\$233.00 (1.0%)	\$22,516.00
Assessed Improvements	\$220,470.00	\$4,322.00 (2.0%)	\$216,148.00	\$2,216.00 (1.0%)	\$213,932.00
Total Assessment	\$243,673.00	\$4,776.00 (2.0%)	\$238,897.00	\$2,449.00 (1.0%)	\$236,448.00
Exempt Reason	Homeowners Exemption				
% Improved	90%				

TAXES

Tax Year	City Taxes	County Taxes	Total Taxes
2022			\$2,678.96
2021			\$2,640.62
2020			\$2,598.16
2019			\$2,519.50
2018			\$2,461.58
2017			\$2,409.04
2016			\$2,349.30

2015	\$2,318.62
2014	\$2,265.02
2013	\$2,394.62

MORTGAGE HISTORY

Date	Loan Amount	Borrower	Lender	Book/Page or Document#
03/07/2017	\$80,000	Botell Carolyn T	The Golden One Credit Union	2017002784
04/01/2013	\$84,000	Botell Carolyn T	Wells Fargo	2013005757
03/26/2003	\$112,000	Sala Craig C	Gateway Bank	2003007649

FORECLOSURE HISTORY

No foreclosures were found for this parcel.

PROPERTY CHARACTERISTICS: BUILDING

Building # 1

Type	Single Family Residential	Condition		Units	
Year Built	1996	Effective Year		Stories	1
BRs	3	Baths	2 F H	Rooms	3
Total Sq. Ft.	1,280				

Building Square Feet (Living Space)		Building Square Feet (Other)	
--	--	-------------------------------------	--

- CONSTRUCTION

Quality	C	Roof Framing	
Shape		Roof Cover Deck	
Partitions		Cabinet Millwork	
Common Wall		Floor Finish	
Foundation		Interior Finish	
Floor System		Air Conditioning	None
Exterior Wall		Heat Type	
Structural Framing		Bathroom Tile	
Fireplace	Y	Plumbing Fixtures	

- OTHER

Occupancy		Building Data Source	
------------------	--	-----------------------------	--

PROPERTY CHARACTERISTICS: EXTRA FEATURES

Feature	Size or Description	Year Built	Condition
Garage			

PROPERTY CHARACTERISTICS: LOT

Land Use	Single Family Residential	Lot Dimensions	
Block/Lot		Lot Square Feet	13,716
Latitude/Longitude	37.849283°/-120.184256°	Acreage	0.32

PROPERTY CHARACTERISTICS: UTILITIES/AREA

Gas Source		Road Type	
Electric Source		Topography	
Water Source		District Trend	
Sewer Source		Special School District 1	
Zoning Code	R-1/Mx/Air	Special School District 2	
Owner Type			

LEGAL DESCRIPTION

Subdivision		Plat Book/Page	
Block/Lot		Tax Area	54-012
Description	Pine Mountain Lake 4 L399		

FEMA FLOOD ZONES

Zone Code	Flood Risk	BFE	Description	FIRM Panel ID	FIRM Panel Eff. Date
X	Minimal		Area of minimal flood hazard, usually depicted on FIRMs as above the 500-year flood level.	060411-06109C1225C	04/16/2009

LISTING ARCHIVE

MLS #	Status	Status Change Date	List Date	List Price	Closing Date	Closing Price	Listing Agent	Listing Broker	Buyer Agent	Buyer Broker
-------	--------	--------------------	-----------	------------	--------------	---------------	---------------	----------------	-------------	--------------

20121679	Sold	04/08/2013	10/13/2012	\$219,000	04/08/2013	\$215,000	Lynn Bonander	Pine Mtn Lake Realty	Lynn Bonander	Pine Mtn Lake Realty
----------	------	------------	------------	-----------	------------	-----------	---------------	----------------------	---------------	----------------------

© 2023 Courthouse Retrieval System, Inc. All Rights Reserved.
Information Deemed Reliable But Not Guaranteed.