



PROPERTY PROFILE

Date: 07/21/2024
Property: CA
APN: 469-120-18-00-5
County: KERN

Subject Property Location

Property Address

City, State & Zip

County

Mailing Address

Census Tract

Thomas Bros Pg-Grid

, CA

KERN COUNTY

0065.00

Property Use

Parcel Number

Latitude

Longitude

Residential - Vacant Land

469-120-18-00-5

35.263113

-118.024052

Report Date: 07/21/2024

Order ID: R154737148

Legal Description Details Sec/Twn/Rng/Mer: SEC 05 TWN 31 RNG 37 Brief Description: SECTION 5, TOWNSHIP 31, RANGE 37, QUARTER

Current Ownership Information *Source of Ownership data: Recorder Information

Primary Owner Name(s)	MAO DEVELOPERS LLC,	Sale Price	\$1,000
		Sale Date	
		Recording Date	04/13/2023
Vesting		Recorder Doc #	223043880
		Book/Page	

Latest Full Sale Information

Details beyond coverage limitations



Financing Details at Time of Purchase

No financing details available

Property Characteristics

	Bedrooms		Year Built		Living Area (SF)	0
	Bathrooms/Partial		Garage/No. of Cars		Price (\$/SF)	
	Total Rooms		Stories/Floors		Lot Size (SF/AC)	108,900/2.5
	Construction Type		No. of Units		Fireplace	
	Exterior Walls		No. of Buildings		Pool	
	Roof Material/Type		Basement Type/Area		Heat Type	
	Foundation Type		Style		A/C	
	Property Type	Vacant Land	View		Elevator	
	Land Use	Residential - Vacant Land			Zoning	A

Assessment & Taxes

	Assessment Year	2023	Tax Year	2023	Tax Exemption	
	Total Assessed Value	\$2,077	Tax Amount	\$23.38	Tax Rate Area	94-034
	Land Value	\$2,077	Tax Account ID			
	Improvement Value		Tax Status	Delinquent		
	Improvement Ratio		Delinquent Tax Year	2023		
	Total Value			Market Improvement Value		
	Market Land Value			Market Value Year		

Lien History

Trans. ID	Recording Date	Lender	Amount	Purchase Money
No details available				

Loan Officer Insights

No details available

Subject Property Location

Property Address

City, State & Zip , CA

Report Date: 07/21/2024

Order ID: R154737149

County: KERN

Comparable Sales

No comparable sales found for subject property with selected filter criteria.

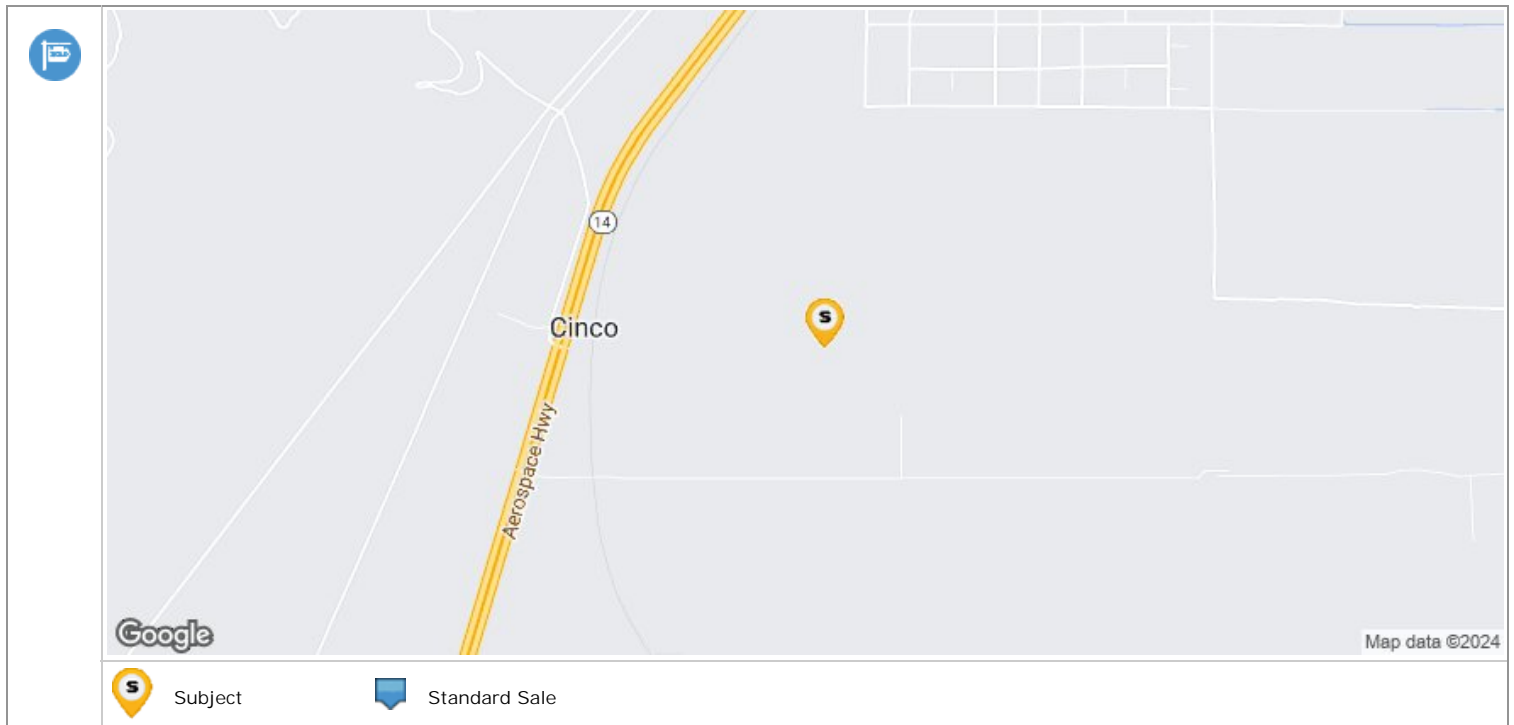

Subject Property Location

Property Address

City, State & Zip

, CA

County

KERN COUNTY

Mailing Address

Report Date: 07/21/2024

Order ID: R154737150

Property Use

Residential - Vacant Land

Parcel Number

469-120-18-00-5

Transaction Summary

Trans ID	Recording Date	Document Type	Document Description	Sale Price / Loan Amount	Document Number	Buyer / Borrower	Seller
1	04/13/2023	Deed	Public Action or Sold for Taxes	\$1,000	223043880	MAQ DEVELOPERS LLC	RICHARD, WEISSMAN
2	06/25/2003	Deed	Grant Deed		0203125448	WEISSMAN, RICHARD	ROMERO, JUAN

Transaction History Legend



Transfer



Mortgage



Mortgage Assignment



Foreclosure Activity



Mortgage Release

Transaction Details

Transfer

	Transaction ID	1	Recorder Doc Number	223043880	Partial Interest Transferred	
	Sale Date	04/11/2023	Document Type	Deed	Type of Transaction	Forced Sale
	Sale Price	\$1,000	Document Description	Public Action or Sold for Taxes	Multiple APNs on Deed	
	Recorder Book/Page		Recording Date	04/13/2023	Property Use	
	Buyer 1	MAQ DEVELOPERS LLC	Buyer 1 Entity	Limited Liability Company	Buyer Vesting	
	Buyer 2		Buyer 2 Entity		Buyer Mailing Address	
	Seller 1	RICHARD, WEISSMAN	Seller 1 Entity	Trustor or Debtor	Seller Mailing Address	
	Seller 2		Seller 2 Entity		Legal City/ Muni/ Township	
	Legal Recorder's Map Ref		Legal Subdivision		Legal Section/ Twn/ Rng/ Mer	SE4NW4NE4SE4 S05T31SR37E MDBM
	Legal Brief Description/ Unit/ Phase/ Tract				Title Company Name	NONE AVAILABLE

Transfer

	Transaction ID	2	Recorder Doc Number	0203125448	Partial Interest Transferred	
	Transfer Date	11/20/1997	Document Type	Deed	Type of Transaction	Non Arms-Length Transfer
	Sale Price		Document Description	Grant Deed	Multiple APNs on Deed	
	Recorder Book/Page		Recording Date	06/25/2003	Property Use	
	Buyer 1	WEISSMAN, RICHARD	Buyer 1 Entity	Individual	Buyer Vesting	
	Buyer 2		Buyer 2 Entity		Buyer Mailing Address	5525 OAKDALE AV STE 185, WOODLAND HILLS, CA 91364-2653
	Seller 1	ROMERO, JUAN	Seller 1 Entity	Single man	Seller Mailing Address	

	Seller 2		Seller 2 Entity		Legal City/ Muni/ Township	UNINCORPORATED
	Legal Recorder's Map Ref	OR6107 PG2261	Legal Subdivision		Legal Section/ Twn/ Rng/ Mer	SE4NW4NE4SE4 S05T31SR37E MDM
	Legal Brief Description/ Unit/ Phase/ Tract				Title Company Name	

Subject Property Location

Report Date: 07/21/2024
Order ID: R154737151

Property Address
City, State & Zip , CA
County KERN COUNTY
Mailing Address
Owner Name MAQ DEVELOPERS LLC,

Property Use Residential - Vacant Land
Parcel Number 469-120-18-00-5

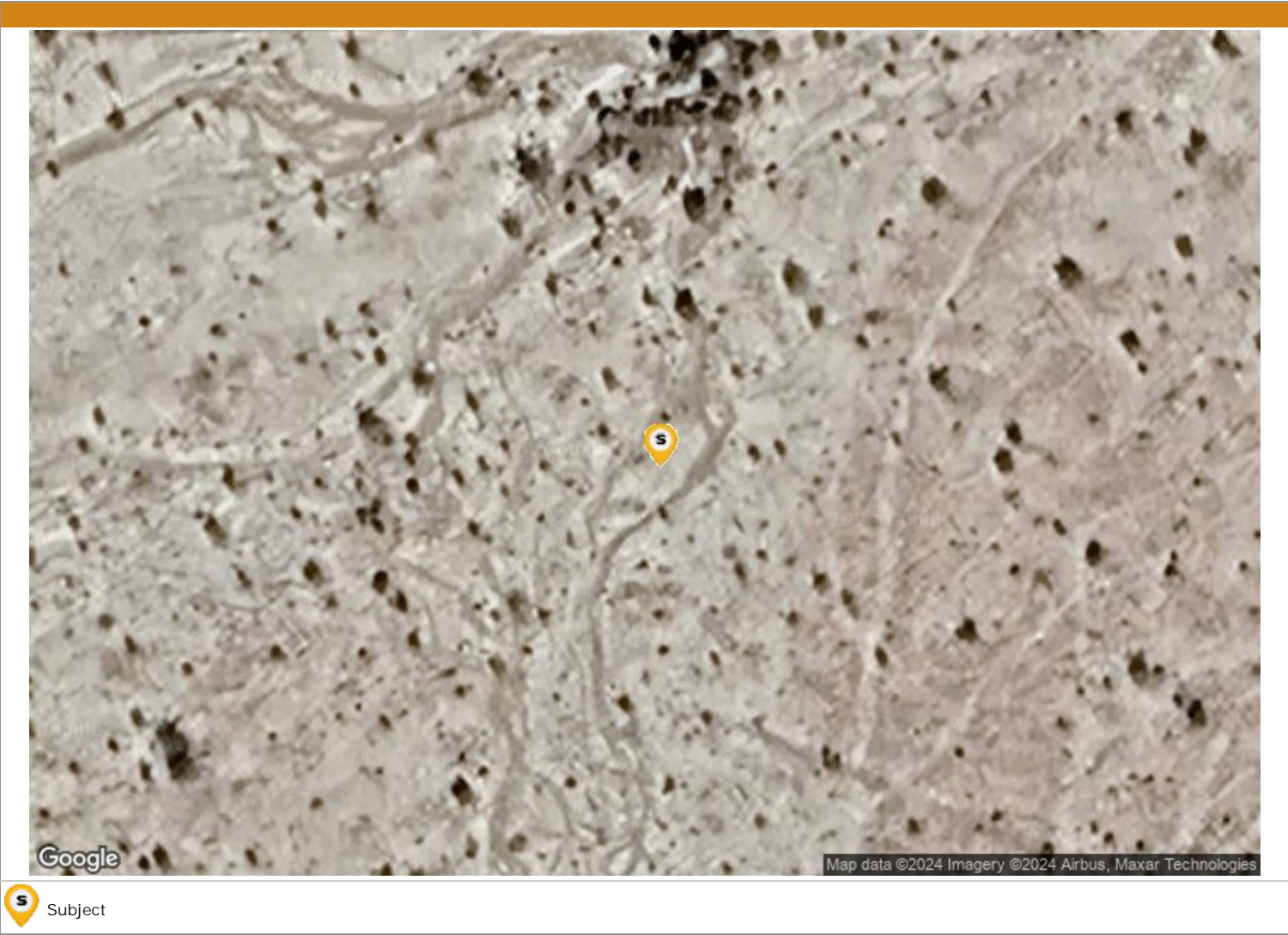

Subject Property Location

Property Address

City, State & Zip

County

Mailing Address

, CA

KERN COUNTY

Report Date: 07/21/2024

Order ID: R154737152

Property Use

Parcel Number

Residential - Vacant Land

469-120-18-00-5

Subject Property

Address	30401 AEROSPACE HWY, MOJAVE, CA 93501			APN	469-140-02-00-4
Owner	DE VAN VOORDE JR, CHARLES JOSEPH			Lot Size (SF/AC)	148,104/3.4
Bedrooms	2	Year Built	1989	Living Area (SF)	1,056
Bathrooms/Partial	2	Garage/No. of Cars	Attached Garage/2	Phones	

Nearby Neighbor #1

Address	29956 HIGHWAY 14, FREMONT VALLEY, CA 93501			APN	469-022-12-00-2
Owner	CITY OF LOS ANGELES D W P			Lot Size (SF/AC)	15,453,346/354.76
Bedrooms	0	Year Built		Living Area (SF)	0
Bathrooms/Partial		Garage/No. of Cars		Phones	

Nearby Neighbor #2

Address	29954 HIGHWAY 14, CANTIL, CA 93519			APN	469-022-11-00-9
Owner	CITY OF LOS ANGELES D W P			Lot Size (SF/AC)	11,438,856/262.6
Bedrooms	0	Year Built		Living Area (SF)	0
Bathrooms/Partial		Garage/No. of Cars		Phones	



Report Date: 07/21/2024

Order ID: R154737153

Parcel Number 469-120-18-00-5

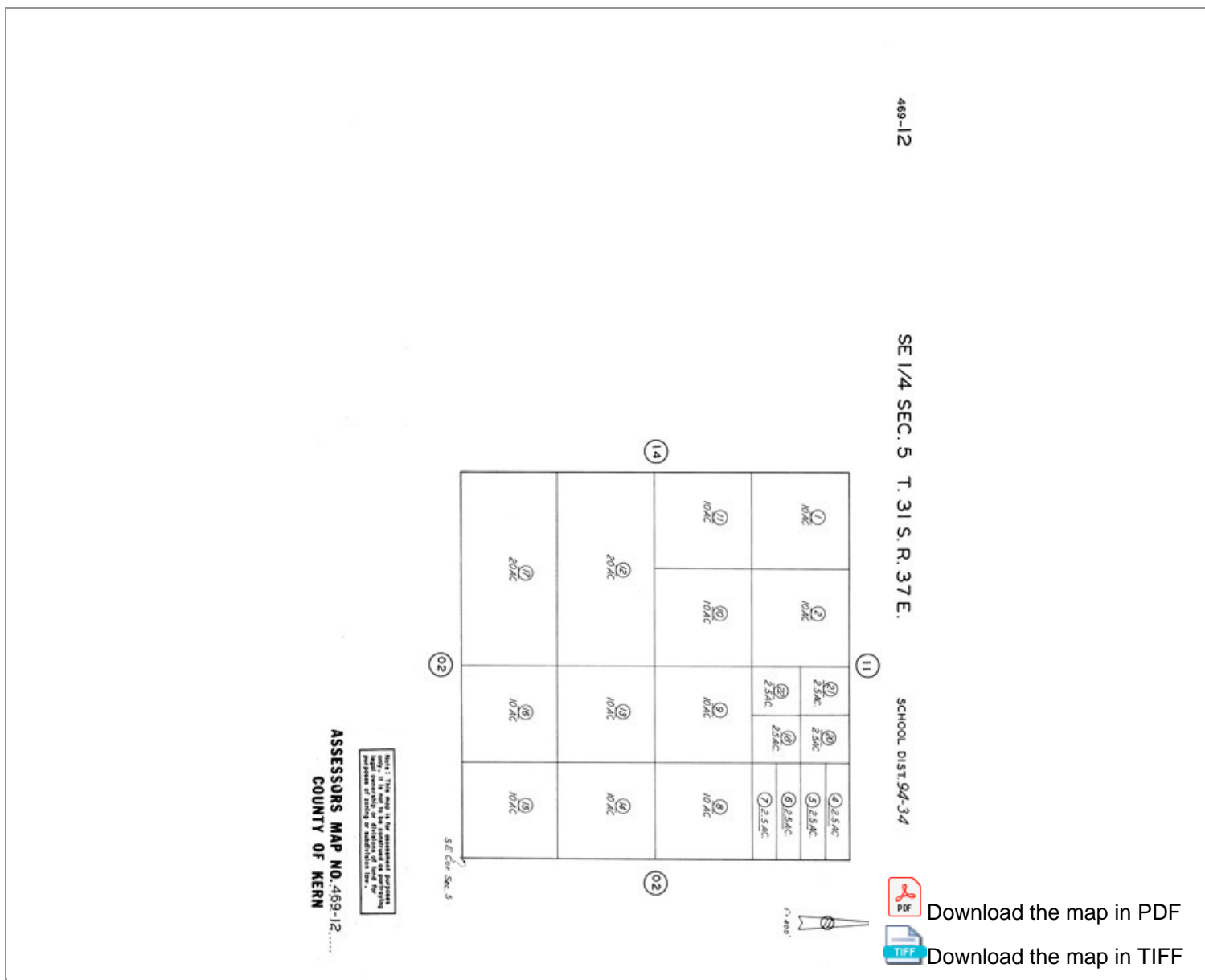

THIS REPORT IS INTENDED FOR USE BY YOU AS AN END USER SOLELY FOR YOUR INTERNAL BUSINESS PURPOSES. YOU SHALL NOT RESELL, RELICENSE OR REDISTRIBUTE THIS REPORT, IN WHOLE OR IN PART. THE USE OF THIS REPORT BY ANY PARTY OTHER THAN YOURSELF FOR ANY PURPOSE IS STRICTLY PROHIBITED. THIS REPORT IS PROVIDED AS-IS WITHOUT WARRANTY OF ANY KIND, EITHER EXPRESS OR IMPLIED, INCLUDING WITHOUT LIMITATION, ANY WARRANTIES OF MERCHANTABILITY, NON-INFRINGEMENT, OR FITNESS FOR A PARTICULAR PURPOSE. INTERCONTINENTAL EXCHANGE, INC. (ICE) SHALL HAVE NO LIABILITY IN CONTRACT, TORT, OR OTHERWISE ARISING OUT OF OR IN CONNECTION WITH THIS REPORT. ICE DOES NOT REPRESENT OR WARRANT THAT THE REPORT IS COMPLETE OR FREE FROM ERROR. YOU UNDERSTAND AND ACKNOWLEDGE THAT THE AVAILABILITY, COMPLETENESS AND FORMAT OF THE DATA ELEMENTS MAY VARY SUBSTANTIALLY FROM AREA-TO-AREA. THE INFORMATION CONTAINED IN THIS REPORT IS DERIVED FROM PUBLICLY AVAILABLE SOURCES FOR THE SUBJECT PROPERTY OR COMPARABLE PROPERTIES LISTED ABOVE AND HAS NOT BEEN INDEPENDENTLY VERIFIED BY ICE THROUGH ANY FORM OF INSPECTION OR REVIEW. THIS REPORT DOES NOT CONSTITUTE AN APPRAISAL OF ANY KIND AND SHOULD NOT BE USED IN LIEU OF AN INSPECTION OF A SUBJECT PROPERTY BY A LICENSED OR CERTIFIED APPRAISER. THIS REPORT CONTAINS NO REPRESENTATIONS, OPINIONS OR WARRANTIES REGARDING THE SUBJECT PROPERTY'S ACTUAL MARKETABILITY, CONDITION (STRUCTURAL OR OTHERWISE), ENVIRONMENTAL, HAZARD OR FLOOD ZONE STATUS, AND ANY REFERENCE TO ENVIRONMENTAL, HAZARD OR FLOOD ZONE STATUS IS FOR INFORMATIONAL PURPOSES ONLY AND SHALL BE INDEPENDENTLY VERIFIED BY THE END USER. THE INFORMATION CONTAINED HEREIN SHALL NOT BE UTILIZED: (A) TO REVIEW OR ESTABLISH A CONSUMER'S CREDIT AND/OR INSURANCE ELIGIBILITY OR FOR ANY OTHER PURPOSE THAT WOULD CAUSE THE REPORT TO CONSTITUTE A "CONSUMER REPORT" UNDER THE FAIR CREDIT REPORTING ACT, 15 U.S.C. § 1681 ET SEQ.; OR (B) IN CONNECTION WITH CERTIFICATION OR AUTHENTICATION OF REAL ESTATE OWNERSHIP AND/OR REAL ESTATE TRANSACTIONS. ADDITIONAL TERMS AND CONDITIONS SHALL APPLY PURSUANT TO THE APPLICABLE AGREEMENT.

