

**NOT FOR CONSTRUCTION**

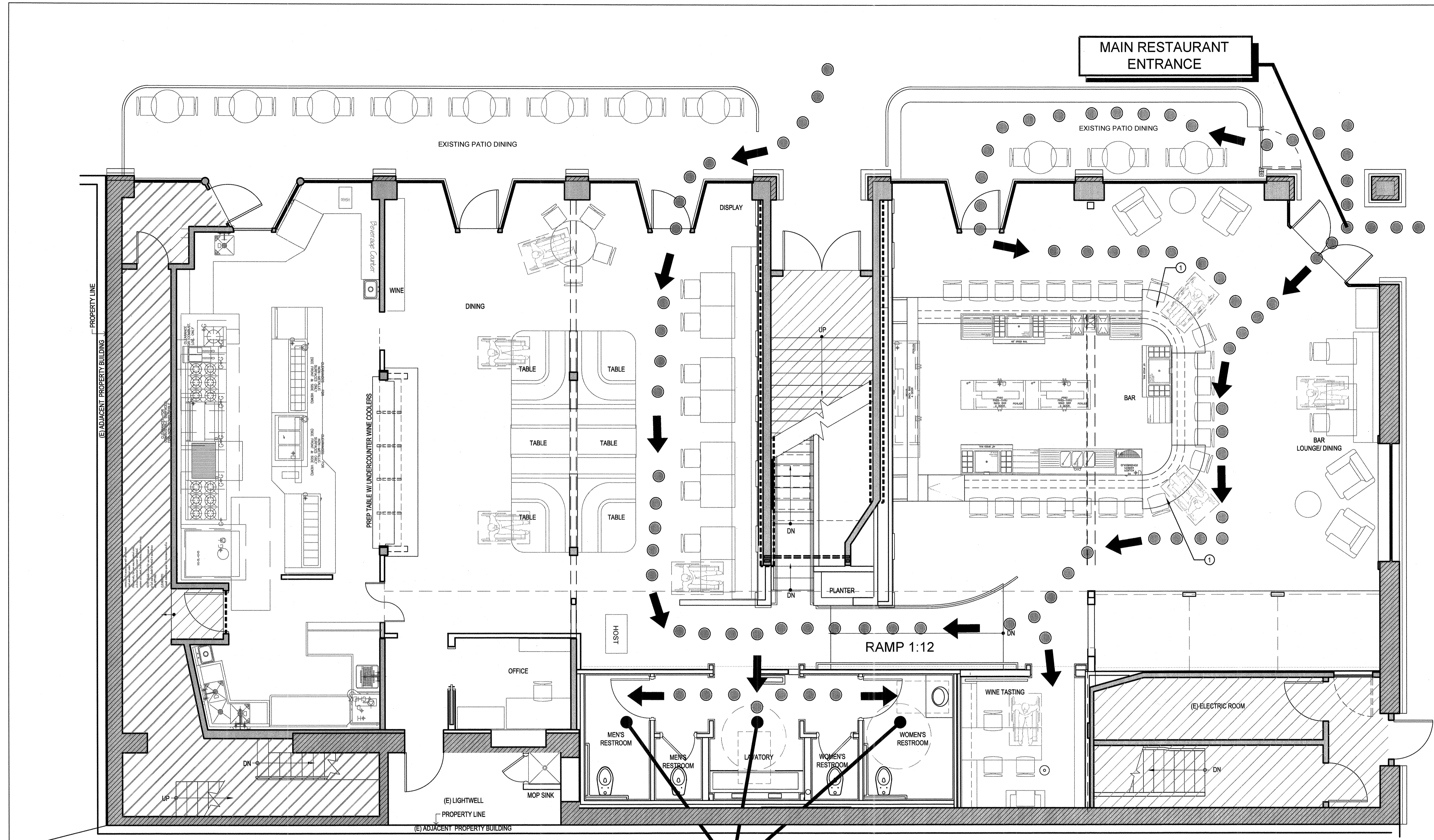

**ACCESSIBLE MEN'S AND WOMEN'S RESTROOMS AND COMMON LAVATORY**

**1 ACCESSIBILITY PLAN - GROUND FLOOR**  
 1/4" = 1'-0"

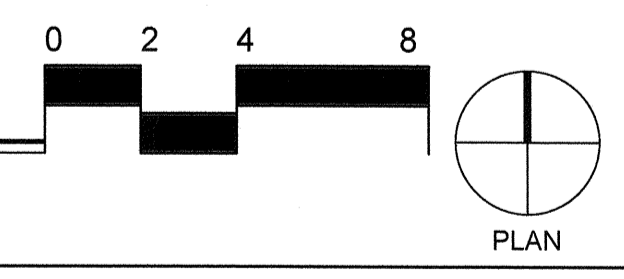

ACCESSIBILITY GENERAL NOTES
1. ALL PRIMARY PUBLIC ENTRANCES AND MAJOR FUNCTION AREA TO DISPLAY THE INTERNATIONAL SYMBOL OF ACCESSIBILITY
2. REQUIREMENTS FOR MINIMUM ACCESSIBLE SEATS:
i) $\geq 4$ BUT $\leq 26$ TOTAL SEATS = $\geq 1$ .
ii) $\geq 27$ BUT $\leq 50$ TOTAL SEATS = 2.
iii) $\geq 51$ BUT $\leq 300$ TOTAL SEATS = 4.
iv) $\geq 301$ BUT $\leq 500$ TOTAL SEATS = 6.
v) $> 500$ TOTAL SEATS = 1 ADDITIONAL SEAT FOR EACH ADDITIONAL 100 SEATS
3. 1% OF ALL FIXED SEATS SHALL BE AISLE SEATS WITH EITHER NO ARMRESTS, REMOVABLE OR FOLDING ARMRESTS ON THE AISLE SIDE.

ACCESSIBILITY KEY NOTES
① ACCESSIBLE PORTION OF BAR TOP @ 2'-10" A.F.F.

ACCESSIBLE SEATING COUNT
<b>*** ALL ACCESSIBLE TABLES &amp; COUNTER SHALL BE 28" - 34" TO FINISH FLOOR, AND ARE ACCESSED FROM AISLES <math>\geq 36"</math> IN CLEAR WIDTH.</b>
ACCESSIBLE SEATING SYMBOL
<b>ACCESSIBLE SEATING CALCULATION:</b> 5% OF TOTAL SEATS = ## ACCESSIBLE SEATS REQUIRED
<b>BAR AREA</b> BAR SEATING REQUIRED: 5% OF 25 = 2 REQ.; 2 PROVIDED LOUNGE SEATING REQUIRED: 5% OF 20 = 1 REQ.; 1 PROVIDED
<b>DINING AREA</b> DINING SEATING REQUIRED: 5% OF 45 = 3 REQ.; 4 PROVIDED

ACCESSIBILITY LEGEND
* REFER TO 'GENERAL NOTES' FOR ADDITIONAL INFORMATION