

BUILDING DEPARTMENT CITY OF COACHELLA

APPLICATION FOR PERMIT ELECTRIC

APPLICANT TO FILL IN BETWEEN HEAVY LINES				Building Address									
Building Address <u>LOT # 7 - 6 F OASIS PALM ST</u>				Date Issued <u>JULY 10 62</u>	Ready First Insp.	Group	Zone	Permit No. <u>7</u>					
Owner	Name <u>BARTON CONST. CORP</u>			<p>I hereby acknowledge that I have read this application and state that the information I have provided is correct and agree to comply with all City Ordinances and State Laws regulating electrical wiring.</p> <p>I hereby certify that I am properly registered and/or licensed as required by the City and State of California or that I am the legal owner of the residential property described hereon.</p> <p>Signature of Permittee <u>Donald L. Barton</u></p>									
	Address <u>81810 HWY 111</u>												
	City <u>INDIO CALIF</u> Tel. No.												
Electrician	Name												
	Address												
	City												
	Tel. No.												
NUMBER AND TYPE OF OUTLETS									INSPECTION RECORD				
Light Outlets	<u>12</u>	Number	Each						3 Ph				110 V.
Receptacles	<u>28</u>								1 Ph				
Switches	<u>12</u>			U. G.	Service: Conduit <u>12</u>	Wire <u>1</u>	<u>220</u> V.						
Total Outlets				O. H.	Switch	Fuse	<u>440</u> V.						
Electric Ranges			.50	<u>100 AMP.</u>									
Electric Heaters			.50										
Fixtures			.10										
Miscellaneous													
Number of Light Circuits													
Number of Receptacle Circuits													
MOTORS													
Number		H. P.	Horsepower		Fee Each								
New	Mvd.		Over	Inc.									
<u>1</u>			½ & Less		\$.25	<u>25</u>							
			½	2	.50								
			2	5	1.00								
			5	15	1.50								
			15	50	2.50								
			50	200	5.00								
			Over 200		10.00								
M. G. Set/Freq. Changer—H. P.													
Welders: AC-KVA													
Generators—KW													
Transformers—KVA													
Temp. Motors (75% of Orig.)													
Miscellaneous													
SIGNS													
No.		No. Lamps											
No.		No. Trans											
For Each Permit				<u>75</u>									
Wiring		\$1.00											
Fixtures		1.00											
Supplementary		.50											
Total Fee		Min. \$2.00	<u>6 20</u>										
				APPROVALS									
				Conduit	Date	Inspector							
				Wiring									
				Fixtures									
				Power									
				Utility Co. Notified									
				Final		<u>E. Hoy</u>							

BUILDING PERMIT No. 338

CITY OF COACHELLA, CALIFORNIA

Phone (714) 398-0161
765-402-823

OWNER **Kate Guerrero**
52-234 Oasis Palms, Coachella, California

CONTRACTOR **Owner**

JOB ADDRESS **52-234 Oasis Palms, Coachella**

LOT **7** BLK **---** TRACT **Palm View#2**

ARCHITECT **---**

ENGINEER **---**

PURPOSE OF PERMIT **Convert Garage to Master Bedroom and relocate Bathroom**

PLAN CK **No** SPECIAL INSP **No**

AIR COND **No** PLUMB **Yes** HA **No** ELECT **No**

LOT SIZE **---** BLDG SIZE **---**

VALUATION **\$485.00** FOOTAGE **---**

OCCUPANCY GROUP **I** USE ZONE **R-1**

TYPE CONSTR **V** FIRE ZONE **3**

SETBACK FRONT **---** REAR **---** SIDE **---**

CURBING **In** TYPE V CEMENT **Yes**

DATE REC **3/20/69** DATE APP **3/28/69**

APPROVED BY **Kate Guerrero**

SPECIAL NOTES: **---**

OWNER-BUILDER CONTRACTOR

I certify that in the performance of the work for which this permit is issued I shall not employ any person in violation of the workmen's compensation laws of California.
I hereby acknowledge that I have read this application and state that the above is correct and agree to comply with all City Ordinances and State laws applicable.

Signed **Kate Guerrero**

FEES: PLAN CK **---** BUILDING **3.00**

TOTAL OF ALL FEES **\$9.00 4.50**

NOTICE TO CONTRACTORS & SUB-CONTRACTORS

Final inspection of this job may be withheld until all contractors or sub-contractors having performed work under the above building permit have signed this card below as having valid Coachella business licenses.

GRADING **---**
SEWERS **---**
FRAMING **---**
ROOFING **---**
PLUMBING **---**
LATHING **---**
FLOORING **---**
TILES **---**
PAVING **---**
PAINTING **---**
OTHER **---**
CEMENT **---**
MASONRY **---**
ELECTRIC **---**
HEATING **---**

INSPECTION RECORD

EXCAVATION & SETBACKS:
Pour no concrete until signed here: INT. DATE

SETBACKS

FOOTINGS

FORMS OR STEEL

CONCRETE SLAB FLOOR:
Do not pour until signed

ELECTRIC Gnwrk

PLUMBING Gnwrk

SLAB HEIGHT

ELECT GROUND

CRUSHED ROCK

ROUGH INSPECTIONS:
Cover no work until signed

ELECTRIC

PLUMBING

T & P VALVE

GAS LINES

A/C & HEATING

ATTIC ACCESS

ATTIC VENTS

GARAGE VENTS

FRAMING

ROOF NAILING

OTHER:

SPECIAL INSPECTION:
Cover no work until signed

INSULATION

LATH & PLASTER:
Cover no work until signed

EXT LATH

INT LATH

SHOWER BACKING

CORNER BEAD

VENEER ANCHORS

FINISH INSPECTION:
Do not occupy until signed

ELECTRICAL

PLUMBING

GAS

A/C & HEATING

BUILDING

SEWAGE

CURBING

PARKING

DOOR CLOSER

T & P VALVE

OTHER:

AIR CONDITIONING PERMIT

AMOUNT	CLASSIFICATION	FEE
	PERMIT	
	APPLIANCES	
	AIR DUCTS	
	VENTS	
	VENT DUCTS	
	COMPRESSORS	
	COILS	
	TOWERS	
	COOLERS	
	PRE-COOLERS	
	SPECIAL INSP	
	OTHER:	
TOTAL FEE		

Special Notes: **---**

ELECTRICAL PERMIT

AMOUNT	CLASSIFICATION	FEE
	PERMIT	
	SERVICE	
	ONE CENT RATE	
	1/2 CENT RATE	
	FIXTURES	
	GENERATORS	
	APPLIANCES	
	MISC.	
	MOTORS	
	OUTLETS	
	SIGNS	
	CONSTR POLE	
	TRANSFORMERS	
	ANNUAL PERMIT	
	SPECIAL INSP.	
	OTHER:	
TOTAL FEE		

Special Notes: **---**

PLUMBING PERMIT

AMOUNT	CLASSIFICATION	FEE
1	PERMIT	2.00
3	FIXTURES	4.50
	SEWER	
	PRIVATE SEWER	
	WATER HEATER	
	GAS PIPING	
	WATER PIPING	
	DRAINAGE	
	SPRINKLERS	
	OTHER:	
TOTAL FEE		6.50

Special Notes: **---**

City of Coachella

1515 Sixth Street Coachella, California 92236 Phone: 398-6131

APPLICATION AND PERMIT

Rec'd 5/1/81
18454

No. 211

Owner Charles Madrid Address 52-234 Oasis Palms
 Job Address 52-234 Oasis Palms Tract _____ Lot _____
 Description of Work Reroof (prep required)

Date May 1 19 81
 FIRE ZONE 2 USE ZONE R-S
 OCCUPANCY R3 CONST. TYPE VN
 SQ. FT. _____ GARAGE _____
 COUNTY ASSESSOR'S NUMBER
765-402-023

SPECIAL CONDITIONS _____
 Contractor Owner State Lic. No. _____ City Lic. No. _____
 Address Same as above Phone 398-7952
 Workers Compensation Insurer _____ Address _____
 Compensation Insurance Exemption On File Construction Lender _____

PLUMBING AND/OR MECHANICAL			ELECTRICAL			BUILDING, SIGN AND/OR GRADING		
Contractor			Contractor			Est. Cost of Bldg. <u>\$1,150.00</u>		
QTY.	ITEM	AMOUNT	QTY.	ITEM	AMOUNT	DESCRIPTION	AMOUNT	
	Permit			Permit		Building Permit Fee *	25	00
	Plumbing Fixtures			Service Amp.		Sign Permit Fee		
	Sewer Connection			Fixtures		Grading Permit Fee		
	Water System			Outlets & Switches		Plan Check Fee		
	Gas System			New Building		OTHER		
				Temporary Power		* Double Fee Permit	25	00
				One Cent Rate		(work done without		
				1/2 Cent Rate		Building Permit)		
	Total Plumbing					New Construction Tax		
	Mechanical Permit					TOTAL FEES PAYABLE	50	00
	Heating Unit							
	Airconditioning Unit							
	Range Hood							
	Total Mechanical							
	TOTAL			TOTAL ELECT.				

CERTIFICATION APPEARING ON APPLICATIONS

I have carefully examined the above completed "Application and Permit," and do hereby certify that all information hereon is true and correct, and I further certify and agree, if a permit is issued to comply with all City, County and State laws governing building construction, whether specified herein or not; and I hereby agree to save, indemnify and keep harmless the City of Coachella against liabilities, judgments, costs and expenses which may in any way accrue against said City in consequence of the granting of this permit.

Charles Madrid
Applicant's Signature

OWNER CONTRACTOR AGENT

The issuance of this permit is based upon plans and specifications filed with the City of Coachella and shall not prevent the building official from thereafter requiring the correction of errors in said plans and specifications. Every permit issued by the Building Official under the provisions of this Code shall expire by limitation and become null and void, if the building or work authorized by such permit is not commenced within 180 days from the date of such permit; or if the building or work authorized by such permit is suspended or abandoned at any time after the work is commenced for a period of 180 days.

William J. Edwards
Building
John J. ...
Planning

DATE: 5-1-81

Work Description: Reroof (prep. required)

appears ok at this time

although prep not called

Temp. Pole	Gas. Pressure
Ro. Plumbing	Bond Beam
Footings	Sewer Conn.
Roof	Other <i>Prep Not Called</i>
Framing	Other <i>7/2/81 ART</i>
Ro. Elec. Pibg. A/C & Htg.	Final Gas Tag
Insulation	Final Elec. Tag

Owner Charles Madrid	Address 52-234 Oasis Palms	Contractor Owner
--------------------------------	--------------------------------------	----------------------------

NO.	OPERATION	DATE	INSPECTOR
BUILDING APPROVALS			
1	Set Back	10-31-91	<i>Diwan</i>
2	Figs & Frms	10-31-91	<i>Diwan</i>
2A	Slab Grade	10-31-91	<i>Diwan</i>
3	Steel		
4	Grout Blocks		
5	Bond Beams		
6	Roof Deck	11-15-91	<i>Diwan</i>
7	Framing	11-20-91	<i>Diwan</i>
8	Vents		
9	Garage Fire Wall		
10	Fireplace	PL <input type="checkbox"/>	
10A	Fireplace	TO <input type="checkbox"/>	
11	Exterior Lath	12-3-91	<i>Diwan</i>
12	Internal Lath		
12A	Drywall	12-3-91	<i>Diwan</i>
13	Finish Grade		
	INSULATION	Thick	"R" Value
7A	Walls (Batts)		
12B	Ceiling (Batts)		
12C	Ceiling (Blown)		
14	Final	12-24-91	<i>Diwan</i>
PLUMBING APPROVALS			
15	Ground Plumb	10-31-91	<i>Diwan</i>
16	Water piping		
17	Rough Plumb	11-20-91	<i>Diwan</i>
18	Vents		
19	Sewage Disposal		
20	Sewer		
21	Water Heater		
22	Water Softener		
23	Water Service		
24	Gas Test	12-16-91	<i>Diwan</i>
25	Final	12-24-91	<i>Diwan</i>
ELECTRICAL APPROVALS			
26	Power Pole		
27	Conduit		
28	Service Entrance		
29	Wiring	11-20-91	<i>Diwan</i>
29A	Grounding Wire		
29B	Bonding		
30	Fixtures	12-24-91	<i>Diwan</i>
31	Service		
32	Final	12-24-91	<i>Diwan</i>

No.	OPERATION	DATE	INSPECT
MECHANICAL APPROVALS			
33	Ventilation System		
34	Plenums & Ducts		
35	Furnace Compart.		
36	Inlets & Outlets		
37	Combustion Air		
38	Compressor		
39	Appl. Clearance		
40	Fire Damper		
41	Smoke Detection Device		
42	Commercial Hood		
43	Final		

ADDITIONAL INFORMATION

OP'N NO.

SEWAGE SYSTEM SIZE & LOCATION

Tank Pit L Line

REAR OF PROPERTY LINE

P/L

STREET NAME

APPLICATION AND PERMIT

City of Coachella

1515 Sixth Street

Coachella, California 92236

Phone: (619) 398-3002

2235

Owner Juan Garcia Address 52234 Oasis Palm, Coachella, CA 92236

Job Address Same Tract _____ Lot _____

Description of Work Drive way - side walk 720 sq.ft.

SPECIAL CONDITIONS 10 mill Visqueen with 2" sand

Contractor _____ State Lic.No. _____ City Lic. No. _____

Address _____ Phone (619) 398-8829

Workers Compensation Insurer _____ Address _____

Compensation Insurance Exemption On File

Construction Lender _____

Date 9/19 19 95

FIRE ZONE _____ USE ZONE R-S

OCCUPANCY M CONST. TYPE V-N

SQ. FT. _____ GARAGE _____

COUNTY ASSESSOR'S NUMBER

765-402-023

SITE	DATE	INSPECTOR
Toilet Facility		
Construction Trailer		
BUILDING		
Fndn: Locatn, Forms		
Set Back, Grade		
Reinforcement		
Uler Ground		
Slab: Grade, Form	<u>9/20/95</u>	<u>Bremer</u>
Bond Beam & Grout		
POUR NO CONCRETE UNTIL SIGNED ABOVE		
Roof Deck/Trusses		
Pre-Wrap		
Frame: Fire stops		
Shear Bracing, Bolts		
Hold Downs		
Insulation		
Lath: Int		
Dry Wall		
Lath: Ext.		

MECHANICAL	DATE	INSPECTOR
FAU, AC, Boiler, W/H		
Comb. Air & Venting		
Circ. Air ducts, Etc.		
Location Clearance, Access		
Duct Insulation		
Fireplace Installation		
PLUMBING		
Under Slab Work		
Rough Plumbing		
Rough Gas Piping		
Wet Test		
Bldg. Sewer		
Septic Sys, Drain Field		
Gas Line Test		
Grease Trap		
Gas Release		

ELECTRICAL	DATE	INSPECTOR
Temp. Power		
Under Slab Work		
Rough Conduit		
Rough Wiring		
Grounding		
Service		
Electric Release		
FINAL APPROVALS		
Plumbing Fixtures		
Mechanical		
Gas Piping		
Electrical, Smoke Det.		
Disabled Access		
ENERGY		
Insulation Cert. (Res)		
Installation Cert. (Res)		
Glazing		

OCCUP. APPROVALS
Planning Division
Date:
By:
Engineering Division
Date:
By:
Fire Prevention
Date:
By:
Water Division
Date:
By:
Sanitation Division
Date:
By:
Building Department
Date:
By:

NOTICE TO CONTRACTORS

Final Inspections and Certificate of Completion or Occupancy must be obtained before occupying or using a building.

TACK THIS CARD IN CONSPICUOUS PLACE ON BUILDING.
CALL FOR INSPECTION (24 HOURS IN ADVANCE)- Phone: 398-3002

LOCATE ALL BUILDINGS ON PLOT PLAN
REMEMBER TO INCLUDE ANY PATIO'S OR ADDITIONS

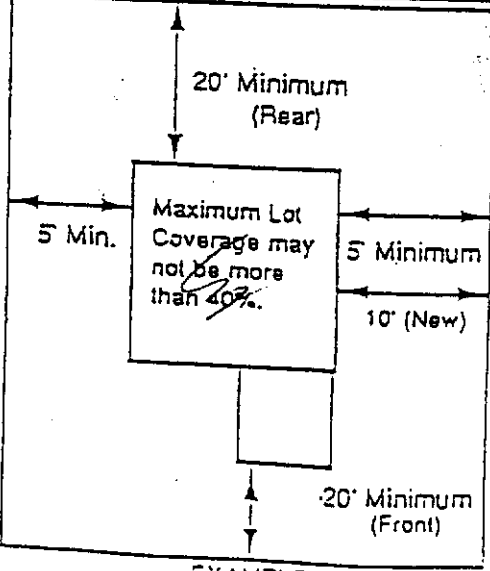
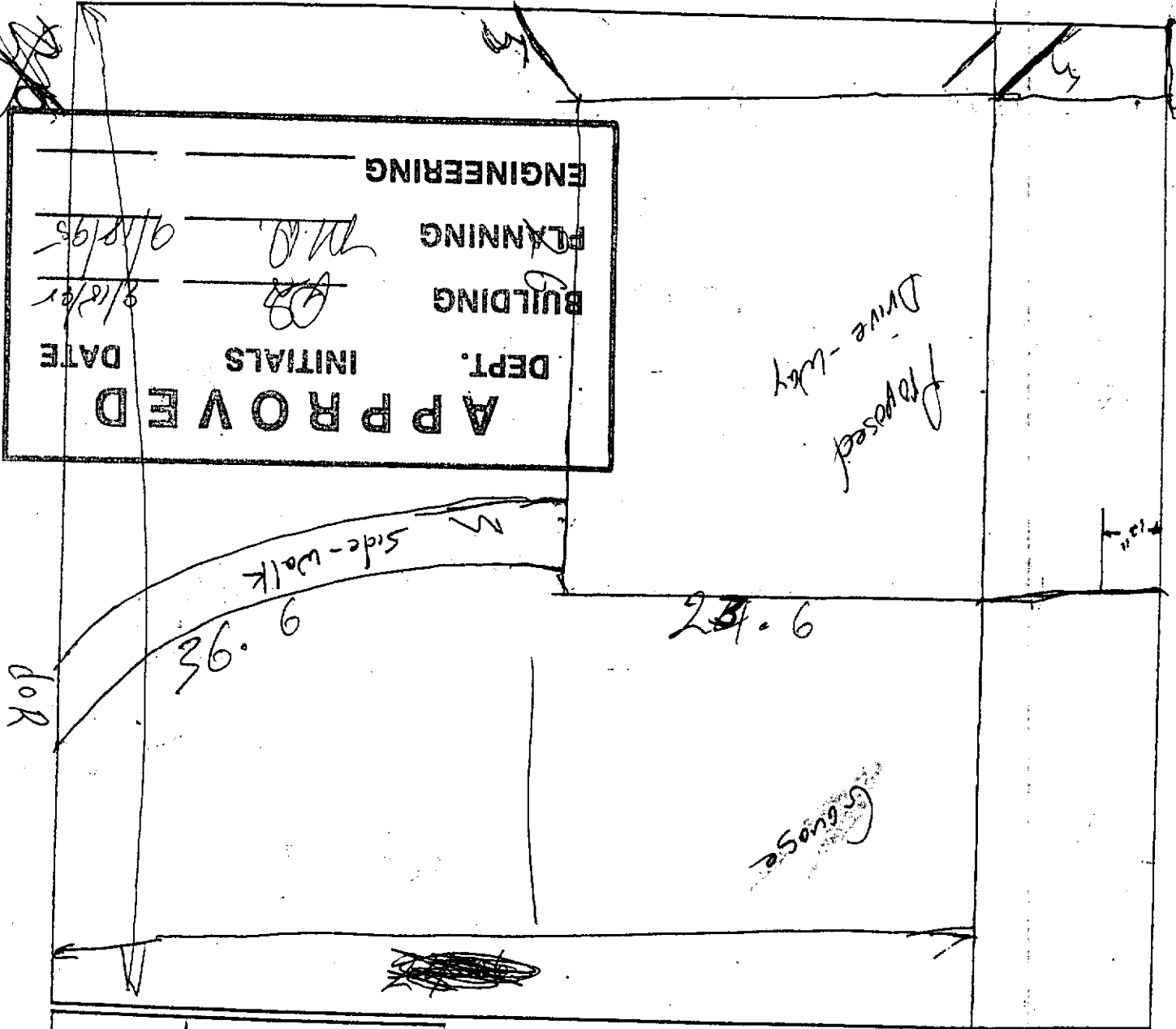

The illustrated minimum setbacks must be observed while designing proposed structures or additions. Patio areas may encroach into setbacks provided no fire dangers are present.

New structures must observe side yard setbacks of 10 feet on one side and 5 feet on the other side.

NAME: Juan Garcia

ADDRESS: 52-234 Oasis Palm

PHONE: 398-8829

PROJECT LOCATION: _____

APPLICATION AND PERMIT

City of Coachella

1515 Sixth Street

Coachella, California 92236

Phone: (760) 398-3002

7511

Owner Juan Garcia Address 52-234 Oasis Palm
 Job Address Same as above Tract _____ Lot _____
 Description of Work Re-Roof 1900 sq. ft.

Date July 7, 20 04
 FIRE ZONE _____ USE ZONE _____
 OCCUPANCY _____ CONST. TYPE _____
 SQ. FT. 1900 GARAGE _____
 COUNTY ASSESSOR'S NUMBER _____

SPECIAL CONDITIONS _____
 Contractor Owner/Builder State Lic.No. _____ City Lic. No. _____
 Address _____ Phone 398-8829
 Workers Compensation Insurer _____ Address _____
 Compensation Insurance Exemption On File Construction Lender _____

PLUMBING AND/OR MECHANICAL			ELECTRICAL			BUILDING, SIGN AND/OR GRADING		
Contractor			Contractor			Est. Cost of Bldg. <u>\$2,850.00</u>		
QTY.	ITEM	AMOUNT	QTY.	ITEM	AMOUNT	DESCRIPTION		AMOUNT
	Permit			Permit		Building Permit Fee		66 20
	Plumbing Fixtures			Service Amp.		Sign Permit Fee		
	Sewer Connection			Fixtures		Grading Permit Fee		
	Water System			Outlets & Switches		Plan Check Fee		
	Gas System			New Building		OTHER		
				Temporary Power				
				One Cent Rate		New Construction Tax		
				½ Cent Rate		TOTAL FEES PAYABLE		66 20
	Total Plumbing							
	Mechanical Permit							
	Heating Unit							
	Air Conditioning Unit							
	Range Hood							
	Total Mechanical							
	TOTAL			TOTAL ELECT.				

The issuance of this permit is based upon plans and specifications filed with the City of Coachella and shall not prevent the building official from thereafter requiring the correction of errors in said plans and specifications. Every permit issued by the Building Official under the provisions of this Code shall expire by limitation and become null and void, if the building or work authorized by such permit is not commenced within 180 days from the date of such permit, or if the building or work authorized by such permit is suspended or abandoned at any time after the work is commenced for a period of 180 days.

CERTIFICATION APPEARING ON APPLICATIONS
 I have carefully examined the above completed "Application and Permit" and do hereby certify that all information hereon is true and correct, and I further certify and agree, if a permit is issued to comply with all City, County and State laws governing building construction, whether specified herein or not; and I hereby agree to save, indemnify and keep harmless the City of Coachella against liabilities, judgments, costs and expenses which may in any way accrue against said City in consequence of the granting of this permit.

Juan Garcia
 Applicant's Signature

OWNER CONTRACTOR AGENT

Patricio Yoneda
 Building Planning

APPLICATION AND PERMIT

City of Coachella

1515 Sixth Street

Coachella, California 92236

Phone: (760) 398-3002

7511

Owner Juan Garcia Address 52-234 Oasis Palm

Job Address Same as above Tract _____ Lot _____

Description of Work Re-Roof 1900 sq. ft.

SPECIAL CONDITIONS _____

Contractor Owner/Builder State Lic.No. _____ City Lic. No. _____

Address _____ Phone 398-8829

Workers Compensation Insurer _____ Address _____

Compensation Insurance Exemption On File

Construction Lender _____

Date July 7, 20 04

FIRE ZONE _____ USE ZONE _____

OCCUPANCY _____ CONST. TYPE _____

SQ. FT. 1900 GARAGE _____

COUNTY ASSESSOR'S NUMBER _____

SITE	DATE	INSPECTOR
Toilet Facility		
Construction Trailer		
BUILDING		
Fndn: Locatn, Forms		
Set Back, Grade		
Reinforcement		
Uler Ground		
Slab: Grade, Rein.		
Bond Beam & Grout		
POUR NO CONCRETE UNTIL SIGNED ABOVE		
Roof Deck/ Trusses	<u>7/8/04</u>	<u>[Signature]</u>
Pre-Wrap		
Frame: Fire stops		
Shear Bracing, Bolts		
Hold Downs		
Insulation		
Lath: Int		
Dry Wall		
Lath: Ext.		

MECHANICAL	DATE	INSPECTOR
FAU, AC, Boiler, W/H		
Comb. Air & Venting		
Circ. Air ducts, Etc.		
Location Clearance, Access		
Duct Insulation		
Fireplace Installation		
PLUMBING		
Under Slab Work		
Rough Plumbing		
Rough Gas Piping		
Wet Test		
Bldg. Sewer		
Septic Sys, Drain Field		
Gas Line Test		
Grease Trap		
Gas Release		

ELECTRICAL	DATE	INSPECTOR
Temp. Power		
Under Slab Work		
Rough Conduit		
Rough Wiring		
Grounding		
Service		
Electric Release		
FINAL APPROVALS		
Plumbing Fixtures		
Mechanical		
Gas Piping		
Electrical, Smoke Det.		
Disabled Access		
ENERGY		
Insulation Cert. (Res)		
Installation Cert. (Res)		
Glazing		

OCCUP. APPROVALS
Flanning Division
Date:
By:
Engineering Division
Date:
By:
Fire Prevention
Date:
By:
Water Division
Date:
By:
Sanitation Division
Date:
By:
Building Department
Date:
By:

OK TO ROOF 7/8/04 [Signature]

NOTICE TO CONTRACTORS

Final Inspections and Certificate of Completion or Occupancy must be obtained before occupying or using a building.

TACK THIS CARD IN CONSPICUOUS PLACE ON BUILDING.
CALL FOR INSPECTION (24 HOURS IN ADVANCE)- Phone: 398-3002

**CITY OF COACHELLA
BUILDING PERMIT
COMMUNITY & DEVELOPMENT SERVICES**

Inspection Request Require 24 Hour Notice
(760) 398-3002



DATE: 12/09/2015
PERMIT NO: BL-2015-12-11448
USE ZONE: Residential Single Family
OCCUPANCY: CONSTR TYPE: SQ FT:

Project Address: 52234 OASIS PALM AVE
COACHELLA CA 92236
Project Valuation: \$ 4,050.00
PARCEL #: 765402023
LOT #: 7
Applicant's Name: SOUTHERN CALIFORNIA HOME IMPRO
Owner's Name: SYLVIA G MORIN
TRACT #: 0.00
Owner's Address: 52234 OASIS PALM AVE
COACHELLA CA 92236
Phone: (760) 391-2768
Fax:
Contractor's Name: SOUTHERN CALIFORNIA HOME IMPROVEMEN
Contractor's Address: 14601 ARMINTA ST
PANORAMA CITY CA 91402
Phone: (818) 281-7318
Fax:
Business Lic:
State Licence:
Contact Person:
Contact Phone:
Project Name:
Permit Type: ALTERATIONS AND ADDITIONS
Description of Work: REROOF & SHINGLES ON 2,700 SQ. FT. ON EXISTING DWELLING
Condition:

FEE(S):
BUILDING ALTERATIONS \$112.00 Senate Bill 1473 \$1.00

TOTAL FEES: \$ 113.00

CERTIFICATION APPEARING ON APPLICATIONS

I have carefully examined the above completed "Application and Permit" and do hereby certify that all information hereon is true and correct, and I further certify and agree, if a permit is issued, to comply with all City, County, and State laws governing building construction, whether specified herein or not, and I hereby agree to save, indemnify and keep harmless the City of Coachella against liabilities, judgments, costs and expenses which may in any way accrue against said City in consequence of the granted of this permit.

(Applicant Signature)

The issuance of this permit is based upon plans and specifications filed with the City of Coachella and shall not prevent the building official from thereafter requiring the correction of errors in said plans and specifications.

Every permit issued by the Building Official under the provisions of this Code shall expire by limitation and become null and void, if the building work authorized by such permit is not commenced within 180 days from the date of such permit, or if the building or work authorized by such permit is suspended or abandoned at any time after the work is

Building

Planning

**CITY OF COACHELLA
INSPECTION LIST
COMMUNITY & DEVELOPMENT SERVICES**



ISSUE DATE:
PERMIT NO: **BL-2015-12-11448**
USE ZONE: Residential Single Family
OCCUPANCY: CONSTR TYPE: SQ FT:

Inspection Request Require 24 Hour Notice
(760) 398-3002

Project Address: 52234 OASIS PALM AVE
COACHELLA CA 92238

Project Valuation: \$ 4,050.00
PARCEL #: 765402022
LOT #: 7
TRACT #: 0.00

Applicant's Name: SOUTHERN CALIFORNIA HOME IMPRO
Owner's Name: SYLVIA G MORIN
Owner's Address: 52234 OASIS PALM AVE
COACHELLA CA 92238

Phone: (760) 391-2768
Fax:

Contractor's Name: SOUTHERN CALIFORNIA HOME IMPROVEMEN
Contractor's Address: 14601 ARMINTA ST
PANORAMA CITY CA 91402

Phone: (818) 281-7318
Fax:
Business Lic:

Contact Person:

State Licence:
Contact Phone:

Project Name:
Permit Type: ALTERATIONS AND ADDITIONS
Description of Work: REROOF & SHINGLES ON 2,700 SQ. FT. ON EXISTING DWELLING
Condition:

Final Inspection 12/22/15

BUILDING	Date	INSPECTOR	MECHANICAL	Date	INSPECTOR	ELECTRICAL	Date	INSPECTOR
Toilet Facility			FAU, AC, W/H			Temp. Power		
Construction Trailer			Comb, Air & Venting			Under Slab Work		
BUILDING			Circ. Air ducts, Etc.			Rough Conduit		
Fdn: Locatn, Forms Set Back, Grade			Location Clearance Access			Rough Wiring Grounding		
Reinforcement			Duct Insulation			Service		
Ufer Ground			Fireplace Installation			Electric Release		
Slab: Grade, Rein.								
Bond Beam & Grout						FINAL APPROVALS		
POUR NO CONCRETE UNTIL SIGNED ABOVE			PLUMBING			Plumbing Fixtures		
Roof Deck/Trusses			Under Slab Work			Mechanical		
Pre-Wrap			Rough Plumbing			Gas Piping		
Frame: Fire stops Shear Bracing, Bolts			Rough Gas Piping			Electrical, Smoke Det.		
Hold Downs			Wet Test			Disabled Access		
Insulation			Bldg. Sewer			ENERGY		
Lath: Int			Septic Sys, Drain Field			Insulation Cert. (Res.)		
Dry Wall			Gas Line Test			Installation Cert. (Res.)		
Lath: Ext			Grease Trap			Glazing		
			Gas Release					

OCCUP. APPROVALS					
Planning Division	Engineering Division	Fire Prevention	Water Division	Sanitation Division	Building Division
Date:	Date:	Date:	Date:	Date:	Date: 12-22-15
By:	By:	By:	By:	By:	By: [Signature]

NOTICE TO ALL CONTRACTORS
Final Inspections and Certificate of Completion or Occupancy must be obtained before occupying or using a building.
TACK THIS CARD IN CONSPICUOUS PLACE ON BUILDING
CALL FOR INSPECTION (24 HOURS IN ADVANCE) Phone: 398-3002